

KSYRIUM SL 08 (clincher version)





USE: use only on a road bike. Any other use (such as on a tandem, cyclo-cross bike, or of f-road use...) is strictly inadvisable, is the sole responsibility of the user and voids the Mavic warranty.

WHEEL WEIGHTS WITHOUT QUICK RELEASE SKEWER:

Front: 645 g
Rear M10: 855 g
Rear ED10: 840 g

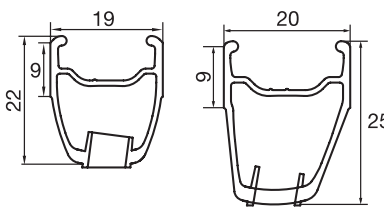
WHEEL REFERENCES:

	WORLD	USA
Front:	996 118 10	995 717 10
Rear M10:	996 119 11	995 718 11
Rear ED10:	996 120 12	995 719 12
Pair M10:	995 720 14	995 720 14
Pair ED10:	996 121 14	995 721 14

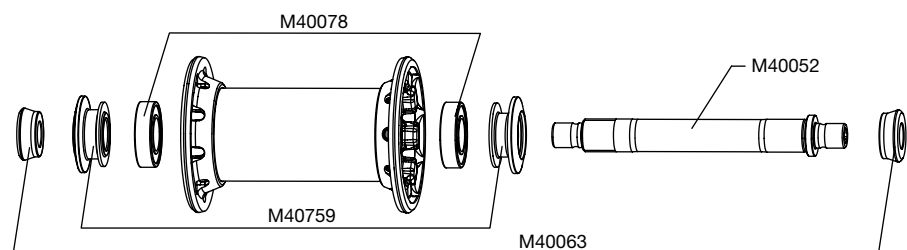
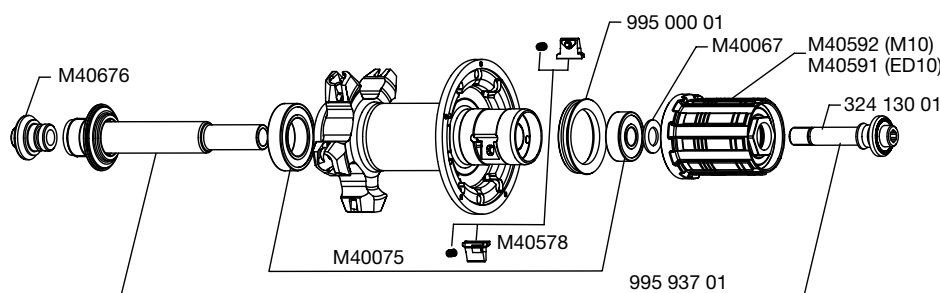
RIMS		SALES REFERENCES: Clincher Front: 996 054 10 Rear: 996 054 13	
		VALVE HOLE Ø  Ø: 6.5 mm Length: ≥ 32 mm	RECOMMENDED TIRE WIDTH AND PRESSURE  Dimensions: ETRTO 622 x 15C Recommended tire width: 19 to 28 mm  Recommended tire pressure: See page 21
		When replacing the rear rim: 1. With the valve hole near you, the 2 raised indicator bumps must be to the right of the valve hole; 2. The spoke in the 1st hole to the right of the valve hole should be inserted on the drive side into a marked hub hole.	
HUBS		MAINTENANCE: Clean with a dry cloth or soap and water . Do not use pressurized water.	
			
			
WHEEL BUILDING		REFERENCES AND LENGTHS: Front: 324 178 01, length 284.5 mm (per 11, integrated nipples) Drive side: 324 179 01, length 275 mm (per 10, integrated nipples) Non-drive side: 324 180 01, length 298.5 mm (per 10, integrated nipples)	
FEATURES: Black Zicral bladed straight pull spokes with integrated M7 nipples (self-locking)		LACING PATTERN: Front: radial Rear: Isopulse	TENSION: Front: 110 to 130 kg Rear drive side: 120 to 140 kg
ACCESSORIES		WHEELS SUPPLIED WITH:	MAINTENANCE
<ul style="list-style-type: none">• BR 601 front quick release skewer M40149• BR 601 rear quick release skewer M40150• Computer magnet M40540 (with front wheel)• Free play adjustment wrench M40123 (with rear wheel)• Spoke wrench M40494 (with rear wheel)• ED10 12D locking ring M40640 (with rear wheel ED10)• User guide and warranty card			<div>Replacing the front axle and bearings</div> <div>Replacing the rear axle</div> <div>Maintaining and replacing the free wheel mechanism</div> <div>Replacing the rear bearings</div> <div>Replacing a spoke</div> <div>Replacing the front rim</div> <div>Replacing the rear rim</div> <div>See 2005 TM page 20</div> <div>See 2007 TM page 20</div> <div>See 2003 TM page 21</div> <div>See 2003 TM page 22</div> <div>See 2003 TM page 23</div> <div>See 2003 TM page 27</div> <div>See 2006 TM page 17</div>
To quickly consult this information in a practical manner , refer to www.tech-mavic.com			

KSYRIUM SL 08 (tubular version)

USE: use only on a road bike. Any other use (such as on a tandem, cyclo-cross bike, or of f-road use...) is strictly inadvisable, is the sole responsibility of the user and voids the Mavic warranty.

WHEEL WEIGHTS WITHOUT QUICK RELEASE SKEWER:

Front: 645 g
Rear M10: 830 g
Rear ED10: 815 g

WHEEL REFERENCES:

	WORLD	USA
Front:	995 727 10	995 727 10
Rear M10:	995 728 11	995 728 11
Rear ED10:	996 122 12	995 729 12

RIMS

SALES REFERENCES:

Tubular Front: 996 055 10
Rear: 996 055 13

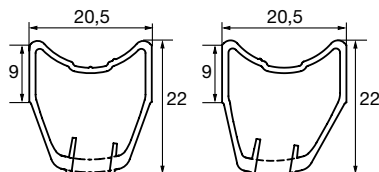

VALVE HOLE Ø



Ø: 6.5 mm
Length: ≥ 32 mm

RECOMMENDED TIRE WIDTH AND PRESSURE



Dimensions: Ø 700
622 tubular only
Recommended tubular width: 19 to 23 mm



Recommended tire pressure: See page 21

When replacing the rear rim:

1. With the valve hole near you, the 2 raised indicator bumps must be to the right of the valve hole;
2. The spoke in the 1st hole to the right of the valve hole should be inserted on the drive side into a marked hub hole.

HUBS

MAINTENANCE: Clean with a dry cloth or soap and water.
Do not use pressurized water.

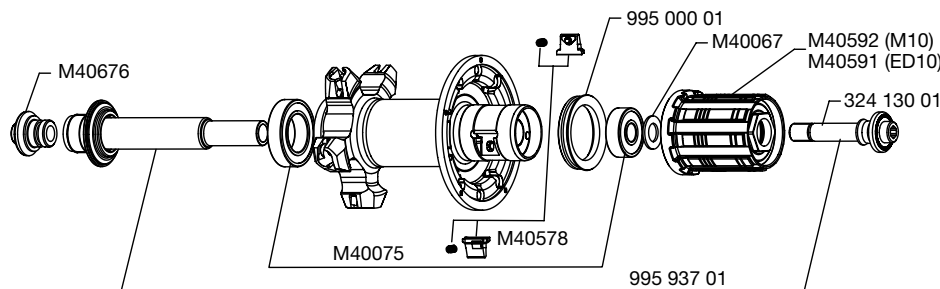
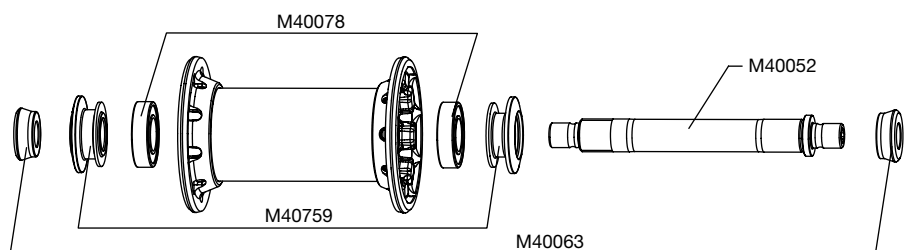

WHEEL BUILDING

REFERENCES AND LENGTHS:

Front: 324 178 01, length 284.5 mm (per 11, integrated nipples)
Drive side: 996 152 01, length 278 mm (per 10, integrated nipples)
Non-drive side: 996 153 01, length 301.5 mm (per 10, integrated nipples)

FEATURES:

Black Zicral bladed straight pull spokes with integrated M7 nipples (self-locking)

LACING PATTERN:

Front: radial
Rear: Isopulse

TENSION:

Front: 110 to 130 kg
Rear drive side: 120 to 140 kg

ACCESSORIES

WHEELS SUPPLIED WITH:

- BR 601 front quick release skewer M40149
- BR 601 rear quick release skewer M40150
- Computer magnet M40540 (with front wheel)
- Free play adjustment wrench M40123 (with rear wheel)
- Spoke wrench M40494 (with rear wheel)
- ED10 12D locking ring M40640 (with rear wheel ED10)
- User guide and warranty card

MAINTENANCE

Replacing the front axle and bearings
Replacing the rear axle
Maintaining and replacing the free wheel mechanism
Replacing the rear bearings
Replacing a spoke
Replacing the front rim
Replacing the rear rim

See 2005 TM page 20
See 2007 TM page 20
See 2003 TM page 21
See 2003 TM page 22
See 2003 TM page 23
See 2003 TM page 27
See 2006 TM page 17

To quickly consult this information in a practical manner, refer to www.tech-mavic.com

KSYRIUM SL *Black*



USE: for road bike use only. Any other use (such as on a tandem, cyclo-cross bike, or off-road use...) is highly inadvisable, is the sole responsibility of the user and voids the Mavic warranty.
Recommended maximum weight of the cyclist and equipment: 100 kg

WHEELS WEIGHTS WITHOUT QUICK-RELEASE SKEWER

Front	645 g
Rear M10	855 g
Rear ED11	840 g

WHEEL REFERENCES

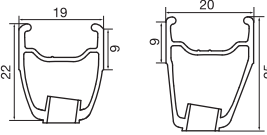
Front	107 970 10
Rear M10	107 971 11
Rear ED11	107 972 12
Pair M10	107 973 14
Pair ED11	107 974 14

RIMS	SALES REFERENCES	
	Black: Front: 108 426 10 Rear: 108 426 13	
	 Ø VALVE HOLE Ø: 6.5 mm Length: ≥ 32 mm	 RECOMMENDED TIRE WIDTH Dimensions: Ø 700: ETRTO 622 x 15C Recommended tire width: 19 to 32 mm
	When replacing the rear rim: 1. With the valve hole near you, the two raised indicator bumps must be to the right of the valve hole. 2. The spoke in the first hole to the right of the valve hole should be introduced into the drive side in a marked hole on the hub.	

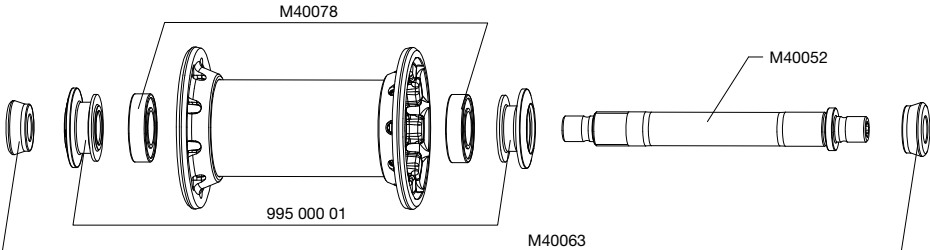
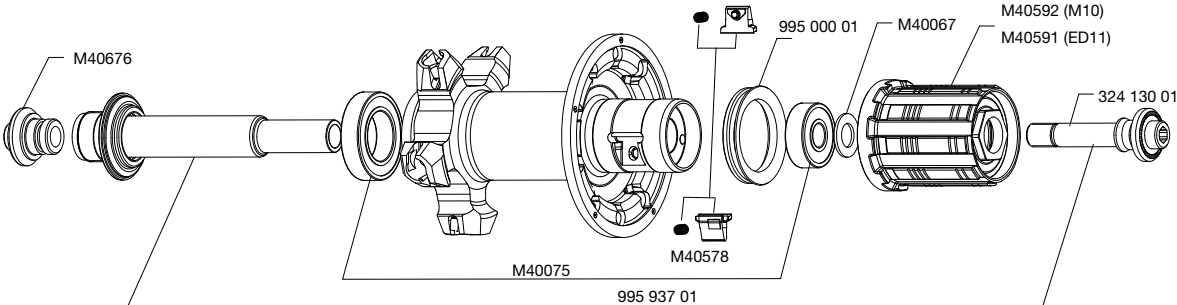
HUBS	MAINTENANCE: Clean with a dry cloth or soapy water if necessary. Do not use a high-pressure washer.
	
	

WHEEL BUILDING	REFERENCES AND LENGTHS:	
	Black	Front: 324 178 01, length 284.5 mm (per 12, integrated nipples) Rear drive side: 324 179 01, length 275 mm (per 11, integrated nipples) Rear non-drive side: 324 180 01, length 298.5 mm (per 10, integrated nipples)
FEATURES: Black bladed, straight pull Zicral spokes with M7 integrated, self-locking nipples		
LACING PATTERN: Front: radial Rear: Isopulse		 TENSION: Front: 110 to 130 kg Rear drive side: 120 to 140 kg

ACCESSORIES	WHEELS SUPPLIED WITH:	MAINTENANCE	
<ul style="list-style-type: none"> • BR 601 front quick-release M40149 • BR 601 rear quick-release M40150 • Computer magnet M40540 (with front wheel) • Free play adjustment wrench M40123 (with rear wheel) • Spoke wrench M40494 (with rear wheel) • ED11 12D locking ring (with rear wheel ED11) 108 317 01 • User guide and warranty card 		Replacing the front axle and bearings Replacing the rear axle Maintaining and replacing the free wheel mechanism Replacing the rear bearings Replacing a spoke Replacing the front rim Replacing the rear rim	See 2005 TM, page 20 See 2007 TM, page 20 See 2003 TM, page 21 See 2003 TM, page 22 See 2003 TM, page 23 See 2003 TM, page 27 See 2006 TM, page 17
		Refer to the website for quick and convenient access to information: www.tech-mavic.com	