

# COMÈTE *Track 11*

**Use: rear wheel only**, intended exclusively for track bikes. Any other use (such as on a road bike, tandem, cyclo-cross bike, or off-road use...) is highly inadvisable, is the sole responsibility of the user and voids the Mavic warranty.  
Recommended maximum weight of the cyclist and equipment: 100 kg.

## WHEEL WEIGHT WITHOUT FIXING NUT

Rear 980 g

## WHEEL REFERENCES

Rear 111 549 13



### Ø VALVE HOLE

Ø: 6.5 mm  
Length: ≥ 32 mm



### RECOMMENDED TUBULAR WIDTH

Dimensions: Ø 700  
633 mm  
Tubular only / Recommended width: 18 to 21 mm

## HUB

**MAINTENANCE:** Clean with a dry cloth or soapy water if necessary. Solvent products are not to be used in any case.  
Do not use a high-pressure washer.

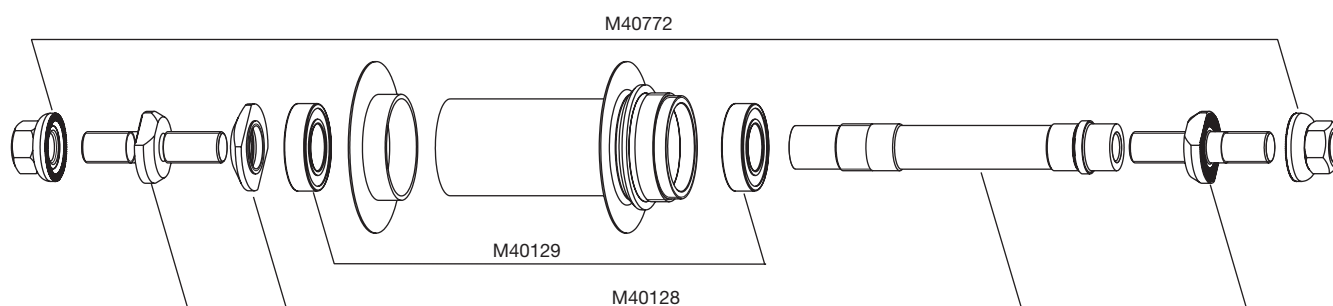

## ACCESSORIES

### WHEELS SUPPLIED WITH:

- Fixing nuts M40772
- Wheel bag
- Wheel user guide

## MAINTENANCE

### REPLACING THE FRONT AXLE AND BEARINGS

1. Using two 15 mm open-end wrenches, unscrew the axle end screws. Only one of the 2 needs to be unscrewed from the axle in order for it to be extracted from the hub;
2. To remove the 2nd axle end screw, insert a 5 mm Allen wrench inside the axle on the side opposite the remaining axle end screw, hold the axle end screw with a 15 mm open end wrench and unscrew the assembly;
3. Remove the bearings, then install the new ones;
4. Repeat procedure 1 above in reverse order.