

AXLE KIT M40130 FOR THE IO® WHEEL.

TOOLS NEEDED :

- Two 5 mm Allen wrenches.
- One 14 mm flat wrench.
- Lock ring pliers.
- 1 vice with 1 set of clamps.



Disassemble the attachment nut M40124 beforehand with the 5 mm Allen wrenches.

Replacing the axle :

- 1** Remove the clips on the adjustment nut side with the pliers.
- 2** Loosen the adjustment nut with the 14 mm flat wrench holding the axle in a vice by using the clamps.
- 3** Remove the axle, clean the body if necessary, and replace it (installing in reverse order 1).
- 4** Adjust the bearing free play (install the wheel to the frame (tightening torque: 5 Nm) and put the bike down on the floor) : the adjuster nut contacts the external face of the bearings when using the 14 mm flat wrench. Repeat this operation if the adjustment doesn't seem to be optimum..

For adjusting the free play (see point 4 above).



1

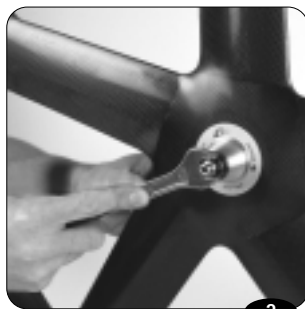

2

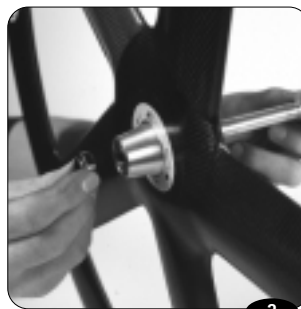

3



4

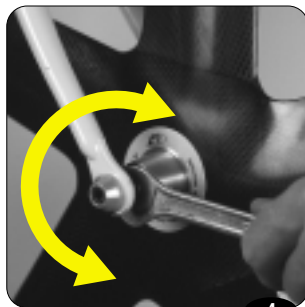

4

FRONT BEARING KIT

BEARING KIT M40318 FOR THE CROSSLINK®, CROSSLINK® DISC, COSMIC® ELITE, CLASSICS ELITE AND XIXIX® WHEELS.

BEARING KIT M40076 FOR THE CROSSMAX®, CROSSMAX® DISC AND HELIUM WHEELS.

BEARING KIT M40076 FOR THE MX 601 HUB.

BEARING KIT M40179 FOR THE DEEMAX® WHEEL.

BEARING KIT M40078 FOR THE COSMIC® EQUIPE, COSMIC® CARBONE, CLASSICS PRO WHEELS.

BEARING KIT M40131 FOR THE iO® WHEEL.

BEARING KIT M40078 FOR THE MR 601 HUB.

TOOLS NEEDED :

- 2 - 5 mm Allen wrenches
- 1- 4 mm Allen wrench
- 1- 14 mm flat wrench
- 2 - 16 mm or 5/8" flat wrenches for the Xixix® wheel only.
- 1 - 17 mm flat wrench for the Deemax® wheel only (Ø 9 mm)
- 1 - 26 mm flat wrench for the Deemax® wheel only (Ø 20 mm)
- 1 hub wrench M40123
- 1 pair of pliers
- 1 vice with 1 set of clamps

Bearing pullers :

- M40373 for the Crosslink®, Crosslink® Disc, Cosmic® Elite, Classics Elite, iO® and Xixix® wheels
- M40119 for the Crossmax®, Crossmax® Disc and Helium wheels
- M40218 for the Deemax® wheel.
- M40120 for the Cosmic® Equipe, Cosmic® Carbone, Classics Pro wheels.

 **For the Crosslink® Disc, Crossmax® Disc and Deemax® wheels, disassemble the brake disk adapter beforehand (see pages 68 & 69) with the 4 mm Allen wrench.**

- 1** Disassemble the axle kit (see pages 37 - 39)
- 2** Remove the hub body bearings with the bearing pullers.
- 3** After cleaning the body, install the new bearings with the appropriate bearing tool.
For the Deemax® wheel only : install one bearing at a time, not both at the same time, as with the other wheels.
- 4** Install the axle kit (see pages 37 - 39).
- 5** Adjust the bearing free play (install the wheel to the frame and put the bike down on the floor) : The adjuster nut contacts the external face of the bearing when using hub wrench M40123. Repeat this operation if the adjustment doesn't seem to be optimum.

 **For the Crosslink® Disc, Crossmax® Disc and Deemax® wheels, we advise you to replace the lip seal M40163 after installing the brake disk adapter (see pages 68 & 69).**

