

MAVIC **CROSSMAX SL R 29**

ASTM CATEGORY 3 : CROSS COUNTRY

For a longer longevity of the wheel, Mavic recommends that the total weight supported by the wheels doesn't exceed 150kg, bike included

Maximum tyre pressure: 4.1bar/59PSI with a 28mm tyre - 2.45bar/36PSI with a 64mm tyre

Non-Boost : 12x135 rear axle adapters (V2510901)

Recommended tire sizes: 28 to 64 mm (1.1" to 2.5")

Boost : Torque Caps for Center Lock hub (V2374401)

REFERENCES WHEELS

F92991 CROSSMAX SL R INT 29 BST

F93001 CROSSMAX SL R CL 29 BST

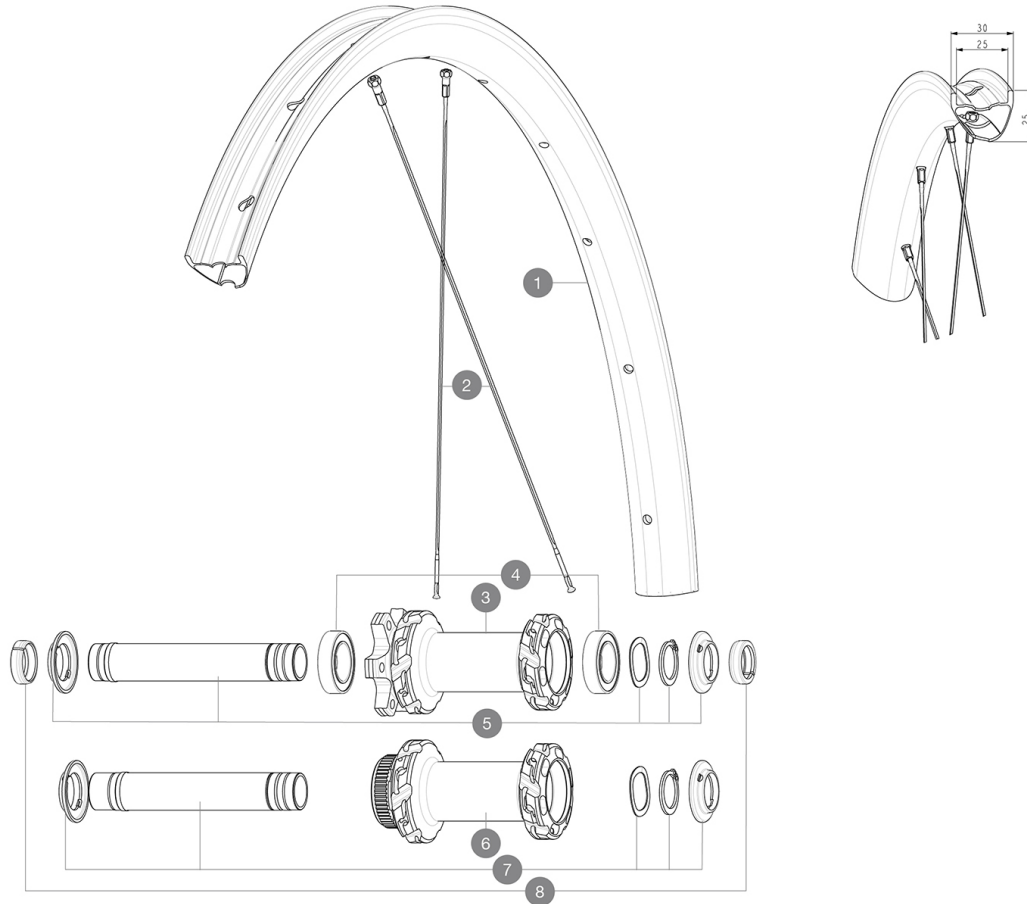
**RIMS**

&NBSP;:

| | | |
|----------|-----------|--|
| 1 | V00004731 | Kit Front/Rear rim Crossmax SLR 29" 22 |
| | V2700101 | UST Tape 28mm for 25 to 27mm wide rims |

SPOKES

| | | |
|----------|-----------|---|
| 2 | V00065231 | Kit 12Fr/Rr MTBcarb29 ss spk293 |
| 2 | V2389101 | Kit 12Fr/Rr XmaxSL Ultimate spk293+np&w while stock lasts |

HUB SHELLS

| | | |
|----------|----------|--|
| 3 | N/A | HUB BODY |
| 4 | V2500901 | KIT BEARINGS 18x30x7 + WAVED WASHER + CLIP |
| 5 | V2372401 | KIT 110mm AXLE QRM AUTO MTB > 2019 |
| 6 | N/A | HUB BODY |
| 7 | V2375601 | Kit 110mm axle QRM auto MTB from 2019 DCL |

OPTIONS

| | |
|----------|---|
| V2374401 | TORQUE CAPS 15*31 Adapter MTB QRM Auto > 2019 Frt HUB |
|----------|---|

ADAPTERS

| | | |
|----------|----------|--------------------------------------|
| 8 | V2372501 | 15mm MTB Axle Cap QRM Auto From 2019 |
| | 99694101 | ADAPTER Ft 15 to 9mm QR |

MAVIC CROSSMAX SL R 29

DELIVERED WITH

| | |
|---|--|
| User guide | |
| UST valve and accessories (129 838 01) | |
| UST valve and accessories (129 838 01) | |
| Pre-installed tubeless rim tape | |
| Pre-installed tubeless rim tape | |
| Multifunction adjustment wrench (delivered with rear wheel) (325 423 01) | |
| User guide | |
| Pre-installed tubeless rim tape | |
| UST valve and accessories (129 838 01) | |
| 2 replacement spokes with each wheel | |
| 12 to 9mm rear adapter for quick release (V2510801) | |
| 2 replacement spokes with each wheel | |
| 2 replacement spokes with each wheel | |

COMPATIBILITY

| | |
|---|--|
| Front axle: 15x110 Boost thru axle | |
| Front axle: 15x110 Boost thru axle | |
| Freewheel body: convertible SHIMANO HG MTB steel (kit V3790101 sold separately) | |
| Freewheel body: convertible SHIMANO HG MTB steel (kit V3790101 sold separately) | |
| Boost 20 to 15mm front adapter ([12982801]) | |
| Front axle: for fixing nuts only (included), M9x1 thread | |
| Rear axle adapters: 12x148 convertible to 9x141 (kit V2510801 sold separately) | |
| Rear axle adapters: 12x148 convertible to 9x141 (kit V2510801 sold separately) | |
| Rear axle: 12x148 Boost thru axle | |
| Front axle: 15x110 Boost thru axle | |
| Boost Axles : 15X110 ; 12X148 | |
| Front axle: for fixing nuts only (included), M9x1 thread | |
| Instant Drive 360 freewheel technology The new Instant Drive 360 freewheel system is super light and fast to engage with only 9Å°. A large contactless rubber seal provides low friction, while a wide array of end caps makes it super versatile. | |

Specifications

RIMS

- **Material** : 100% carbon fiber with UDÅ² external layer
 - **Material** : 100% carbon fiber with UDÅ² external layer
 - **Material** : 100% carbon fiber with UDÅ² external layer
 - **Height** : 25 mm
 - **Height** : 25 mm
 - **Drilling** : traditional
 - **Internal width** : 25 mm
 - **Internal width** : 25 mm
 - **Drilling** : traditional
 - **Drilling** : traditional
 - **Internal width** : 25 mm
- Disc brake specific profile
Disc brake specific profile
E-Bike specific rim profile

WHEEL HUB

- Infinity hubs
- **Body** : aluminum
 - **Body** : aluminum
- Instant Drive 360 freewheel technology
QRM Auto bearing preload technology
Hub available with 6-bolt or Center LockÅ® brake rotors
- **Body design** : INFINITY
 - **Body design** : INFINITY
 - **Disc standard** : 6 Bolts or Center LockÅ®
 - **Disc standard** : 6 Bolts or Center LockÅ®
 - **Axle material** : aluminum
 - **Axle material** : aluminum
 - **Rear body** : aluminum
 - **Rear body** : aluminum
 - **Axles** : Front 15X110 (Boost) or 15x100 ; Rear 12X148 (Boost) or 12x142

WHEEL WEIGHTS

720