

## REFERENCES WHEELS

R17901 Crossroc XL 26Rr WTS

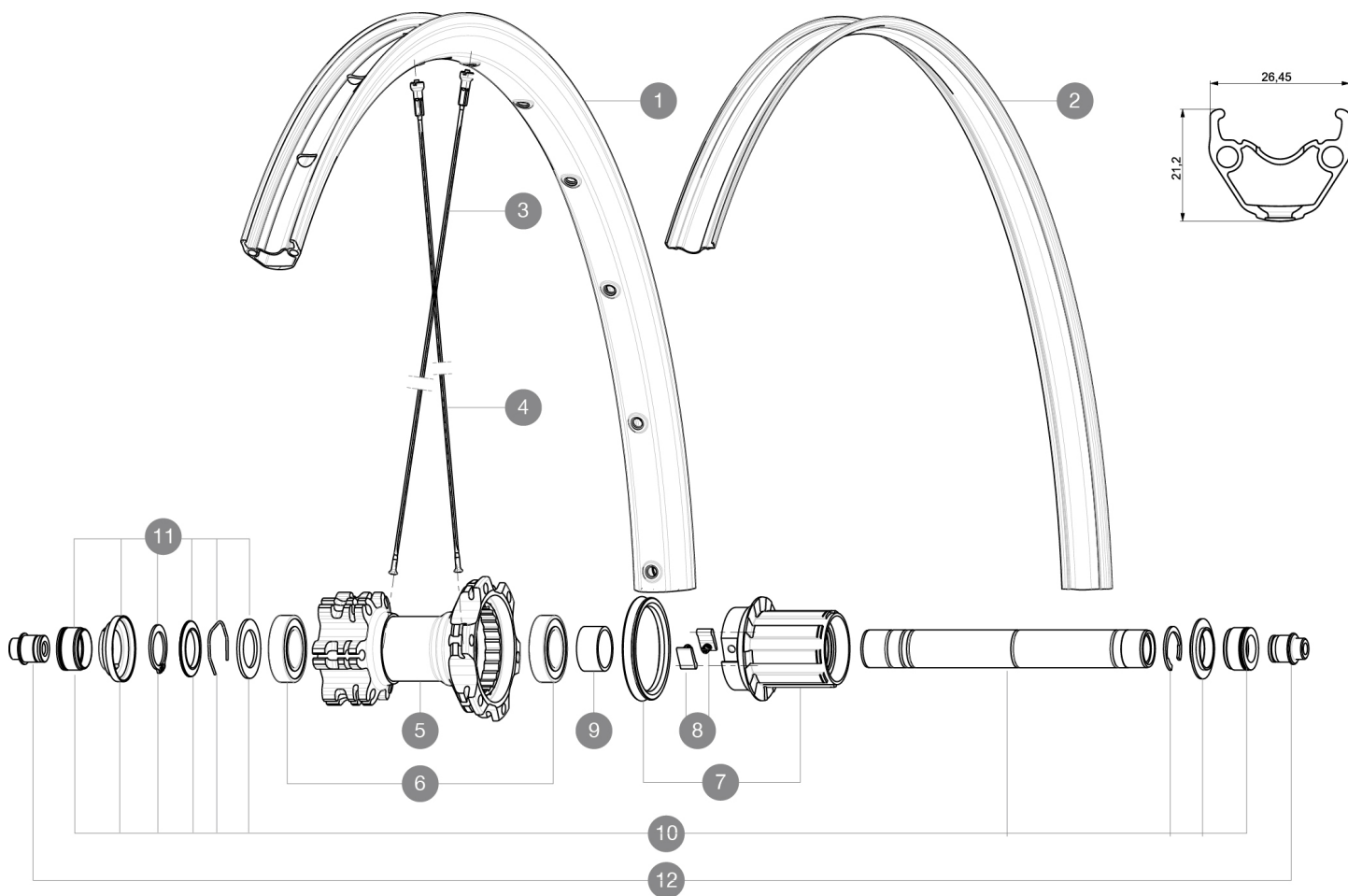

### RIMS



VALVE HOLE  $\bar{A}$  (MM): 6.5 :

1	V2311315	KIT FRONT/REAR RIM CROSSROC XL 26"
2	V2170101	UST RIM STRIP 26x21c

### SPOKES

3	36675201	KIT 12 FT/NDS CROSSROC 26" SPOKE 263mm
4	36675301	KIT 12 DS CROSSROC/CROSSRIDE UST 26" SPK 261mm

### HUB SHELLS

5	N/A	HUB BODY
6	M40076	HUB BEARINGS 17x30x7 6903 x 2
7	35126301	TS-2 FREEWHEEL BODY + SEAL 2013 (NO PAWLS) - while stock las
8	99610601	PAWLS KIT FOR ITS-4 (OR TS-2)
9	35124501	SET OF 3 REAR AXLE/FREEWHEEL BODY SPACERS MTB L1
10	V2371201	KIT REAR QRM AXLE 135-142 / BOOST 148mm
11	V2370401	KIT REAR AUTO ADJUSTING PLAY 12mm AXLE

### ADAPTERS

12	30873101	2 REAR REDUCERS 12/9,5mm 2012 ITS4 HUB
	32965001	ADAPTER Rr 12x142mm Elite/CRide MTB (Rd)

# MAVIC Crossroc XL WTS

## DELIVERED WITH

Tubeless rim tape	
UST valve and accessories	
Valve reducer	
User guide	

## Specifications

### RIMS

- **Material** : S6000 Aluminum
- **Joint** : pinned
- **Drilling** : traditional with H2 reinforcement  
Disc brake specific profile
- **Valve hole diameter** : 8,5 mm with pop off reducer
- **Tyre** : UST Tubeless and tubetype
- **Internal width** : 21 mm
- **ETRTO size 26"** : 559x21C
- **ETRTO size 27.5"** : 584x21C
- **ETRTO size 29"** : 622x21C
- **Recommended tyre sizes** : 2.0 to 2.5

### SPOKES

- **Material** : steel
- **Shape** : straight pull, bladed, double butted
- **Nipples** : brass, ABS
- **Count** : 24 front and rear
- **Lacing** : front and rear crossed 2

### WHEEL HUB

- **Front and rear bodies** : aluminum
- **Axle material** : aluminum  
Sealed cartridge bearings
- **Freewheel** : TS-2 alloy  
Shimano 11 speeds compatible  
XD Compatible (XX1-X01) with optionnal kit

### WHEEL WEIGHTS

- Wheel weight
- Weight Rear 26": 985
- Weight Rear 27.5": 1015
- Weight Rear 29": 1060