

ASTM CATEGORY 2 : road and offroad with jumps less than 15cm  
Recommended weight limit : 120kg  
Recommended tyre sizes: 25 to 52 mm  
Max. Pressure: 25mm 7.7 bars - 110 PSI

## REFERENCES WHEELS

R66704	KsyriumElite16Rr White	R66702	KsyriumElite16Rr Red
R66701	KsyriumElite16Rr Black	R66703	KsyriumElite16Rr Blue

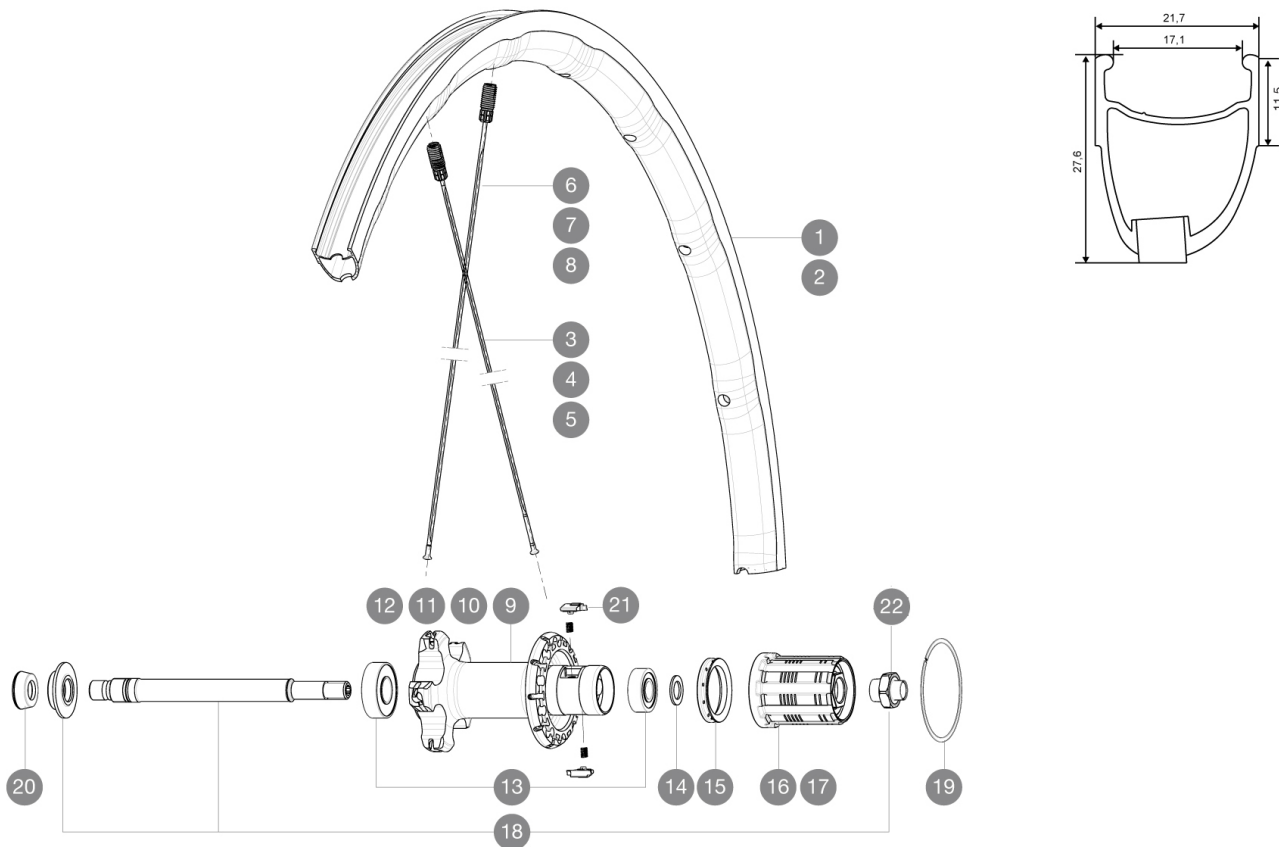

## RIMS



VALVE HOLE  $\bar{A}$  (MM): 6,5 :

1	V2402313	KIT REAR RIM KSYRIUM ELITE 2016
2	V2404813	KIT REAR RIM KSYRIUM ELITE WHITE 2016

## SPOKES

3	V2271701	KIT 10 DS KSYRIUM ELITE BLK SPK 273,5mm
4	V2272301	KIT 10 DS KSYRIUM ELITE RED SPOKE 273,5mm
5	V2272001	KIT 10 DS KSYRIUM ELITE BLUE SPOKE 273,5mm
6	V2271801	KIT 10 NDS KSYRIUM ELITE BLACK SPOKE 299,5mm
7	V2272401	KIT 10 NDS KSYRIUM ELITE RED SPOKE 299,5mm
8	V2272101	KIT 10 NDS KSYRIUM ELITE BLUE SPOKE 299,5mm

## HUB SHELLS

9	N/A	HUB BODY
10	N/A	HUB BODY
11	N/A	HUB BODY
12	N/A	HUB BODY
13	V2540101	REAR HUB B9+6001 BEARINGS 2015
14	30872801	SET OF 3 INTERNAL SILVER SPACERS 9mm FTS-L
15	99500001	FTSL/FTSX FREEHUB BODY SEAL
16	30871101	FTS-L ROAD FREEWHEEL BODY HG11 8/9 compatible
17	30871201	FTS-L ROAD FREEWHEEL BODY ED11 8/9 compatible
18	V2250501	KIT REAR AXLE KSYRIUM SLE/SLS/ELITE/PRO EXALITH/ALLROAD ELIT
19	V2252201	KIT 2 REAR HUB RETENTION RINGS 48mm
21	M40578	FTSL PAWLS KIT (ROAD WHEELS)
22	V2373101	KIT NUT FOR ROAD ALLOY THROUGH AXLE 9mm

## ADAPTERS

20	35117301	FT/RR FORK REST R-SYS/CC ULTIMATE > 2013/KSY PRO CARB T
----	----------	---

# MAVIC Ksyrium Elite

## DELIVERED WITH

BR301 quick releases	
BR301 quick releases	
Multifonction adjustment wrench	
User guide	
Multifonction adjustment wrench	
User guide	

## COMPATIBILITY

Freewheel: Shimano/Sram, convertible to Campagnolo with optional driver body	
Front axle: Quick Release only	
Rear axle: Quick Release only	

## Specifications

### RIMS

- **Material** : Mxxtal
- **Height** : front 24mm, rear 26 asymmetrical
- **Joint** : SUP
- **Drilling** : Fore
- **Brake track** : UB Control
- **Weight reduction** : ISM 4D
- **Valve hole diameter** : 6.5 mm
- **Tyre** : clincher
- **Material** : Mxxtal
- **Height** : front 24mm, rear 26 asymmetrical
- **ETRTO size** : 622x17C
- **Recommended tyre sizes** : 25 to 52 mm
- **Joint** : SUP
- **Drilling** : Fore
- **Brake track** : UB Control
- **Weight reduction** : ISM 4D
- **Valve hole diameter** : 6.5 mm
- **Tyre** : clincher
- **Internal width** : 17 mm
- **ETRTO size** : 622x17C

### SPOKES

- **Material** : steel
- **Shape** : straight pull, bladed, front double butted
- **Nipples** : Fore integrated aluminum
- **Count** : front 18, rear 20
- **Material** : steel
- **Lacing** : front radial, rear Isopulse
- **Shape** : straight pull, bladed, front double butted
- **Nipples** : Fore integrated aluminum
- **Count** : front 18, rear 20
- **Lacing** : front radial, rear Isopulse

### WHEEL HUB

- **Front and rear bodies** : aluminum
- **Axle material** : aluminum
- Adjustable sealed cartridge bearings
- **Freewheel** : FTS-L steel
- **Front and rear bodies** : aluminum
- **Axle material** : aluminum
- Adjustable sealed cartridge bearings
- **Freewheel** : FTS-L steel

### VERSIONS

- **Color** : Black or Black/Red or Black/Blue or Black/White

### WHEEL WEIGHTS

Wheel weight 870