

ASTM CATEGORY 2 : road and offroad with jumps less than 15cm
 Recommended weight limit : 120kg
 Recommended tire sizes: 28 to 42 mm
 Max. Pressure: 28mm 7.7 bars - 110 PSI / 30mm 5.8 bars - 85 PSI

REFERENCES WHEELS

| | | | |
|--------|----------------------|--------|----------------------|
| F56201 | KsyElAIRD6BFT 12x100 | F59901 | KsyElAIRDCLFt 12x100 |
|--------|----------------------|--------|----------------------|

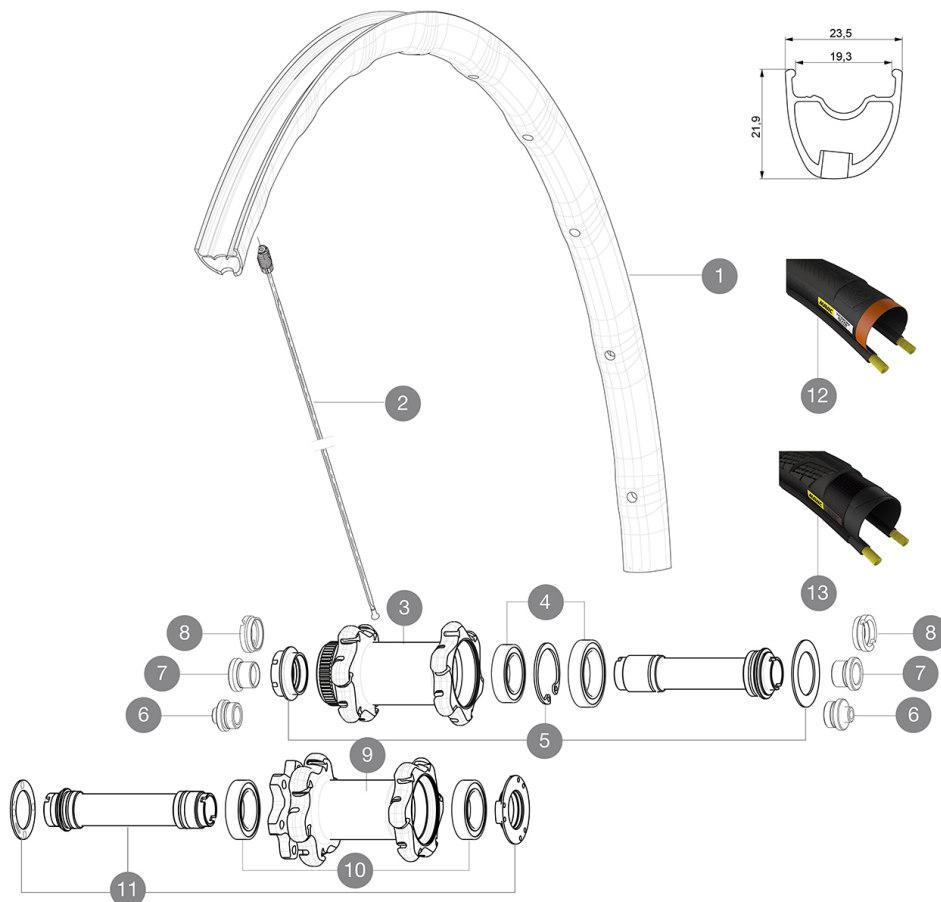

RIMS



&NBSP;:

| | | |
|---|----------|-------------------------------------|
| 1 | V2405710 | KIT FRONT RIM KSYRIUM ELITE ALLROAD |
|---|----------|-------------------------------------|

SPOKES

| | | |
|---|----------|--|
| 2 | V2273201 | KIT 12 FRT/NON DRIVE SIDE BUTTED SPOKE 297mm |
|---|----------|--|

HUB SHELLS

| | | |
|----|----------|--|
| 3 | N/A | HUB BODY |
| 3 | N/A | HUB BODY |
| 4 | 99688601 | BEARING KIT 9/15 DCL HUB 20x32x7 6804 + 25x37x7 6805 |
| 5 | V2252401 | KIT MY16 FRONT AXLE ROAD DISC 9/12/15 CL |
| 10 | 99688501 | BEARING KIT 9/12/15 D6T HUB 20x32x7 6804 |
| 11 | V2252301 | KIT MY16 FRONT AXLE ROAD DISC 9/12/15 INT |

TYRES





| | | |
|----|----------|-------------------------|
| 12 | 37805628 | Yksion EliteGuard White |
| 13 | 38012230 | Yksion Elite Allroad |

ADAPTERS

| | | |
|---|----------|----------------------|
| 6 | B4104301 | ADAPTER Ft 9mm QRM+ |
| 7 | B4104201 | ADAPTER Ft 12mm QRM+ |
| 8 | B4104401 | ADAPTER Ft 15mm QRM+ |

MAVIC Ksyrium Elite Allroad Disc UST

DELIVERED WITH

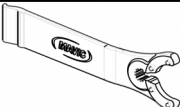
| | |
|---|---|
| 1 bottle of Mavic Sealant (355 466 01) 1 |  |
| Front 12 mm adapters (B4104201) 1 |  |
| Rear 12x142mm adapters for Instant Drive 360 (B49 896 01 for ID360 6T, B49 899 01 for ID360 CL) 1 |  |
| UST valve and accessories (129 838 01) |  |
| Specific disc bolts (308 719 01) Pack of 6 |  |
| Multifunction adjustment wrench (325 423 01) 1 |  |
| User guide | |

COMPATIBILITY

| | |
|---|--|
| Freewheel: Shimano/Sram, convertible to Campagnolo and XD-R with optional driver bodies | |
| Front axle: convertible from 12mm thru axle to quick release or 15mm thru axle with optional adapters | |
| Rear axle: 12mm thru axle, convertible to Quick Release with optional adapters | |

Specifications

RIMS

- **Material** : Maxtal
- **Height** : 26mm, asymmetrical
- **Joint** : SUP
- **Drilling** : Fore

Disc brake specific profile

- **Weight reduction** : ISM 4D
- **Valve hole diameter** : 6.5 mm
- **Tire** : UST Tubeless and tubetype
- **Internal width** : 19 mm
- **ETRTO size** : 622x19C

SPOKES

- **Material** : steel
- **Shape** : straight pull, bladed
- **Nipples** : Fore integrated aluminum
- **Count** : 24 front and rear
- **Lacing** : front crossed 2, rear Isopulse

WHEEL HUB

- **Front and rear bodies** : aluminum
 - **Axle material** : aluminum
- Sealed cartridge bearings
- **Freewheel** : Instant Drive 360
 - **Front** : Quick release, 12 thru and 15 thru compatible
 - **Rear** : 12x142 (convertible to quick release with optional adapters)

VERSIONS

- **Color** : Black only
- **Disc standard** : 6 Bolts or Center Lock(R)

WHEEL WEIGHTS

Wheel weight 780