

# MAVIC Cosmic Carbone 40 C

1  
2016  
REAR

ASTM CATEGORY 1 : road only  
Recommended weight limit : 120kg

## REFERENCES WHEELS

R78001 CC40C Rr 16

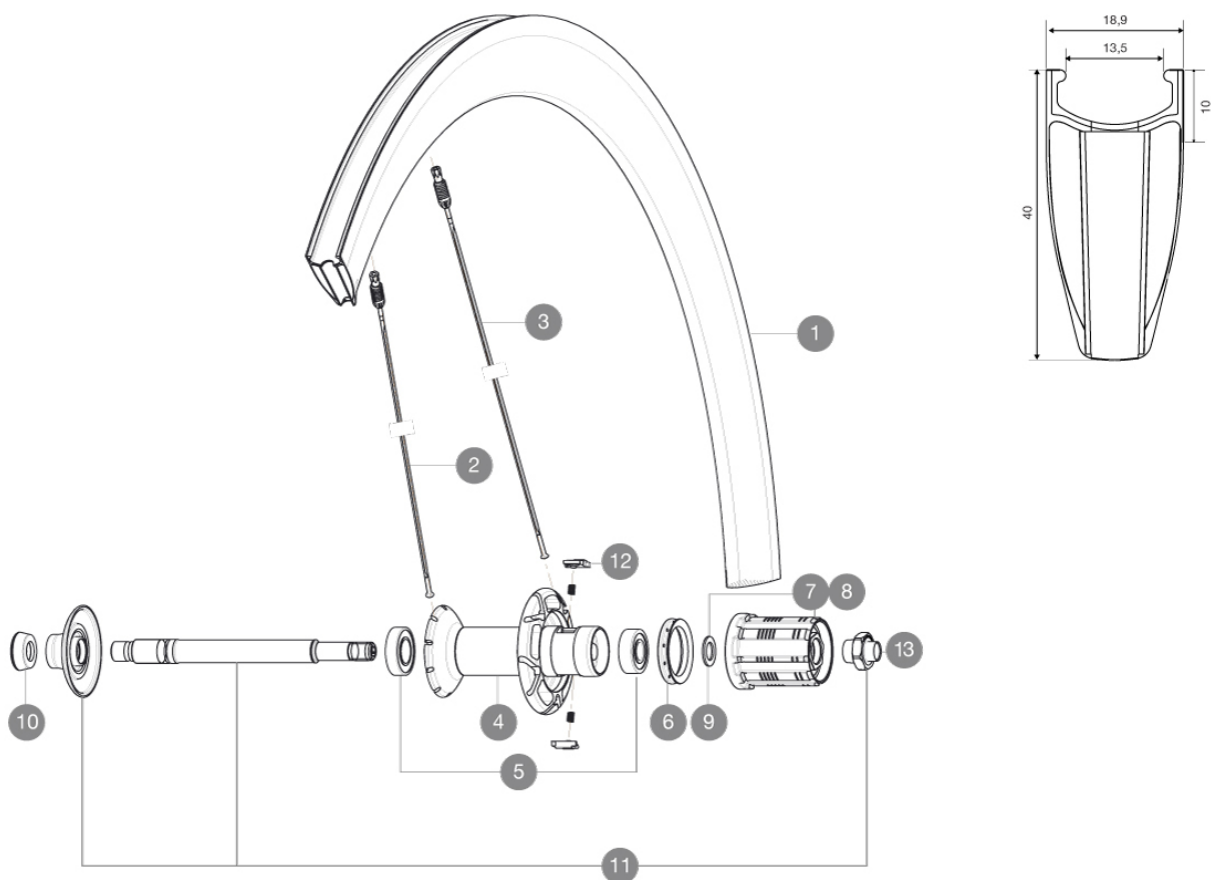

## RIMS



&NBSP::

1	32978213	KIT REAR RIM CC 40 CLINCHER
---	----------	-----------------------------

## SPOKES

2	V3664201	KIT 12 FR7/ND5 STAINLESS SPOKE CC40 C 277mm
2	32979001	KIT 10 AERO FT/ND5 CC 40 C BLACK SPOKE 277mm - while stock I
3	32978901	KIT 10 AERO DS CC 40 C BLACK SPOKE 275mm - while stock last
3	V3664101	KIT 12 DRIVE SIDE STAINLESS SPOKE CC40 C 275mm

## HUB SHELLS

4	N/A	HUB BODY
5	33000001	REAR HUB B9+6901 BEARINGS 2013
6	99500001	FTSL/FTSX FREEHUB BODY SEAL
7	30871101	FTS-L ROAD FREEWHEEL BODY HG11 8/9 compatible
8	30871201	FTS-L ROAD FREEWHEEL BODY ED11 8/9 compatible
9	30872801	SET OF 3 INTERNAL SILVER SPACERS 9mm FTS-L
11	V2250301	KIT REAR AXLE AERO HUB CXR/CC40/CC SLS/CC SLE/COSMIC PRO CAR
12	M40578	FTSL PAWLS KIT (ROAD WHEELS)
13	V2373101	KIT NUT FOR ROAD ALLOY THROUGH AXLE 9mm

## ADAPTERS

10	35117301	FT/RR FORK REST R-SYS/CC ULTIMATE > 2013/KSY PRO CARB T
----	----------	---

# MAVIC Cosmic Carbone 40 C

## DELIVERED WITH

BR601 quick releases	
Carbon brake pads	
Multifonction adjustment wrench	
User guide	

## Specifications

### RIMS

- **Material** : 3K carbon fibers with aluminum cooling system
- **Height** : 40 mm
- **Drilling** : co-molded Fore drilled inserts
- **Brake track** : carbon
- **Brake track** : carbon with TgMAX technology
- **Valve hole diameter** : 6.5 mm
- **Tyre** : clincher
- **ETRTO size** : 622x13C
- **Recommended tyre sizes** : 21 to 28 mm

### SPOKES

- **Material** : steel
- **Shape** : straight pull, bladed, double butted
- **Nipples** : Fore integrated aluminum
- **Count** : front 16, rear 20
- **Lacing** : radial front and rear non-drive side, crossed 2 rear drive side

### WHEEL HUB

- **Front and rear bodies** : carbon center tube and aluminum flanges
  - **Axle material** : aluminum
- Adjustable sealed cartridge bearings
- **Freewheel** : FTS-L steel

### WHEEL WEIGHTS

Wheel weight 875