

REFERENCES WHEELS

328367 C CARBONE SLR 013 M10 WTS 328368 C CARBONE SLR 013 ED11 WTS

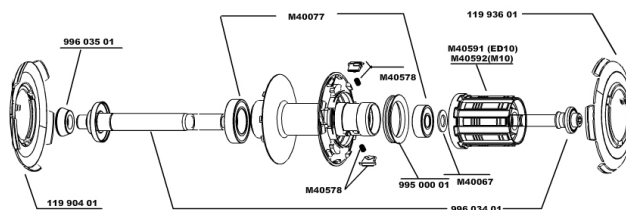

RIMS

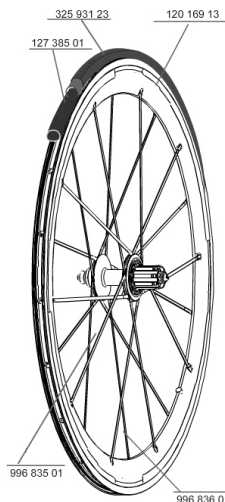

&NBSP;:

12016913 KIT REAR COSMIC CARBONE SLR RIM

SPOKES

99683501 5 SPOKES CARBONE SLR FRT+OFW
99683601 KIT 5 DRIVE SIDE COSMIC CARBONE SLR R2R SPOKE

HUB SHELLS

M40067 INTERNAL FREEWHEEL SPACER FTSL/FTSX
11990401 FRT/NON DS COSMIC CARBON SLR HUB CAP
M40077 REAR HUB 608+6901 BEARINGS
M40591 FTSL FREEWHEEL BODY ED10
99603501 R.FORK SUPPORT COS.CARB.ULTIMATE < 2014
99500001 FTSL/FTSX FREEHUB BODY SEAL
M40578 FTSL PAWLS KIT (ROAD WHEELS)
11993601 DRIVE SIDE COSMIC CARBON SLR HUB CAP
99603401 REAR AXLE COS.CARBONE ULTIMATE
M40592 FTSL FREEWHEEL BODY M10

MAINTENANCE

12738501 Road Innertube Presta 48mm

TYRES

32593123 YksionProSSCPowerLink 23

MAVIC *Cosmic Carbone SLR***DELIVERED WITH**

| | |
|-------------------------------|--|
| BR601 quick releases | |
| Rim tape | |
| Wheelbags | |
| Exalith brake pads | |
| Valve extender | |
| Computer magnet (front wheel) | |
| User guide | |

Specifications**RIMS**

- **Material** : Mactal
- **Material** : Mactal and 12K carbon fiber
- **Color** : carbon and Exalith
- **Height** : 52 mm
- **Joint** : SUP
- **Drilling** : traditional
- **Eyelet** : single
- **Brake track** : Exalith 2
- **Weight reduction** : ISM
- **Valve hole diameter** : 6.5 mm
- **Tyre** : clincher
- **ETRTO size** : 622x13C
- **Recommended tyre sizes** : 19 to 28 mm

SPOKES

- **Material** : unidirectional carbon fiber
- **Shape** : R2R
- **Color** : carbon
- **Nipples** : ABS, front aluminum, rear brass
- **Count** : 20 front and rear
- **Lacing** : front and rear crossed 2

WHEEL HUB

- **Front and rear bodies** : aluminum
- **Color** : black
- **Front and rear axle material** : aluminum QRM+
- **FTS-L steel**

WHEEL WEIGHTS

Wheel weight 870