

# MAVIC E-SPEEDCITY 1 650B

## REFERENZE RUOTE

ASTM CATEGORY 2 : road and offroad with jumps less than 15cm  
 Misura minima del pneumatico: larghezza 52 mm - pressione massima 2,35 Bar/34 PSI  
 Recommended tire sizes: 50mm to 76mm (2.0" to 3.0")  
 Misura massima del pneumatico: larghezza 125 mm - pressione massima 1,25 Bar/18 PSI  
 For a longer longevity of the wheel, Mavic recommends that the total weight supported by the wheels doesn't exceed 180kg, E-bike included

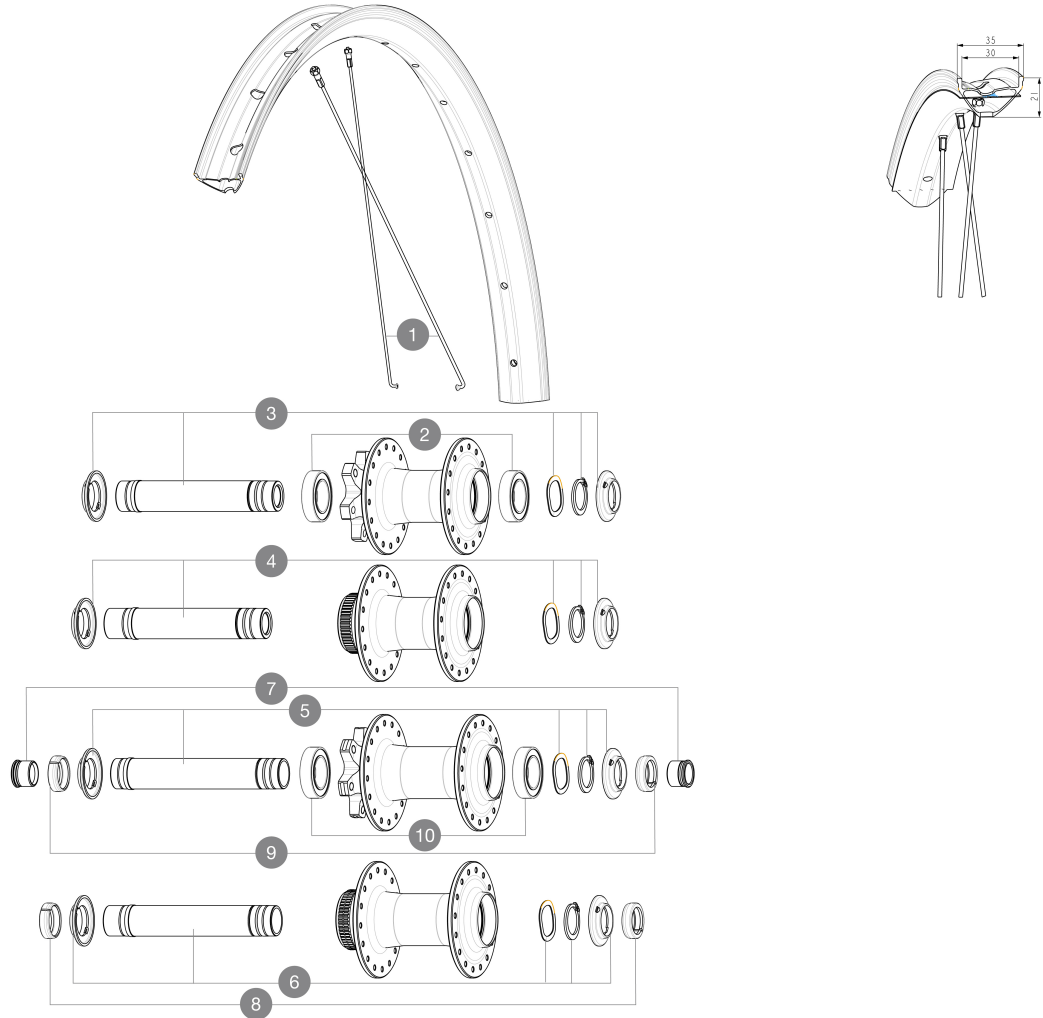

### SPOKES

1	V00062531	Kit 16ft/rr Jbent bk rd spk275 27,5"+np
---	-----------	---

### HUB SHELLS

	V2500901	KIT BEARINGS 18x30x7 + WAVED WASHER + CLIP
3	V2375501	Kit QRM auto front axle 100x12/15mm D6T
4	V2374001	KIT 12x100mm FRONT AXLE DCL QRM AUTO ALLROAD > 2019
5	V2372401	KIT 110mm AXLE QRM AUTO MTB > 2019
6	V2375601	Kit 110mm axle QRM auto MTB from 2019 DCL

### ADAPTERS

7	V2680201	12mmFtRoadAxleAdaptersQRM
8	V2680501	12mm Road Axle Cap QRM Auto
9	V2372501	15mm MTB Axle Cap QRM Auto From 2019
	V2680301	"Kit Ft Road Adapter 12 >>> 9mm"
	99694101	2 REDUCERS 15/9mm

**MAVIC** **E-SPEEDCITY 1 650B****VENDUTO CON**

User guide	
Flap tubeless preinstallato	
Rondella per cassetta M9 non montata sulla ruota posteriore	
Rondella per cassetta M9 non montata sulla ruota posteriore	
User guide	
User guide	
Flap tubeless preinstallato	

**COMPATIBILITY**

Freewheel: Shimano/Sram, convertible to Campagnolo ED11, N3W and XD-R with optional driver bodies	
Front axle: 12mm thru axle, easily convertible to quick release with optional adapters. Convertible to 15mm with complete axle replacement	
Rear axle: 12mm thru axle, convertible to Quick Release with optional adapters and axle replacement	
Corpo ruota libera: convertibile SRAM XD strada (kit V2580101 venduto separatamente)	
Corpo ruota libera: convertibile SRAM XD strada (kit V2580101 venduto separatamente)	
Corpo ruota libera: convertibile SHIMANO HG light strada (kit V3850101 venduto separatamente)	
Corpo ruota libera: convertibile SHIMANO HG light strada (kit V3850101 venduto separatamente)	
Corpo ruota libera: convertibile SHIMANO MS (kit V3990101 venduto separatamente)	
Corpo ruota libera: convertibile SHIMANO MS (kit V3990101 venduto separatamente)	
Front axle: 12mm thru axle, easily convertible to quick release with optional adapters. Convertible to 15mm with complete axle replacement	
Front axle: 12mm thru axle, easily convertible to quick release with optional adapters. Convertible to 15mm with complete axle replacement	
Corpo ruota libera: convertibile CAMPAGNOLO N3W (kit V4270101 venduto separatamente)	
Corpo ruota libera: convertibile CAMPAGNOLO N3W (kit V4270101 venduto separatamente)	
ID360 Shimano Micro Spline alloy freewheel body (V3990101)	
Corpo ruota libera ID360 Sram XD (V3740101)	
Perno posteriore: solo per i dadi di fissaggio (inclusi), filettatura M9x1	
Perno posteriore: solo per i dadi di fissaggio (inclusi), filettatura M9x1	
ID360 Shimano Micro Spline alloy freewheel body (V3990101)	