

参照ホイール

ASTM E1108 2 : 62mm-
3.8Bar/55PSI

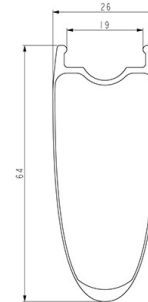
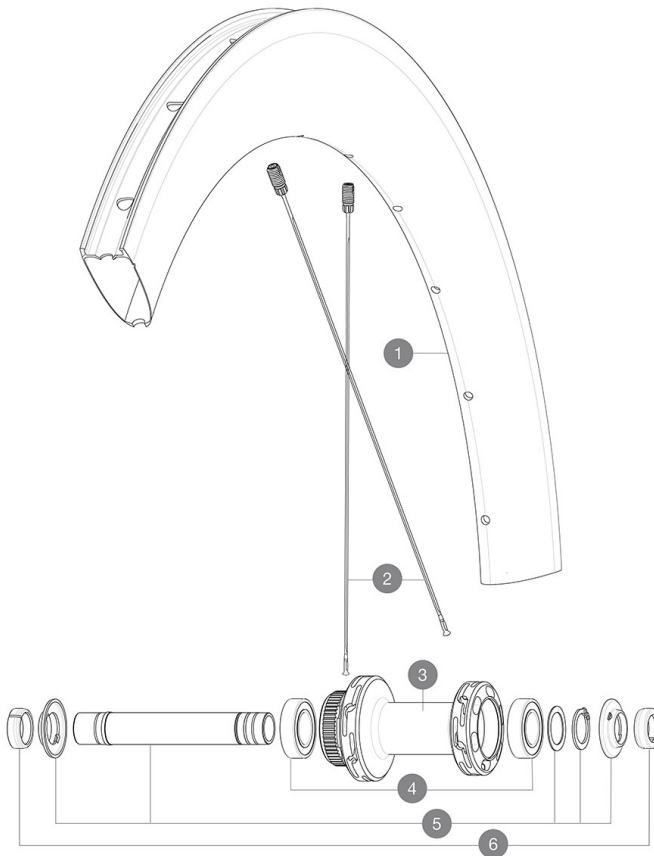

Specifications	Maxi target
Frontal run out	0,4mm
Lateral run out	0,5mm
Centring	1,0mm (2x0,5)
Tension daN Disc side	81 > 107

RIMS



&NBSP;:

- 1 V4093115 Kit Front/Rear rim Cosmic SL 65 Disc while stock lasts
- V2620101 UST RIM TAPE 25mm (for 21-24mm wide rim)

SPOKES

- 2 V4163301 Kit 12 Front/Rear Cosmic SL 65 Disc butted stainless spoke 2

HUB SHELLS

- 3 N/A HUB BODY
- 4 M40129 KIT 2 BEARINGS 6902 15x28x7
- 5 V2373301 KIT QRM AUTO FRONT AXLE 12mm > 2019

OPTIONS

- V2680501 12mm Road Axle Cap QRM Auto

ADAPTERS

- 6 V2680301 "Kit Ft Road Adapter 12 >> 9mm"

