

参照ホイール

ASTMèj□æ¼ã□«ã□□ã□'ã□*ã□¼2:ã□-ã□¼ã□□+ã□,ã□£ã□'ã□□15ã□□ã□¼ã□\$ã□@ã□*ã□□ã□ã□¼ã□□ã□□ã□¼ã□«ã□□é□·æ□□ã□jã□□ã□□ã□□ã□□é□«è»□ã□□ã□«ã□□ã□□ã□¼ã□«ã□«ã□□ã□□ã□□ç□é□□é□□ã□□120ã□ã□-ã»¥ã□ã□'ã□□ã□□ã□□ã□'ã□□æ□'ã¥

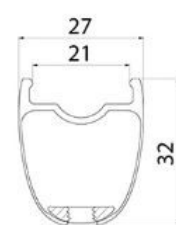
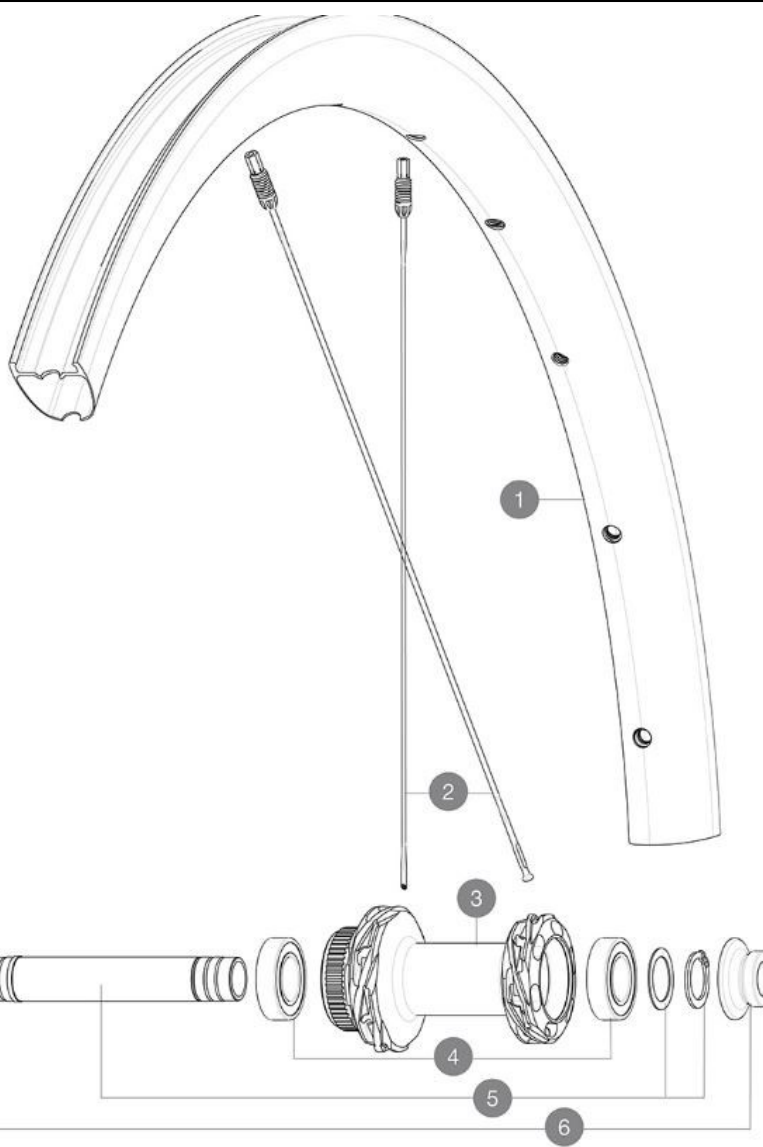

Specifications	Maxi target
Frontal run out	0,4mm
Lateral run out	0,5mm
Centring	1,0mm (2x0,5)
Tension daN Disc side	87 > 105

RIMS



&NBSP;:

- 1 V4094615 Kit Front/Rear rim Cosmic SLR 32 Disc

SPOKES

- 2 V4164801 Kit 12 CosmicSLR32 Disc aero sspk M6 291

HUB SHELLS

- 3 N/A HUB BODY
- 3 N/A HUB BODY
- 4 M40129 KIT 2 BEARINGS 6902 15x28x7
- 5 V2373301 KIT QRM AUTO FRONT AXLE 12mm > 2019

OPTIONS

- V2680301 "Kit Ft Road Adapter 12 >> 9mm"

ADAPTERS

- 6 V2374701 KIT FRONT ROAD FORK REST 12mm FOR J BENT DISC HUB

付属品

UST 129 838 01	

COMPATIBILITY

SRAM XD V2580101	
SHIMANO HG V3850101	
SHIMANO MS V3990101	
CAMPAGNOLO EDI V3440101	
CAMPAGNOLO N3W V4270101	
ID360 N3W	
15mm M9x1	
ID360	
FTS-L	
ID360	
ID360 XD	
M9x1	
ID360	

Specifications

リム

100%
UDÅ

32mm / Update date: 2024-03-

21 mm

ホイールハブ

INFINITY

32mm

21 mm