

参照ホイール

118093 COSMIC CARBONE SL011 FRT

118097

COSMIC CARBONE SL011
ED11PR

118096 COSMIC CARBONE SL011 M10 PR

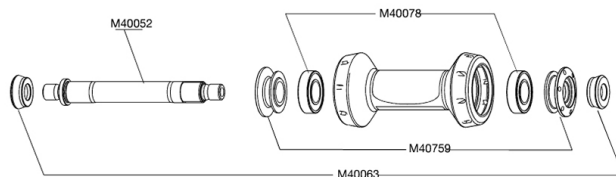
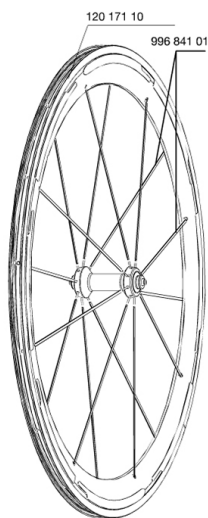

RIMS



&NBSP;:

12017110 KIT FRONT COSMIC CARBONE SL 11 RIM

SPOKES

99684101 8 SPOKES CARBONE SL 09 FRONT 289mm

HUB SHELLS

M40052 FRONT HUB AXLE

M40759 ADJUST.NUT+CAP XMAX SL CERA FR

M40078 FRONT HUB 6901 BEARINGS

M40063 2 FRONT AXLE FORK SUPPORT

MAVIC Cosmic Carbone SL

付属品

BR301 Â¿Â¿Â¿Â¿Â¿Â¿Â¿Â¿Â¿Â¿Â¿Â¿Â¿	
Â¿Â¿Â¿Â¿Â¿Â¿Â¿	
Â¿Â¿Â¿Â¿Â¿Â¿Â¿Â¿Â¿Â¿	
Â¿Â¿Â¿Â¿Â¿Â¿Â¿	
Â¿Â¿Â¿Â¿Â¿Â¿Â¿	

Specifications

リム

Â¿Â¿Â¿ MactalÂ¿Â¿Â¿Â¿Â¿Â¿
 Â¿Â¿Â¿
 Â¿Â¿Â¿Â¿Â¿Â¿Â¿12KAÂ¿Â¿Â¿Â¿Â¿Â¿
 Â¿Â¿Â¿Â¿Â¿Â¿Â¿
 Â¿Â¿Â¿Â¿ 52 mm
 Â¿Â¿Â¿Â¿Â¿Â¿Â¿ SUP
 Â¿Â¿Â¿Â¿Â¿Â¿Â¿Â¿Â¿Â¿Â¿Â¿
 Â¿Â¿Â¿Â¿Â¿Â¿Â¿ Â¿Â¿Â¿
 Â¿Â¿Â¿Â¿Â¿Â¿Â¿ UBÂ¿Â¿Â¿Â¿
 Â¿Â¿Â¿Â¿ ISM
 Â¿Â¿Â¿Â¿Â¿ 6.5 mm
 Â¿Â¿Â¿Â¿Â¿ Â¿Â¿Â¿Â¿
 ETRTO Â¿Â¿Â¿ 622x13C
 Â¿Â¿Â¿Â¿Â¿ 19Â¿28 mm

スポーク

Â¿Â¿Â¿Â¿
 Â¿Â¿Â¿Â¿ Â¿Â¿Â¿Â¿Â¿Â¿
 Â¿Â¿Â¿Â¿
 Â¿Â¿Â¿Â¿ ABS
 Â¿Â¿Â¿ 16Â¿ 20Â¿
 Â¿Â¿Â¿Â¿Â¿Â¿Â¿
 Â¿Â¿/2Â¿

ホイールハブ

Â¿Â¿Â¿/Â¿Â¿Â¿
 Â¿Â¿Â¿
 Â¿Â¿Â¿/Â¿Â¿Â¿
 Â¿
 QRM+
 FTS-LÂ¿Â¿

ホイールの重み

ホイール重量 (クイックリリー
 スおよびクリンチャー/チュー
 ブラーを除く) (g) : 780