

参照ホイール

328366 C CARBONE SLR 013 FRT WTS

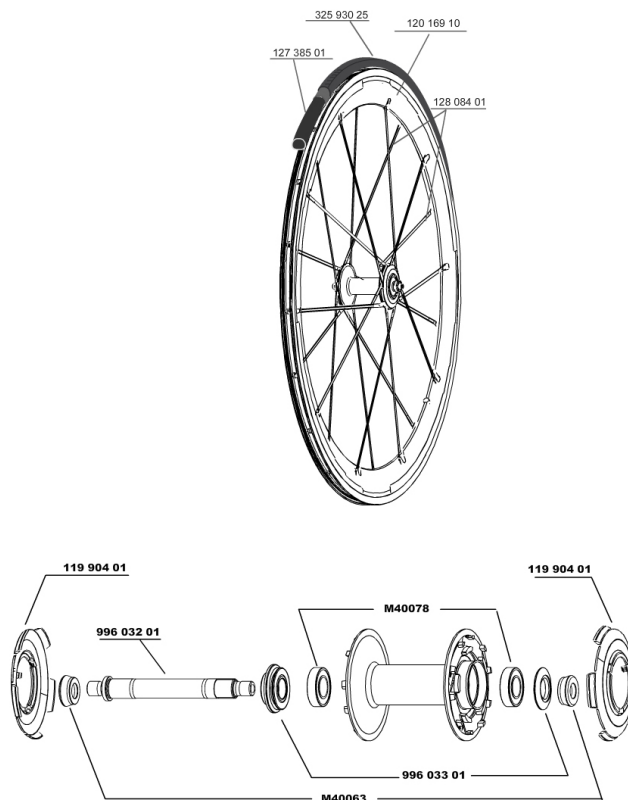

RIMS



&NBSP;:

12016910 FRONT COSMIC CARBONE SLR RIM

SPOKES

12808401 5 COSMIC CARBONE SLR FRT/OPP.DRV SPOKES + 2 CAPS

HUB SHELLS

99603301 ADJUST.NUT+CAP COS.CARB.ULTIMATE
 M40078 FRONT HUB 6901 BEARINGS
 11990401 FRONT & OPP.DRIVE SIDE COS.CARB.SLR HUB CAP
 99603201 FRT AXLE COS.CARBONE ULTIMATE
 M40063 2 FRONT AXLE FORK SUPPORT

MAINTENAN

CE

12738501 Road Innertube Presta 48mm

MAVIC Cosmic Carbone SLR

付属品

BR601 A A A A A A A A A A A A A A A A A A	
A A A A A A A A A A	
A A A A A A A A A A	
A A A A A A A A A A A A A A A A A A	
A A A A A A A A A A A A A A A A	
A A	
A A A A A A A A A A	

Specifications

リム

A A A A
A A A A A A A A 12KA A A A A A A A A A A
A A A A Maxtal A A A A A A A A
A A A A A
A A A A A A A A A A A A A A A A A
A A A A A A 52 mm
A A A A A A A A A A SUP
A A A A A A A A A A A A A A A A A
A A A A A A A A A A A A A A
A A A A A A A A A A A A A A A A A 2
A A A A A A ISM
A A A A A A A A A A 6.5 mm
A A A A A A A A A A A A A A
ETRTO A A A A A A 622x13C
A A A A A A A A A A A A A A 19A A 28 mm

スポーク

A
A A A A A A A A
A A A A A R2R
A A A A A A A A A A A A
A A A A A A A A A A A A A A A A A A A
A A A A A A A A A A
A A A A A A A A A A A A A A 20 A
A A A A A A A A A A A A
A A A A A A A A A A A A A A A A A A A

ホイールハブ

A
A A A A A A A A A A A A A A
A
A A A A A
QRM+
FTS-L A A A A A A A A A A

ホイールの重み

ホイール重量 (クイックリリー
スおよびクリンチャー/チュー
ブラーを除く) (g) : 725