

参照ホイール

F14501 Ksyrium Pro Disc Ft CL

F01701 Ksyrium Pro Disc Ft INT

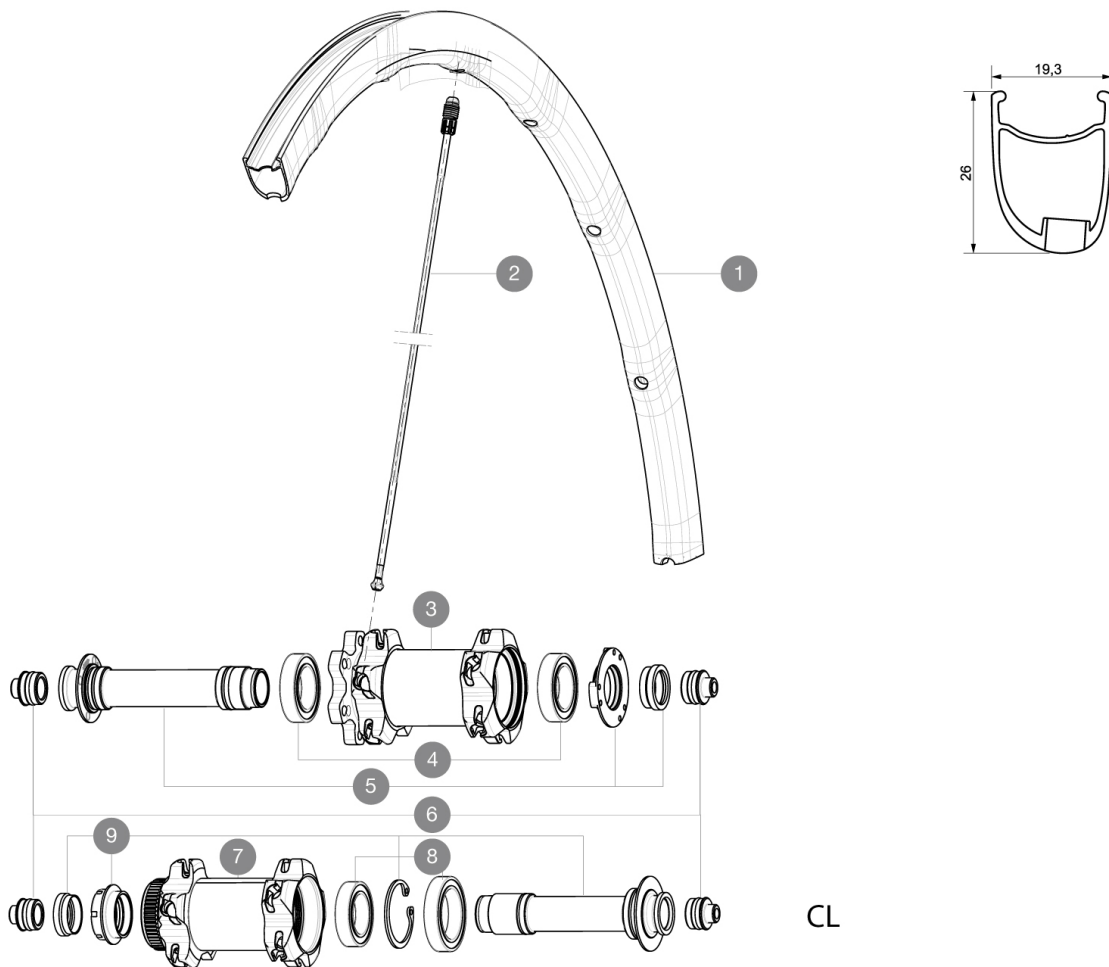

RIMS



バルブ穴径 (MM) : 6.5 :

1	V2290510	KIT FRONT RIM KSYRIUM PRO DISC
---	----------	--------------------------------

SPOKES

2	12029401	10 BLK DRIVE SIDE SPOKES R-SYS SLR CLINCH.294mm
---	----------	---

HUB SHELLS

3	N/A	HUB BODY
4	99688501	BEARING KIT 9/15 D6T HUB
5	99688201	9/15 D6T HUB FRONT AXLE
7	N/A	HUB BODY
8	99688601	BEARING KIT 9/15 DCL HUB 20x32x7 6804 + 25x37x7 6805
9	99688301	9/15 DCL HUB FRONT AXLE

ADAPTERS

6	99694101	2 REDUCERS 15/9mm
---	----------	-------------------

MAVIC Ksyrium Pro Disc

付属品

BX601 quick releases	
Front QR adapters	
Specific disc bolts	
Computer magnet (front wheel)	
Multifonction adjustment wrench	
User guide	

Specifications

リム

- Material : Mxxtal
- Height : 26mm, asymmetrical
- Joint : SUP
- Drilling : Fore
- Disc brake specific profile
- Weight reduction : ISM4D
- Valve hole diameter : 6.5 mm
- Tyre : clincher
- ETRTO size : 622x15C
- Recommended tyre sizes : 19 to 32 mm

スポーク

- Material : Zicral
- Shape : straight pull, bladed
- Nipples : Fore integrated aluminum
- Count : 20 front and rear
- Lacing : front crossed 2, rear Isopulse

ホイールハブ

- Front body : carbon with aluminum flanges
- Rear body : aluminum
- Axle material : aluminum
- Adjustable sealed cartridge bearings
- Freewheel : FTS-L steel

ホイールの重み

ホイール重量 (クイックリリースおよびクリンチャー/チューブラーを除く) (g) : 680