

参照ホイール

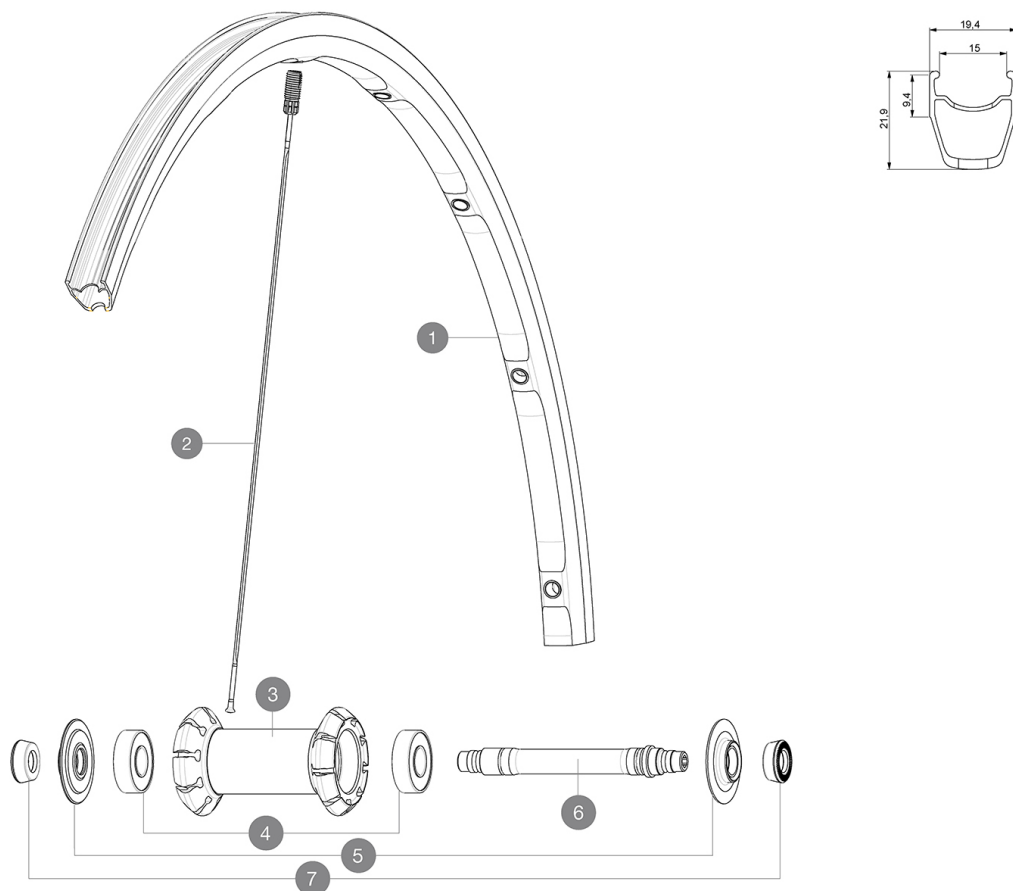

RIMS



&NBSP;:

| | | |
|---|----------|-------------------------------------|
| 1 | V2400410 | FRONT KSYRIUM ELITE RED S BLACK RIM |
| 1 | 33002310 | FRONT KSYRIUM ELITE S BLACK RIM |

SPOKES

| | | |
|---|----------|--|
| 2 | V2270701 | 9 FRONT SPOKES KSYRIUM ELITE S RED 284mm |
| 2 | 33002701 | 9 BLK FRT SPOKES KSYRIUM ELITE S 285,5mm |

HUB SHELLS

| | | |
|---|----------|---|
| 3 | N/A | HUB BODY |
| 3 | N/A | HUB BODY |
| 4 | M40318 | HUB BEARING KIT 6001 |
| 5 | 12038201 | KSYRIUM ELITE 11 HUB CAP AND ADJUST.NUT |
| 6 | 99686101 | KSYRIUM ELITE 09 FRONT AXLE |
| 7 | M40063 | 2 FRONT AXLE FORK SUPPORT |

MAVIC Ksyrium Elite S

付属品

| | |
|---------------------------------|--|
| BR301 quick releases | |
| Multifonction adjustment wrench | |
| User guide | |

Specifications

リム

- Material : Maxtal
- Height : front 22 mm, rear 25 mm asymmetrical
- Joint : SUP
- Drilling : Fore
- Brake track : UB Control
- Weight reduction : ISM
- Valve hole diameter : 6.5 mm
- Tyre : clincher
- ETRTO size : 622x15C
- Recommended tyre sizes : 19 to 32 mm

スポーク

- Material : steel
- Shape : straight pull, bladed, front double butted
- Nipples : Fore integrated aluminum
- Count : front 18, rear 20
- Lacing : front radial, rear Isopulse

ホイールハブ

- Front and rear bodies : aluminum
- Axle material : aluminum
- Adjustable sealed cartridge bearings
- Freewheel : FTS-L steel

ホイールの重み

ホイール重量(クイックリリースおよびクリンチャー/チューブラーを除く)(g) : 680