

ASTM CATEGORY 1 : road only

For a longer longevity of the wheel, Mavic recommends that the total weight supported by the wheels doesn't exceed 120kg, bike included

Recommended tyre sizes: 21 to 32 mm
Max. Pressure: 25mm 7.7 bars - 110 PSI

参照ホイール

F34301 KsyProExalithSLFt

F70901

KsyProExalithSLFt Limited

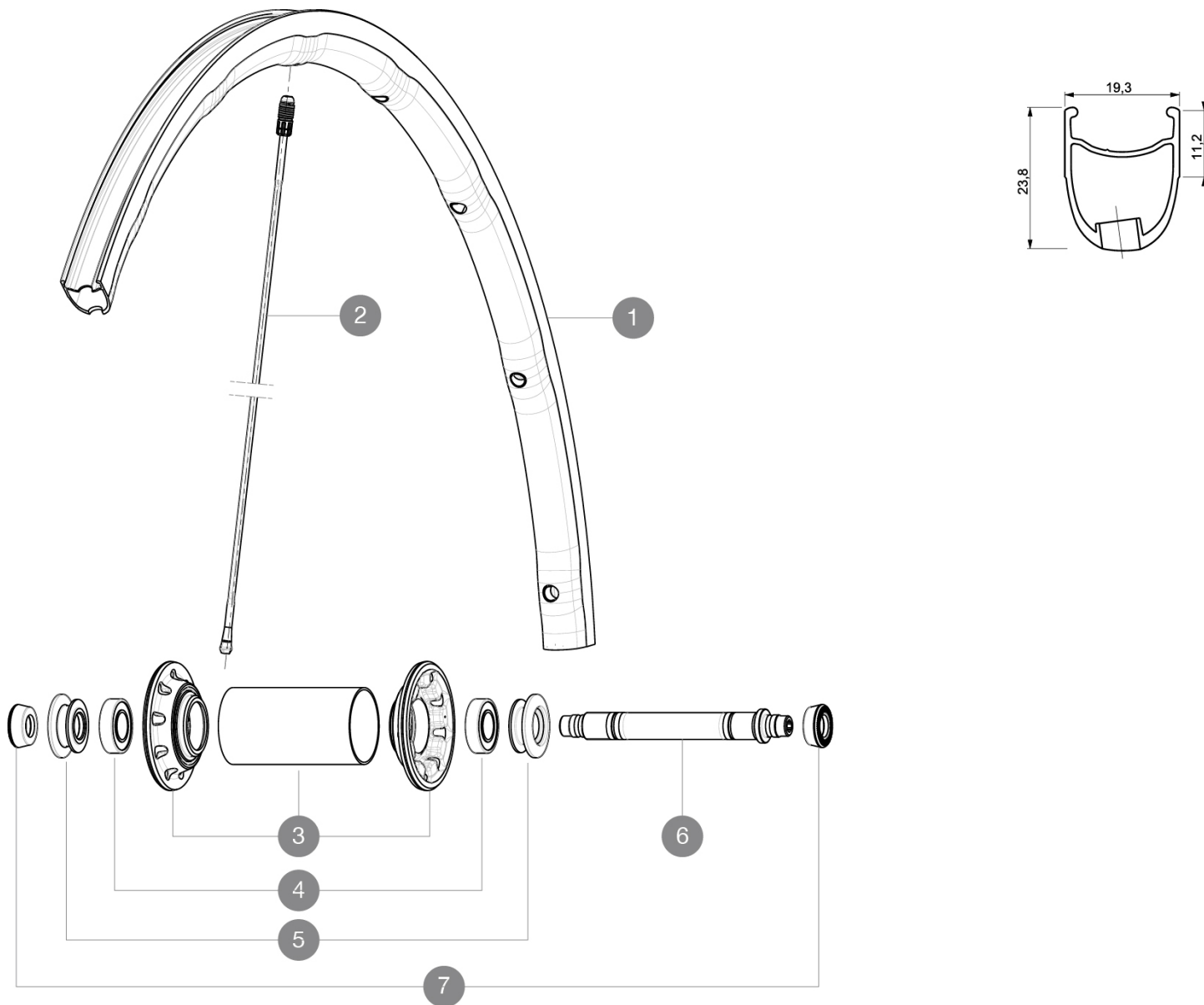

RIMS



バルブ穴径 (MM) : 6.5 :

1	V2405110	Kit Frt Rim KProExalithSLLtd
1	V2290110	KIT FRONT RIM KSYRIUM SLR 2015

SPOKES

2	V2272901	KIT 1 FT282+1 RR293 KSY PRO EXAL SL LTD SPK - while stock la
2	V2270601	SPOKES KIT FRONT KSYRIUM SLR 2015/K125

HUB SHELLS

3	N/A	HUB BODY
4	M40078	FRONT HUB 6901 BEARINGS
5	M40759	ADJUST.NUT+CAP XMAX SL CERA FR
6	32999801	FRONT AXLE KIT R-SYS / KSYRIUM SL/SLS 2013

ADAPTERS

7	35117301	FRONT OR REAR FORK REST KIT R-SYS 2013
---	----------	--



Ksyrium Pro Exalith SL

付属品

BR601 quick releases	
BR601 quick releases	
Exalith brake pads	
Exalith brake pads	
Multifunction adjustment wrench	
Tracomp ring tool	
User guide	
Multifunction adjustment wrench	
Tracomp ring tool	
User guide	

COMPATIBILITY

Freewheel: Shimano/Sram, convertible to Campagnolo with optional driver body	
Front axle: Quick Release only	
Rear axle: Quick Release only	

Specifications

リム

- Material : Mxtral
- Height : front 24mm, rear 26 asymmetrical
- Joint : SUP
- Drilling : Fore
- Brake track : Exalith 2
- Weight reduction : ISM 4D
- Valve hole diameter : 6.5 mm
- Tyre : clincher
- Material : Mxtral
- Height : front 24mm, rear 26 asymmetrical
- ETRTO size : 622x15C
- Recommended tyre sizes : 21 to 32 mm
- Joint : SUP
- Drilling : Fore
- Brake track : Exalith 2
- Weight reduction : ISM 4D
- Valve hole diameter : 6.5 mm
- Tyre : clincher
- Internal width : 15mm
- ETRTO size : 622x15C

スポーク

- Material : front and rear drive side Zicral, Rear non drive side carbon fiber
- Shape : front and rear drive side straight pull bladed double butted, rear non drive side Tracomp
- Nipples : Fore integrated aluminum
- Material : front and rear drive side Zicral, Rear non drive side carbon fiber
- Count : front 18, rear 20
- Lacing : radial front and rear non-drive side, crossed 2 rear drive side
- Shape : front and rear drive side straight pull bladed double butted, rear non drive side Tracomp
- Nipples : Fore integrated aluminum

ホイールハブ

- Front body : carbon with aluminum flanges
- Rear body : aluminum
- Rear body : aluminum
- Axle material : aluminum
- Front body : carbon with aluminum flanges
- Adjustable sealed cartridge bearings
- Freewheel : FTS-L steel
- Axle material : aluminum
- Adjustable sealed cartridge bearings
- Freewheel : FTS-L steel

VERSIONS

- Color : Black only

ホイールの重み

ホイール重量 (クイックリリー
スおよびクリンチャー/チュー
ブラーを除く) (g) : 605