

ASTM A2300 1 : 120
25 32 mm
23mm 8.7 bars - 125 psi, 25mm 7.7 bars - 110 psi

参照ホイール

F76231 CometeProCarbExaFtSV

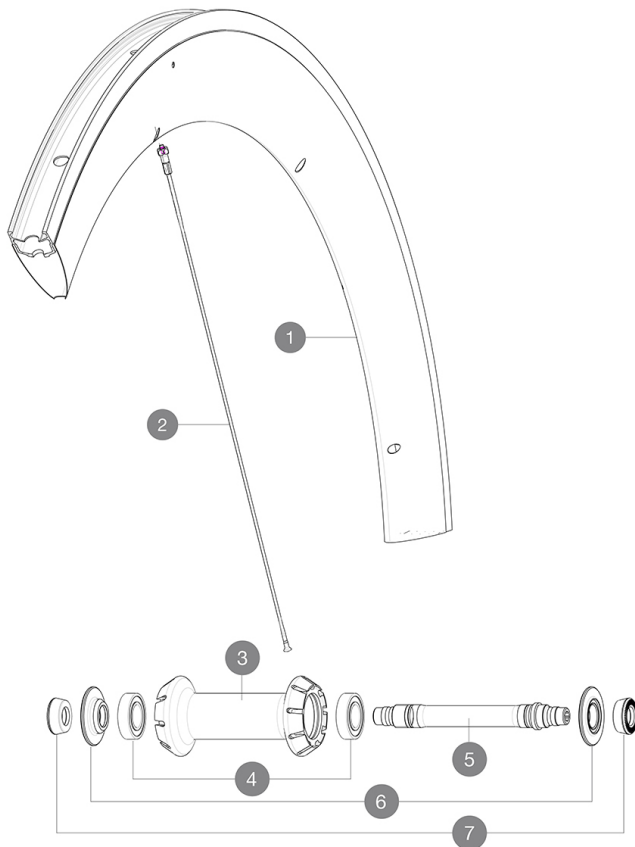

RIMS



&NBSP;:

1	V2732410	KIT FRONT RIM COMETE PRO CARBON EXALITH
	V2690201	KIT CARBON RIM TAPE 18x622mm (SPECIAL RIM TAPE)

SPOKES

2	V2279401	KIT 8 FRT COMETE PRO CARBON SPOKE 287mm - while stock last
2	V3661801	KIT 12 FRT COMETE PRO CARBON BUTTED AERO STAINLESS SPOKE 287

HUB SHELLS

3	N/A	HUB BODY
4	M40078	FRONT HUB 6901 BEARINGS
5	30870001	FRONT AXLE ROAD RIM BRAKING QRM +
6	V2252501	FRONT SETTING NUT & DUST PROTECTOR MY16

TYRES

8	37805325	Yksion Pro GripLink White 25
---	----------	------------------------------

ADAPTERS

7	35117301	FRONT OR REAR FORK REST KIT R-SYS 2013
---	----------	--



Comete Pro Carbon Exalith

付属品

BR301 (V24 501 01)	
BR301 (V24 501 01)	
(V24 703 01 / V24 704 01)	
(V24 703 01 / V24 704 01)	
(325 423 01)	
(325 423 01)	

COMPATIBILITY

Specifications

リム

- 12K
- 60mm
- 60mm
- SUP
- SUP
- 6.5mm
- 6.5mm
- 17mm
- 17mm
- ETRTO : 622x17C
- ETRTO : 622x17C

ホイールハブ

- 360
- 360

ホイールの重み

785

VERSIONS

スポーク

ABS
20
20