

参照ホイール

æ□□á°□ā□¿□ā□#ā□#ā□μā□#ā□°%□á' 23mm-
æ□□á#§ç°æ°□á□§6.75Bar/97PSI
ASTMè;□æ % á□«ā□□ā□' á□°ā□% 2 : ā□-
ā□%ā□□+ā□,ā□£ā□°ā□□15ā□□ā□%ā□\$ā□@ā□°ā□□ā□□ā□%ā□□
ā□□ā□#ā□%ā□«ā□□é□·æ□□ā□;ā□□ā□□ā□□ā□□é□*è»□ā□□
ā□«ā□□ā□□#ā□%ā□«ā□«ā□□ā□□ā□□ç·□é□□é□□ā□□120ā□□ā□-
ä»¥ā□ ā□'ā□□ā□□ā□□ā□'ā□□æ□'ā¥
æ□□á#§ä¿□ā□#ā□#ā□μā□#ā□°%□á' 62mm-
æ□□á#§ç°æ°□á□§3.8Bar/55PSI

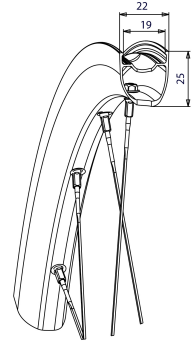

RIMS

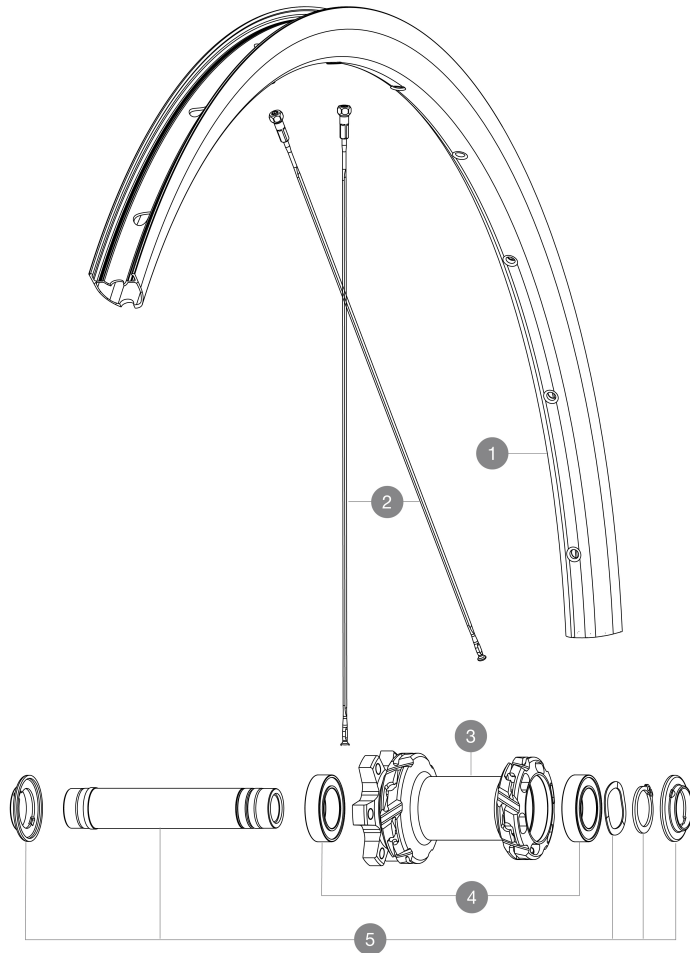

&NBSP;:

1	V4094310	Kit Front rim Ksyrium S Disc EBM
	V2620101	UST RIM TAPE 25mm (for 21-24mm wide rim)

SPOKES

2	V4164401	Kit 12 Front Ksyrium S Disc EBM butted spoke 291mm + steel n
---	----------	--

HUB SHELLS

3	N/A	HUB BODY
4	V2500901	KIT BEARINGS 18x30x7 + WAVED WASHER + CLIP
5	V2375501	Kit QRM auto front axle 100x12/15mm D6T

付属品

Table with 2 columns: Part Name and Part Number. Rows include MAVIC disc, QR skewers, and UST skewers for different disc sizes.

COMPATIBILITY

Table with 2 columns: Compatibility Information and Part Number. Rows describe compatibility with various disc sizes and axle types.

Specifications

リム

Technical specifications for the rim, including width (22mm), weight, and compatibility with various disc sizes and axle types.

スポーク

Technical specifications for the spokes, including weight and compatibility with different disc sizes.

ホイールハブ

Technical specifications for the wheel hub, including weight, dimensions, and compatibility with various disc sizes.

ホイールの重み