

参照ホイール

328191 COSMIC CARBONE SLS ED11 WTS

328190 COSMIC CARBONE SLS M11 WTS

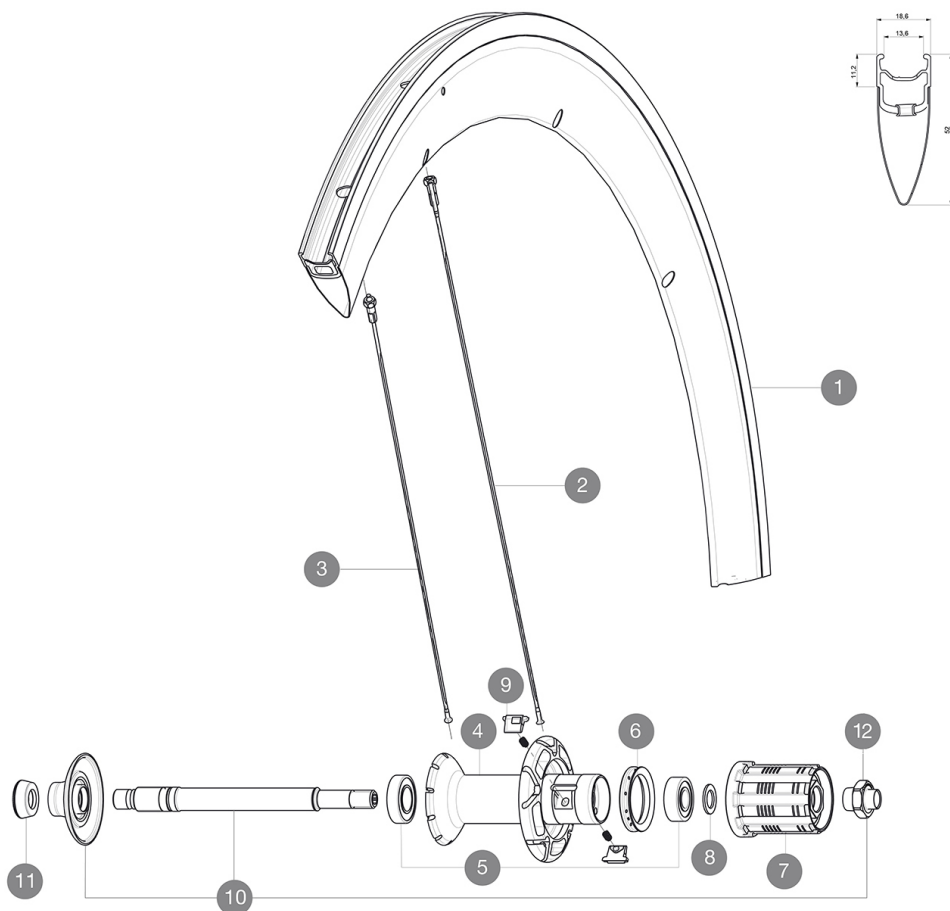

RIMS



&NBSP;:

1	V4091613	KIT REAR RIM COSMIC CARBON SLS/COSMIC PRO CARBON V
1	12017113	RIM REAR COSMIC CARBONE SL 11 RIM - while stock last

SPOKES

2	36644401	10 BLK AERO SPOKES DRIVE SIDE CC SLS 287mm
3	36644501	10 BLK AERO SPOKES FRONT/NON DRIVE SIDE CC SLS 289mm

HUB SHELLS

4	N/A	HUB BODY
5	33000001	REAR HUB B9+6901 BEARINGS 2013
6	99500001	FTSL/FTSX FREEHUB BODY SEAL
7	30871201	FTS-L FREEWHEEL BODY ED11 2013 (8 or 9mm axle compatible)
7	30871101	FTS-L FREEWHEEL BODY HG11 2013 (8 or 9mm axle compatible)
8	30872801	SET OF 3 INTERNAL SILVER SPACERS 9mm FTS-L 2013
9	M40578	FTSL PAWLS KIT (ROAD WHEELS)
10	V2250301	KIT REAR AXLE AERO HUB CXR/CC40/CC SLS/CC SLE/COSMIC PRO CARBON
12	V2373101	RIM NUT FOR ROAD ALLOY THROUGH AXLE 9mm

ADAPTERS

11	35117301	FRONT OR REAR FORK REST KIT R-SYS 2013
----	----------	----------------------------------------



Cosmic Carbone SLS

付属品

BR601 Â¿Â¿Â¿Â¿Â¿Â¿Â¿Â¿Â¿Â¿Â¿Â¿Â¿	
Â¿Â¿Â¿Â¿Â¿Â¿Â¿	
Â¿Â¿Â¿Â¿Â¿Â¿Â¿	

Specifications

リム

Â¿Â¿Â¿
 Â¿Â¿Â¿Â¿Â¿Â¿Â¿12KÂ¿Â¿Â¿Â¿Â¿Â¿Â¿Â¿
 Â¿Â¿Â¿Â¿Â¿ 52 mm
 Â¿Â¿Â¿Â¿Â¿Â¿Â¿ SUP
 Â¿Â¿Â¿Â¿Â¿Â¿Â¿ Â¿Â¿Â¿Â¿Â¿Â¿Â¿
 Â¿Â¿Â¿Â¿Â¿Â¿Â¿ UBAÂ¿Â¿Â¿Â¿Â¿
 Â¿Â¿Â¿Â¿Â¿ ISM
 Â¿Â¿Â¿Â¿Â¿Â¿Â¿ 6.5 mm
 Â¿Â¿Â¿Â¿Â¿ Â¿Â¿Â¿Â¿Â¿Â¿
 ETRTO Â¿Â¿Â¿Â¿Â¿ 622x13C
 Â¿Â¿Â¿Â¿Â¿Â¿Â¿Â¿Â¿ 19Â¿28 mm

スポーク

Â¿Â¿Â¿Â¿Â¿Â¿Â¿
 Â¿Â¿Â¿Â¿ Â¿Â¿Â¿Â¿Â¿Â¿Â¿Â¿Â¿Â¿
 Â¿Â¿Â¿Â¿Â¿Â¿ Â¿Â¿Â¿Â¿ABS
 Â¿Â¿Â¿Â¿ Â¿Â¿Â¿Â¿ 16Â¿Â¿Â¿ 20Â¿
 Â¿Â¿Â¿Â¿Â¿Â¿Â¿Â¿ Â¿Â¿Â¿Â¿Â¿Â¿Â¿
 Â¿Â¿Â¿/Â¿Â¿Â¿Â¿Â¿Â¿Â¿Â¿Â¿Â¿/2Â¿Â¿Â¿

ホイールハブ

Â¿Â¿Â¿Â¿/Â¿Â¿Â¿Â¿Â¿Â¿Â¿Â¿
 Â¿Â¿Â¿Â¿/Â¿Â¿Â¿Â¿Â¿Â¿Â¿Â¿
 Â¿Â¿Â¿
 QRM+
 FTS-LÂ¿Â¿Â¿Â¿

ホイールの重み

ホイール重量 (クイックリリー
 スおよびクリンチャー/チュー
 ブラーを除く) (g) : 930