

参照ホイール

R17901 Crossroc XL 26Rr WTS

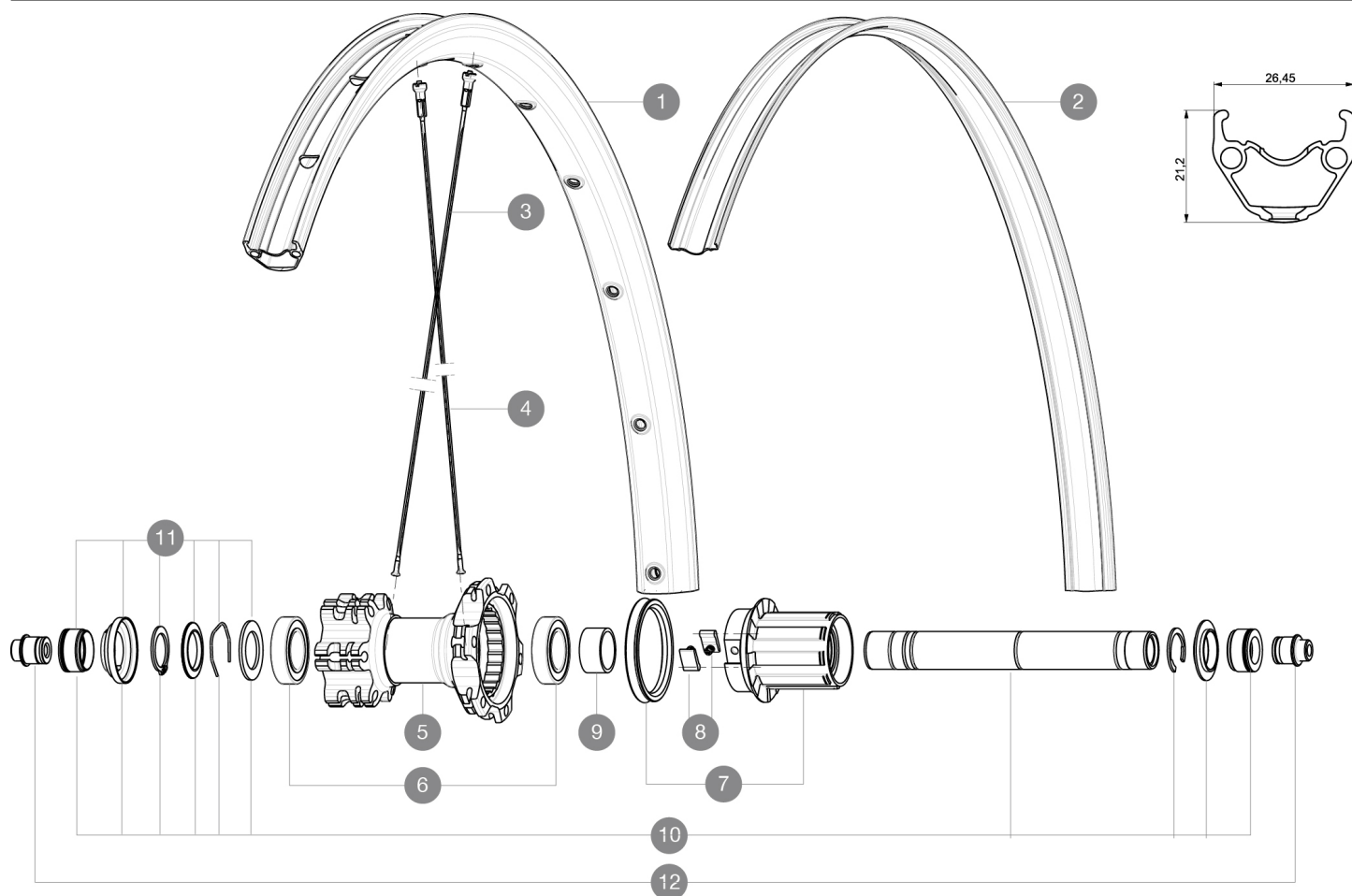

RIMS



ÁÒÒÃÒ«ÃÒÒÇ©'Á%ÒÏ¼ÒMMÏ¼ÒÏ¼Ò6.5 :

1	V2311315	KIT FRONT/REAR RIM CROSSROC XL 26"
2	V2170101	UST rim strip 26 - 21C

SPOKES

3	36675201	12 SPOKES FRONT/OPP DRIVE SIDE CROSSROC 263mm
4	36675301	12 SPOKES DRIVE SIDE CROSSROC 261mm

HUB SHELLS

5	N/A	HUB BODY
6	M40076	HUB BEARINGS 17x30x7 6903 x 2
7	35126301	TS-2 FREEWHEEL BODY + SEAL 2013 (NO PAWLS) - while stock las
8	99610601	ITS4 PAWLS KIT
9	35124501	SET OF 3 REAR AXLE/FREEWHEEL BODY SPACERS
10	V2371201	KIT REAR QRM AXLE 135-142 / BOOST 148mm
11	V2370401	REAR AUTO ADJUST.PLAY KIT 12MM AXLE

ADAPTERS

12	30873101	2 REAR REDUCERS 12/9,5mm 2012 ITS4 HUB
	32965001	ADAPTER Rr 12x142mm Elite/CRide MTB (Rd)

MAVIC Crossroc XL WTS

付属品

Tubeless rim tape	
UST valve and accessories	
Valve reducer	
User guide	

Specifications

リム

- Material : S6000 Aluminum
- Joint : pinned
- Drilling : traditional with H2 reinforcement
- Disc brake specific profile
- Valve hole diameter : 8,5 mm with pop off reducer
- Tyre : UST Tubeless and tubetype
- Internal width : 21 mm
- ETRTO size 26" : 559x21C
- ETRTO size 27.5" : 584x21C
- ETRTO size 29" : 622x21C
- Recommended tyre sizes : 2.0 to 2.5

スポーク

- Material : steel
- Shape : straight pull, bladed, double butted
- Nipples : brass, ABS
- Count : 24 front and rear
- Lacing : front and rear crossed 2

ホイールハブ

- Front and rear bodies : aluminum
- Axle material : aluminum
- Sealed cartridge bearings
- Freewheel : TS-2 alloy
- Shimano 11 speeds compatible
- XD Compatible (XX1-X01) with optionnal kit

ホイールの重み

- ホイール重量 (クイックリリースおよびクリンチャー/チューブラーを除く) (g) :
- Weight Rear 26": 985
 - Weight Rear 27.5": 1015
 - Weight Rear 29": 1060