

ASTM CATEGORY 4 : offroad with jumps less than 122cm

For a longer longevity of the wheel, Mavic recommends that the total weight supported by the wheels doesn't exceed 120kg, bike included

## 参照ホイール

R77801 XmaxXLProLtd27.5Rr142WTS

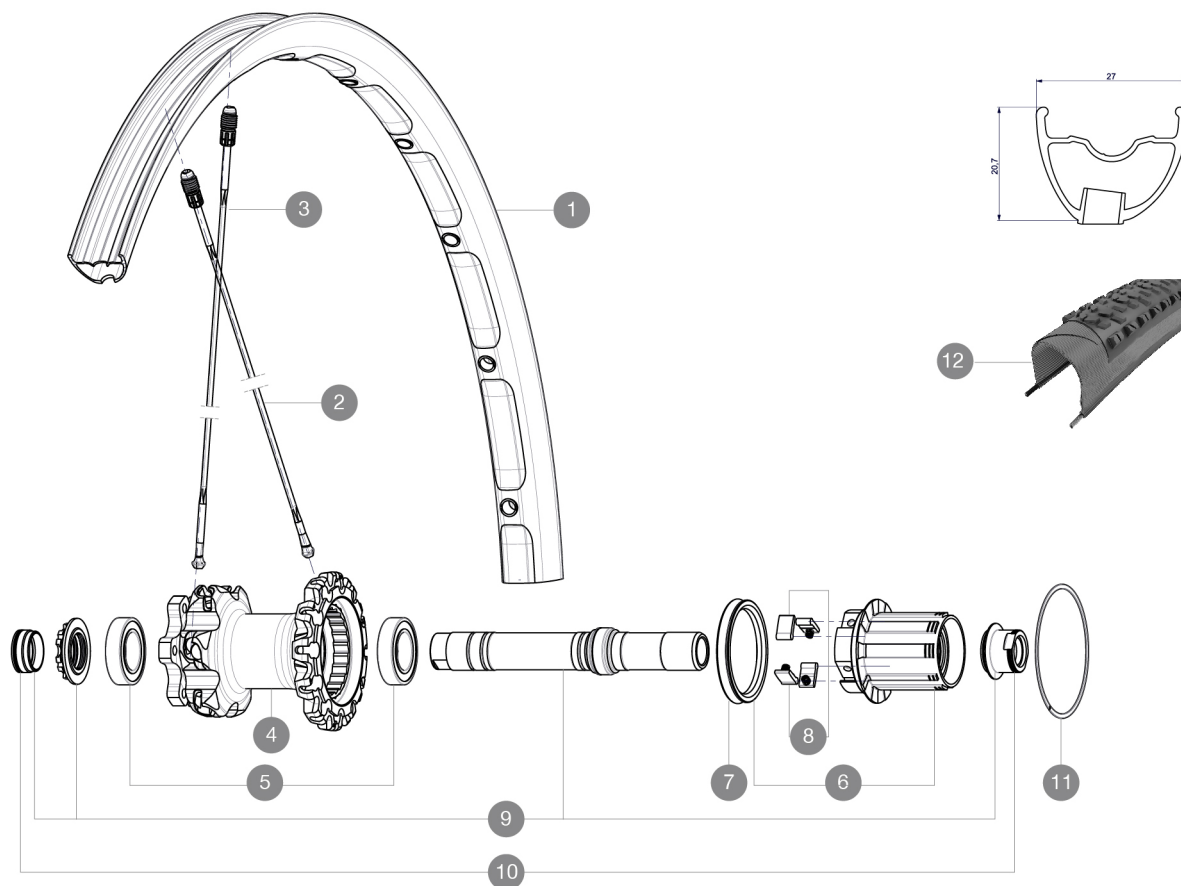

## RIMS



バルブ穴径 (MM) : 6,5 :

1	V2314013	KIT REAR RIM CROSSMAX XL PRO LIMITED 27.5"
---	----------	--

## SPOKES

2	36675101	"10 SPOKES DRIVE SIDE CROSSMAX SLR/ENDURO 650b/27,5"
2	V2383301	"12 SPOKES DRIVE SIDE CROSSMAX SLR/ENDURO 650b/27,5"
3	36674901	"12 SPOKES FRONT CROSSMAX SLR/ENDURO 650b/27,5" 274mm"

## HUB SHELLS

4	N/A	HUB BODY
5	M40076	HUB BEARINGS 17x30x7 6903 x 2
6	35126001	ITS-4 FREEWHEEL BODY + SEAL 2013 (WITHOUT PAWLS)
7	99610701	ITS4 SEAL
8	99610601	ITS4 PAWLS KIT
9	30870401	REAR AXLE KIT ITS4 135mm D6T/DCL 2012
11	30871801	ELASTIC RING 56mm diam.

## ADAPTERS

10	30872201	FORK REST ITS-4 135mm REAR AXLE > 2012
----	----------	--



# Crossmax XL Pro Ltd 27.5

## 付属品

2 bottles of Mavic Sealant	
UST valve and accessories	
Front 15 mm adapters	
Rear 12x142mm adapters	
User guide	

## Specifications

### リム

- Drilling : Fore
- Disc brake specific profile
- Weight reduction : ISM
- Tyre : UST Tubeless and tubetype
- Internal width : 23 mm
- ETRTO size 27.5" : 584x23C
- ETRTO recommended tyre sizes : 37mm to 76mm (1.5" to 3.0")

### スポーク

- Material : Zicral
- Shape : straight pull, bladed
- Count : 24 front and rear
- Lacing : front crossed 2, rear Isopulse

### ホイールハブ

- Body : aluminum
- Axle material : aluminum
- Adjustable sealed cartridge bearings
- Freewheel : ITS-4 alloy
- Shimano 11 speeds compatible
- Sram XD Compatible (XX1-X01) with optionnal kit

### ホイールの重み

ホイール重量 ( クイックリリース  
スおよびクリンチャー/チュー  
ブラーを除く ) ( g ) : 895