

ASTM CATEGORY 1 : road only

For a longer longevity of the wheel, Mavic recommends that the total weight supported by the wheels doesn't exceed 120kg, bike included

参照ホイール

R78001 CC40C Rr 16

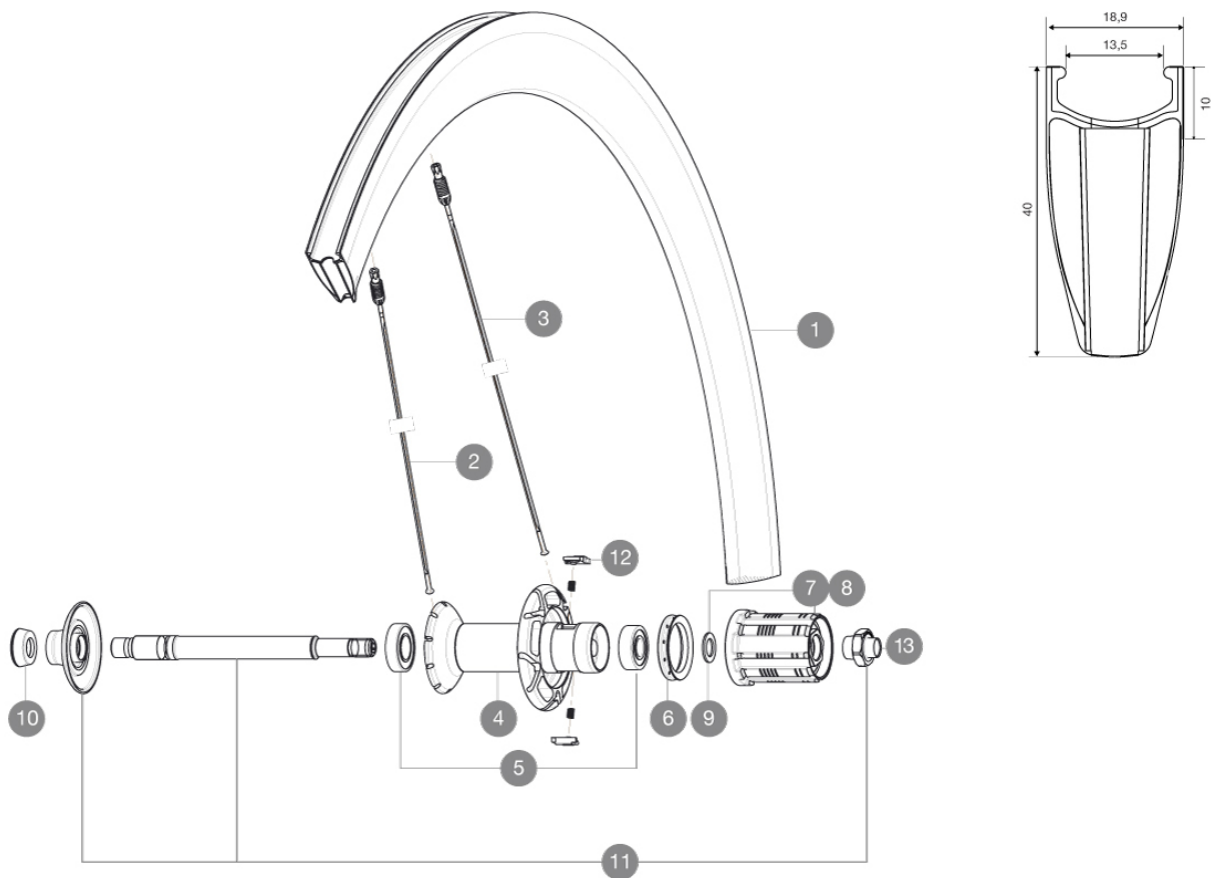

RIMS



&NBSP;:

1	32978213	REAR RIM CC 40 C
---	----------	------------------

SPOKES

2	V3664201	KIT 12 FRT/NDS STAINLESS SPOKE CC40 C 277mm
2	32979001	KIT 10 AERO FT/NDS CC 40 C BLACK SPOKE 277mm - while stock I
3	V3664101	KIT 12 DRIVE SIDE STAINLESS SPOKE CC40 C 275mm
3	32978901	KIT 10 AERO DS CC 40 C BLACK SPOKE 275mm - while stock last

HUB SHELLS

4	N/A	HUB BODY
5	33000001	REAR HUB B9+6901 BEARINGS 2013
6	99500001	FTSL/FTSX FREEHUB BODY SEAL
7	30871101	FTS-L FREEWHEEL BODY HG11 2013 (8 or 9mm axle compatible)
8	30871201	FTS-L FREEWHEEL BODY ED11 2013 (8 or 9mm axle compatible)
9	30872801	SET OF 3 INTERNAL SILVER SPACERS 9mm FTS-L 2013
11	V2250301	KIT REAR AXLE AERO HUB CXR/CC40/CC SLS/CC SLE/COSMIC
12	M40578	PRO CAR FTSL PAWLS KIT (ROAD WHEELS)
13	V2373101	KIT NUT FOR ROAD ALLOY THROUGH AXLE 9mm

ADAPTERS

10	35117301	FRONT OR REAR FORK REST KIT R-SYS 2013
----	----------	--



Cosmic Carbone 40 C

付属品

BR601 quick releases	
Carbon brake pads	
Multifonction adjustment wrench	
User guide	

Specifications

リム

- Material : 3K carbon fibers with aluminum cooling system
- Height : 40 mm
- Drilling : co-molded Fore drilled inserts
- Brake track : carbon
- Brake track : carbon with TgMAX technology
- Valve hole diameter : 6.5 mm
- Tyre : clincher
- ETRTO size : 622x13C
- Recommended tyre sizes : 21 to 28 mm

スポーク

- Material : steel
- Shape : straight pull, bladed, double butted
- Nipples : Fore integrated aluminum
- Count : front 16, rear 20
- Lacing : radial front and rear non-drive side, crossed 2 rear drive side

ホイールハブ

- Front and rear bodies : carbon center tube and aluminum flanges
- Axle material : aluminum
- Adjustable sealed cartridge bearings
- Freewheel : FTS-L steel

ホイールの重み

ホイール重量 (クイックリリースおよびクリンチャー/チューブラーを除く) (g) : 875