



Cosmic Pro Carbon Exalith

参照ホイール

R99461	Cos Pro Car Exa 17 Rr Cus	R80701	Cos Pro Car Exa 17 Rr
--------	---------------------------	--------	-----------------------

ASTM CATEGORY 1 : road only
 For a longer longevity of the wheel, Mavic recommends that the total weight supported by the wheels don't exceed 120kg, bike included
 Recommended tyre sizes: 25 to 32 mm
 23mm 8.7 bars - 125 psi, 25mm 7.7 bars - 110 psi
 Max. Pressure: 25mm 7.7 bars - 110 PSI

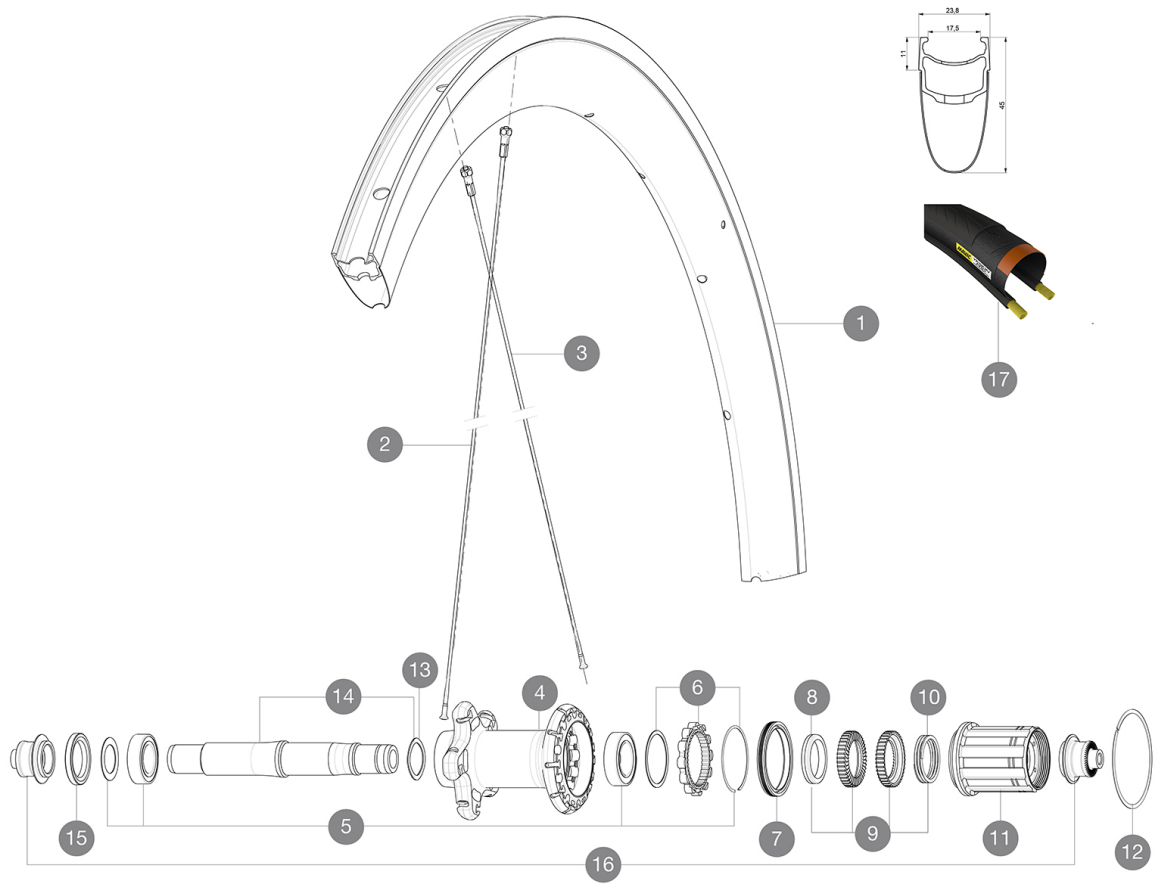

RIMS



&NBSP;:

1	V2407813	KIT REAR RIM COSMIC PRO CARBON EXALITH GRAPHITE
---	----------	---

SPOKES

2	V3663601	KIT 12 NON DRIVE SIDE BUTTED AERO STAINLESS SPOKE 301 +
2	V2274701	RHT 12 NDS BTD AERO SPK 301mm/ALU NIPPLE - while stock last
3	V2274601	KIT 12 DS BTD AERO SPK 277mm/ALU NIPPLE - while stock last
3	V3663501	KIT 12 BUTTED AERO STAINLESS SPOKE 277 + alu nipple + washer

HUB SHELLS

4	N/A	HUB BODY
5	V2560101	KIT ID360 BEARINGS 15/26/7 + 17/28/7
6	V2252701	KIT ID360 INSERT SHAPED EAR LOBE > 2017
7	V2251601	ID360 SEAL + GREASE
8	V2500501	Kit 3 ID360 pad for noise reduction
9	V2251701	ID360 2 RATCHETS + SPRING + GREASE
10	V2251801	KIT 3 ID360 ROAD SPRINGS
11	V3430101	HG11 Freewheel Body ID360
12	V2252201	KIT 2 REAR HUB RETENTION RINGS 48mm
13	V2251501	3 ID360 WAVE WASHERS
14	V2251201	ID360 AXLE UB
15	V2250901	KIT ID360 HUB THREADED CAP for UB model (small)

TYRES

17	37805525	Yksion Pro PowerLink White 25
----	----------	-------------------------------

ADAPTERS

16	B4989401	Rear axle adapters 9mm QR
----	----------	---------------------------



Cosmic Pro Carbon Exalith

付属品

BR301 quick releases (V24 501 01 frt, V24 502 01 rear) 1	
BR301 quick releases (V24 501 01 frt, V24 502 01 rear) 1	
BR301 quick releases (V24 501 01 frt, V24 502 01 rear) 1	
Exalith brake pads (V24 703 01 Shimano/Sram, V24 704 01 Campagnolo) 1	
Exalith brake pads (V24 703 01 Shimano/Sram, V24 704 01 Campagnolo) 1	
Exalith brake pads (V24 703 01 Shimano/Sram, V24 704 01 Campagnolo) 1	
Rim tape	
Rim tape	
Rim tape	
Multifonction adjustment wrench (325 423 01) 1	
Multifonction adjustment wrench (325 423 01) 1	
Multifonction adjustment wrench (325 423 01) 1	
User guide	
User guide	
User guide	

COMPATIBILITY

Freewheel: Shimano/Sram or Campagnolo, convertible to XD-R with optional driver body	
AXL: Shimano/Sram / Campagnolo / XD-R	
AXL: Shimano/Sram / Campagnolo / XD-R	
Front axle: Quick Release only	
Front axle: Quick Release only	
Front axle: Quick Release only	
Rear axle: Quick Release only	
Rear axle: Quick Release only	
Rear axle: Quick Release only	

Specifications

- リム**
- Material : Maxtal and 12K carbon fiber
 - Material : Maxtal and 12K carbon fiber
 - Material : Maxtal and 12K carbon fiber
 - Height : 45 mm
 - Height : 45 mm
 - Height : 45 mm
 - Joint : SUP
 - Joint : SUP
 - Joint : SUP
 - Drilling : traditional
 - Drilling : traditional

- ホイールハブ**
- Front and rear bodies : aluminum
 - Front and rear bodies : aluminum
 - Front and rear bodies : aluminum
 - Axle material : aluminum
 - Axle material : aluminum
 - Axle material : aluminum
 - AXL: Shimano/Sram / Campagnolo / QRM+ / XD-R
 - AXL: Shimano/Sram / Campagnolo / QRM Auto / XD-R
 - Sealed cartridge bearings

- ホイールの重み**
- ホイール重量 (クイックリリースおよびクリンチャーチューブラーを除く) (g) : 925