



Cosmic Pro Carbon

参照ホイール

R99471	Cos Pro Car 17 Rr Custom	R80802	Cos Pro Car 17 Rr White
R80801	Cos Pro Car 17 Rr Black		

ASTM CATEGORY 1 : road only
 For a longer longevity of the wheel, Mavic recommends that the total weight supported by the wheels don't exceed 120kg, bike included
 Recommended tyre sizes: 25 to 32 mm
 23mm 8.7 bars - 125 psi, 25mm 7.7 bars - 110 psi
 Max. Pressure: 25mm 7.7 bars - 110 PSI

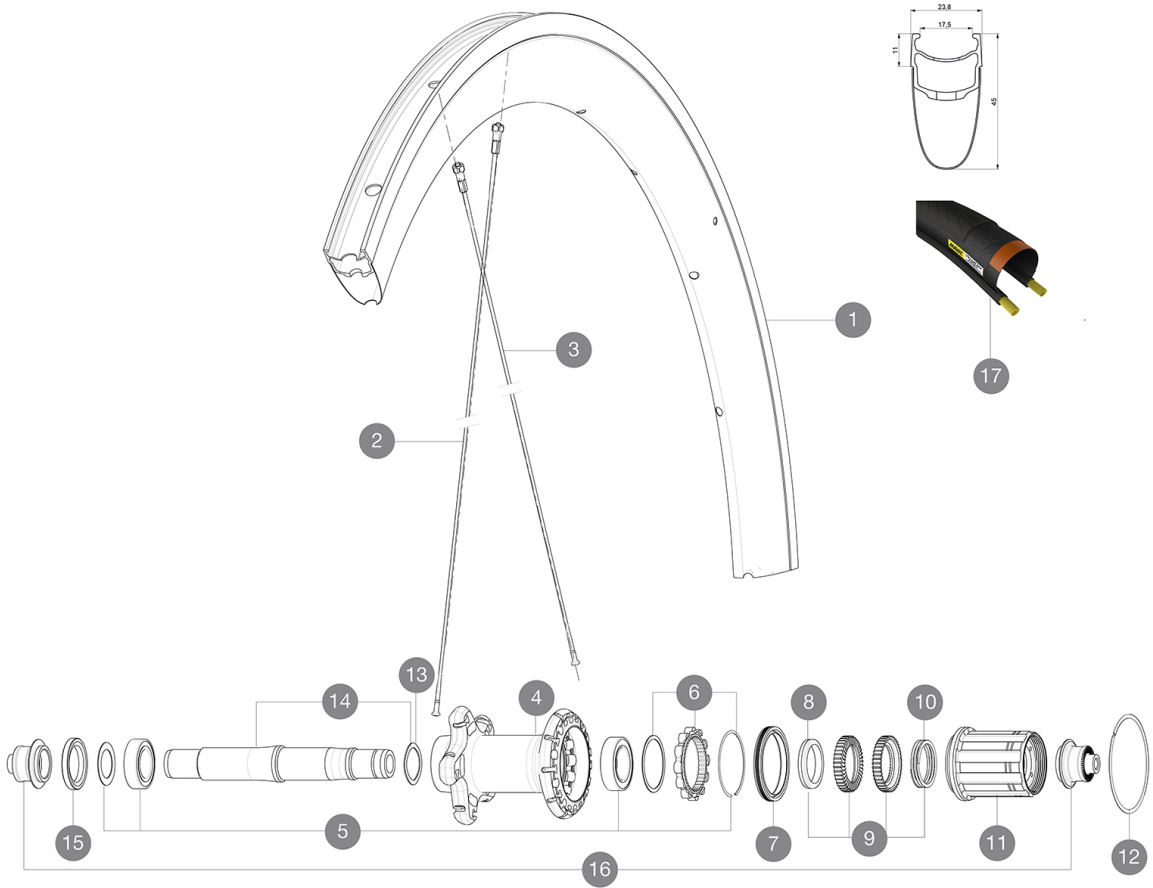

RIMS



&NBSP;:

1	V2407613	KIT REAR RIM COSMIC PRO CARBON UB WHITE - while stock last
1	V4091913	KIT REAR RIM COSMIC PRO CARBON U shaped
1	V2407413	KIT REAR RIM COSMIC PRO CARBON UB GRAPHITE - while stock las

SPOKES

2	V2274701	KIT 12 NDS BTD AERO SPK 301mm/ALU NIPPLE - while stock last
2	V3663601	KIT 12 NON DRIVE SIDE BUTTED AERO STAINLESS SPOKE 301 +
3	V3663501	RIT 12 BUTTED AERO STAINLESS SPOKE 277 + alu nipple + washer
3	V2274601	KIT 12 DS BTD AERO SPK 277mm/ALU NIPPLE - while stock last

HUB SHELLS

4	N/A	HUB BODY
5	V2560401	KIT ID360 2 BEARINGS 17x28x7 + CIRCLIP + WAVED WASHER (QRM
6	V2252701	KIT ID360 INSERT SHAPED EAR LOBE > 2017
7	V2251601	ID360 SEAL + GREASE
8	V2500501	Kit 3 ID360 pad for noise reduction
9	V2251701	ID360 2 RATCHETS + SPRING + GREASE
10	V2251801	KIT 3 ID360 ROAD SPRINGS
11	V3430101	HG11 Freewheel Body ID360
12	V2252201	KIT 2 REAR HUB RETENTION RINGS 48mm
13	V2251501	3 ID360 WAVE WASHERS

14	V2251201	ID360 AXLE UB
15	V2250901	KIT ID360 HUB THREADED CAP for UB model (small)

TYRES

17	37805525	Yksion Pro PowerLink White 25
----	----------	-------------------------------

ADAPTERS

16	B4989401	Rear axle adapters 9mm QR
----	----------	---------------------------



Cosmic Pro Carbon

付属品

BR301 quick releases (V24 501 01 frt, V24 502 01 rear) 1	
BR301 quick releases (V24 501 01 frt, V24 502 01 rear) 1	
BR301 quick releases (V24 501 01 frt, V24 502 01 rear) 1	
Rim tape	
Rim tape	
Rim tape	
Multifunction adjustment wrench (325 423 01) 1	
Multifunction adjustment wrench (325 423 01) 1	
Multifunction adjustment wrench (325 423 01) 1	
User guide	
User guide	
User guide	

COMPATIBILITY

Freewheel: Shimano/Sram, convertible to Campagnolo and XD-R with optional driver bodies	
Freewheel: Shimano/Sram, convertible to Campagnolo and XD-R with optional driver bodies	
Freewheel: Shimano/Sram, convertible to Campagnolo and XD-R with optional driver bodies	
Front axle: Quick Release only	
Front axle: Quick Release only	
Front axle: Quick Release only	
Rear axle: Quick Release only	
Rear axle: Quick Release only	
Rear axle: Quick Release only	

Specifications

- リム**
- Material : Maxtal and 12K carbon fiber
 - Material : Maxtal and 12K carbon fiber
 - Material : Maxtal and 12K carbon fiber
 - Height : 45 mm
 - Height : 45 mm
 - Height : 45 mm
 - Joint : SUP
 - Joint : SUP
 - Joint : SUP
 - Drilling : traditional
 - Drilling : traditional
 - Drilling : traditional
 - Brake track : UB Control
 - Brake track : UB Control
 - Brake track : UB Control
 - Weight reduction : ISM
 - Weight reduction : ISM
 - Weight reduction : ISM
 - Valve hole diameter : 6.5 mm
 - Valve hole diameter : 6.5 mm
 - Valve hole diameter : 6.5 mm
 - Tyre : clincher
 - Tyre : clincher
 - Tyre : clincher
 - Internal width : 17 mm
 - Internal width : 17 mm
 - Internal width : 17 mm
 - ETRTO size : 622x17C

- ホイールハブ**
- Front and rear bodies : aluminum
 - Front and rear bodies : aluminum
 - Front and rear bodies : aluminum
 - Axle material : aluminum
 - Axle material : aluminum
 - Axle material : aluminum
 - Sealed cartridge bearings
 - Sealed cartridge bearings
 - Sealed cartridge bearings
 - Freewheel : Instant Drive 360
 - Freewheel : Instant Drive 360
 - Freewheel : Instant Drive 360

ホイールの重み
ホイール重量 (クイックリリー
スおよびクリンチャー/チュー
ブラーを除く) (g) : 925

- VERSIONS**
- Color : Black only
 - Color : Black only