

ASTM CATEGORY 2 : road and offroad with jumps less than 15cm
 For a longer longevity of the wheel, Mavic recommends that the total weight supported by the wheels don't exceed 120kg, bike included
 Recommended tyre sizes: 25 to 32 mm
 23mm 8.7 bars - 125 psi, 25mm 7.7 bars - 110 psi
 Max. Pressure: 25mm 7.7 bars - 110 PSI

参照ホイール

R93201 ComProCarSITDCLR12x142

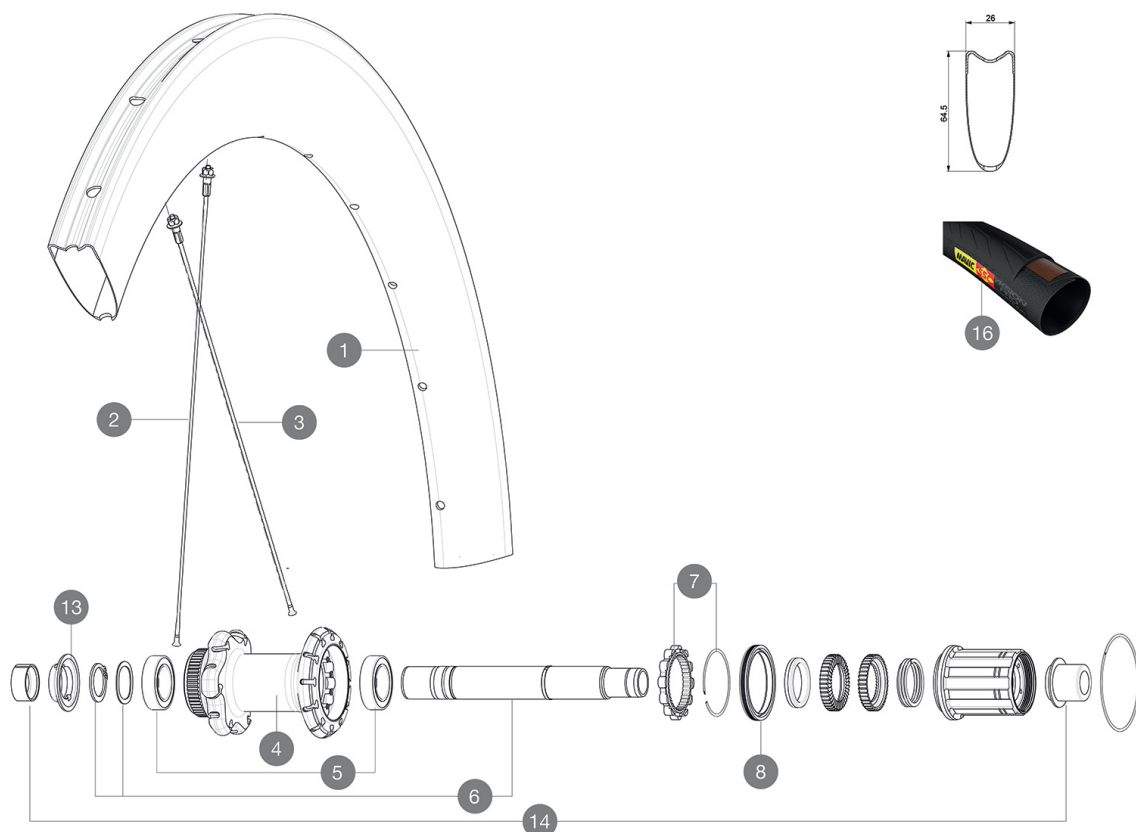

RIMS



&NBSP;:

1	V2731513	KIT REAR RIM COMETE PRO CARBON SL T DISC
---	----------	--

SPOKES

2	V2278601	KIT 12 FT/NDS BUTTED AERO SPOKE 253mm - while stock last
2	V3662301	KIT 12 FRT/NDS COMETE PRO CARB SL T/UST D & DS COSMIC
3	V2278701	KIT 12 DS BUTTED AERO SPOKE 236mm - while stock last
3	V3662401	KIT 12 DS BUTTED AERO STAINLESS SPOKE 236 + alu nipp.+ wash.
3	V2278501	KIT 1 FT 247/FT 253/DS 236 COMETE PRO CARB SL T D SPK

HUB SHELLS

4	N/A	HUB BODY
5	V2560401	KIT ID360 2 BEARINGS 17x28x7 + CIRCLIP + WAVED WASHER (QRM
6	V2252901	KIT ID360 CENTER LOCK 135/142mm AXLE WITH CIRCLIP
7	V2252701	KIT ID360 INSERT SHAPED EAR LOBE > 2017
8	V2251601	ID360 SEAL + GREASE
9	V2251701	ID360 2 RATCHETS + SPRING + GREASE
10	V2500501	Kit 3 ID360 pad for noise reduction
11	V2251801	KIT 3 ID360 ROAD SPRINGS
12	V3430101	HG11 Freewheel Body ID360
15	V2252201	KIT 2 REAR HUB RETENTION RINGS 48mm

TYRES

16	37804625	Yksion Pro PowerLink Tubular SSC 25
----	----------	-------------------------------------

ADAPTERS

14	V2510701	ID360 EVO REAR AXLE ADAPTERS 12x142mm DCL & D6T
	V2510901	ID360 EVO REAR AXLE ADAPTERS 12x135mm DCL & D6T
	V2510801	ID360 EVO REAR AXLE ADAPTERS 9x135mm DCL & D6T



Comete Pro Carbon SL T Disc

付属品

Front 12 mm adapters (B4104201) 1	
Rear 12x142mm adapters for Instant Drive 360 (B49 896 01 for ID360 6T, B49 899 01 for ID360 CL) 1	
Valve extender (118 952 01) 1	
Valve extender (118 952 01) 1	
Specific disc bolts (308 719 01) Pack of 6	
Specific disc bolts (308 719 01) Pack of 6	
Multifunction adjustment wrench (325 423 01) 1	
Multifunction adjustment wrench (325 423 01) 1	
User guide	
User guide	

COMPATIBILITY

Freewheel: Shimano/Sram or Campagnolo, convertible to XD-R with optional driver body	
Front axle: convertible from 12mm thru axle to quick release or 15mm thru axle with optional adapters	
Front axle: convertible from 12mm thru axle to quick release or 15mm thru axle with optional adapters	
Rear axle: 12mm thru axle, convertible to Quick Release with optional adapters	
Rear axle: 12mm thru axle, convertible to Quick Release with optional adapters	

Specifications

- リム
- Material : 3K carbon fibers
 - Material : 3K carbon fibers
 - Height : 64mm
 - Height : 64mm
 - Drilling : traditional
 - Drilling : traditional
 - Disc brake specific profile
 - Disc brake specific profile
 - Valve hole diameter : 6.5 mm
 - Valve hole diameter : 6.5 mm
 - Tyre : tubular
 - Tyre : tubular
 - ETRTO size : 28" tubular
 - ETRTO size : 28" tubular

- スポーク
- Material : steel
 - Material : steel
 - Shape : straight pull, bladed, double butted
 - Nipples : aluminum, ABS
 - Nipples : aluminum, ABS
 - Count : 24 front and rear
 - Count : 24 front and rear
 - Lacing : front crossed 2, rear Isopulse
 - Lacing : front crossed 2, rear Isopulse

- ホイールハブ
- Front and rear bodies : aluminum
 - Front and rear bodies : aluminum
 - Axle material : aluminum
 - Axle material : aluminum
 - Sealed cartridge bearings
 - Freewheel : Instant Drive 360
 - Freewheel : Instant Drive 360
 - Front : Quick release, 12 and 15mm through axle compatible
 - Rear : convertible to 12mm through axle (135 and 142)

- VERSIONS
- Color : Black only
 - Color : Black only
 - Disc standard : Center Lock(R) only
 - Disc standard : Center Lock(R) only

- ホイールの重み
- ホイール重量 (クイックリリースおよびクリンチャーチューブラーを除く) (g) : 865