

MAVIC E-XA Elite

ASTM CATEGORY 3 : offroad with jumps less than 61cm

Recommended tyre sizes: 46 to 64 mm (1.8" to 2.5")

参照ホイール

R22571 E-Xa Elite 27,5 Rr Bst XD R22231 E-Xa Elite 27.5 Bst Rr

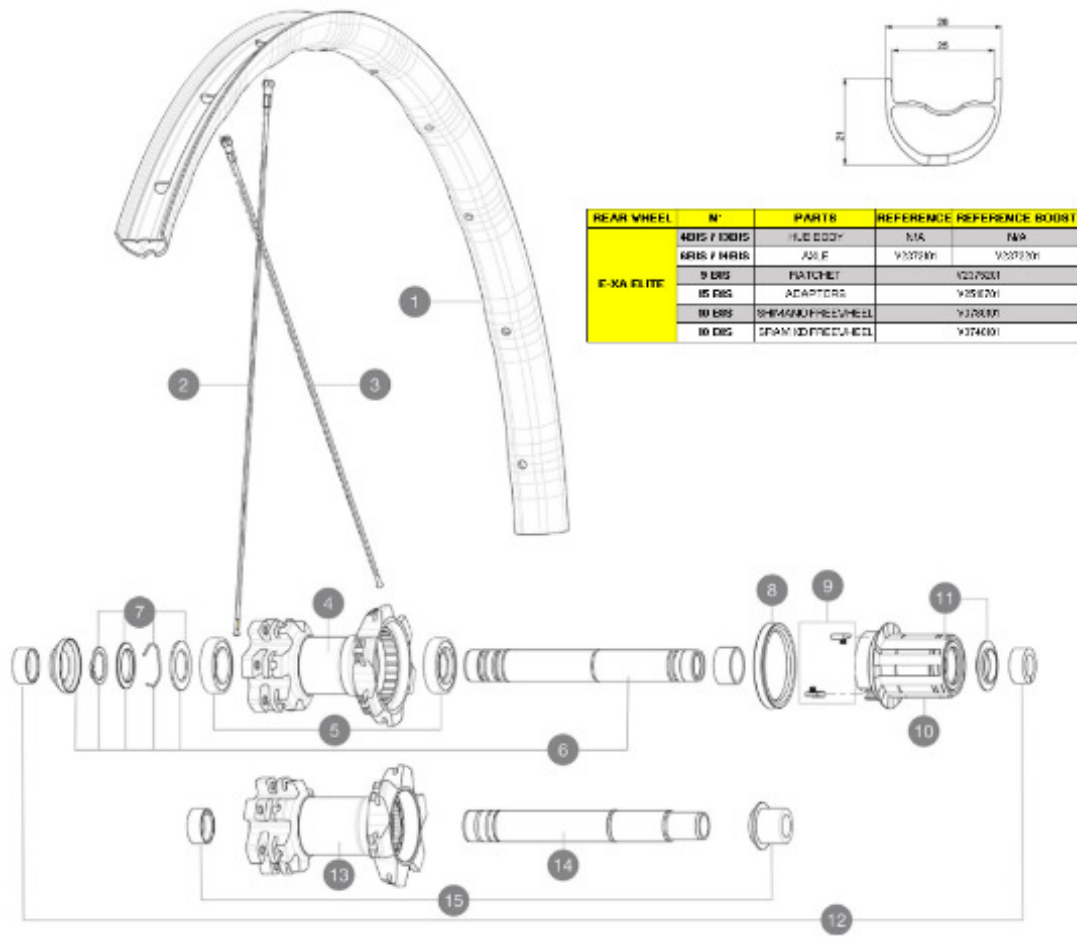

| REAR WHEEL | N° | PARTS | REFERENCE | REFERENCE BOOST |
|-------------------|----|----------------------|-----------|-----------------|
| 40RS / 40RIS | | HUB BODY | N/A | N/A |
| 6RS / 6RIS | | AXLE | V378701 | V378701 |
| E-XA ELITE | | | | |
| 9 RS | | RATCHET | V2375201 | |
| 15 RS | | ADAPTERS | V2510701 | |
| 10 RS | | SPAM MOUNT FREEWHEEL | V3740101 | |
| 10 RS | | SPAM MOUNT FREEWHEEL | V3740101 | |

RIMS



&NBSP;:

| | | |
|---|----------------------|--|
| 1 | V2980115 V2700101 | KIT FRONT/REAR RIM XA ELITE 27,5" 25mm BLACK TUBELESS STRA Type 28mm for 25 to 27mm wide rims |
|---|----------------------|--|

SPOKES

| | | |
|---|----------|---|
| 2 | V2382401 | 12 FRT + REAR NON-DRIVE SIDE SPOKES 279mm CROSSRIDE |
| 3 | V2385701 | KIT 12 REAR DRIVE SIDE SPOKES MTB L1 27,5" |

HUB SHELLS

| | | |
|----|----------|--|
| 4 | N/A | HUB BODY |
| | N/A | HUB BODY |
| 5 | M40076 | HUB BEARINGS 17x30x7 6903 x 2 |
| 6 | V2371701 | KIT AXLE 135/142mm ITS4 QRM AUTO |
| | V2372101 | KIT ID360 135/142 D6T AXLE WITH CLIP |
| 7 | V2370401 | REAR AUTO ADJUST.PLAY KIT 12MM AXLE |
| 8 | 99610701 | ITS4 SEAL |
| 9 | 99610601 | ITS4 PAWLS KIT |
| | V2375201 | KIT ID360 24 TEETH 2 RATCHET + MTB SPRING + PAD (specific) |
| 10 | V3610101 | HG MTB FREEWHEEL BODY ITS4 QRM AUTO |
| | V3740101 | XD MTB Freewheel Body ID360 |
| | V3780101 | HG9 Alloy MTB Freewheel Body ID360 |
| 13 | N/A | HUB BODY |
| | N/A | HUB BODY |
| 14 | V2371601 | KIT AXLE 148mm ITS4 QRM AUTO |

V2372201 KIT ID360 148 D6T AXLE WITH CLIP

ADAPTERS

| | | |
|----|----------|---|
| 12 | 32965001 | ADAPTER Rr 12x142mm Elite/CRide MTB (Rd) |
| 15 | V2510701 | ID360 EVO REAR AXLE ADAPTERS 12x142mm DCL & D6T |
| | V2510801 | ID360 EVO REAR AXLE ADAPTERS 9x135mm DCL & D6T |



E-XA Elite

付属品

| | |
|---------------------|--|
| UST (129 838 01) | |
| | |
| | |

COMPATIBILITY

| | |
|-------------------------------|--|
| Freewheel: Shimano/Sram or XD | |
|-------------------------------|--|

Specifications

リム

- S6000 SUP
- ISM 4D
- 6.5 mm
- UST
- 25 mm
- ETRTO size 27.5" : 584x25ss
- ETRTO size 29" : 622x25ss
- Boost only (front 110, rear 148)

スポーク

- 24
- 2A

ホイールハブ

- ITS-4 QRM Auto alloy

VERSIONS

- Hub width : Boost only (front 110, rear 148)

ホイールの重み

- Weight Rear 27.5": 945
- Weight Rear 29": 985