



AKSIUM

参照ホイール

R23241 AKSIUM RB 700 QR M11

23mm -
8Bar/115PSI
ASTM A1011 : 1
120
25 32mm
2
Maximum tyre pressure: 7.5bar/108PSI with a 23mm tyre - 4.6bar/67PSI with a 52mm tyre
23mm 8.7 bars - 125 psi, 25mm 7.7 bars - 110 psi
5Bar/72PSI

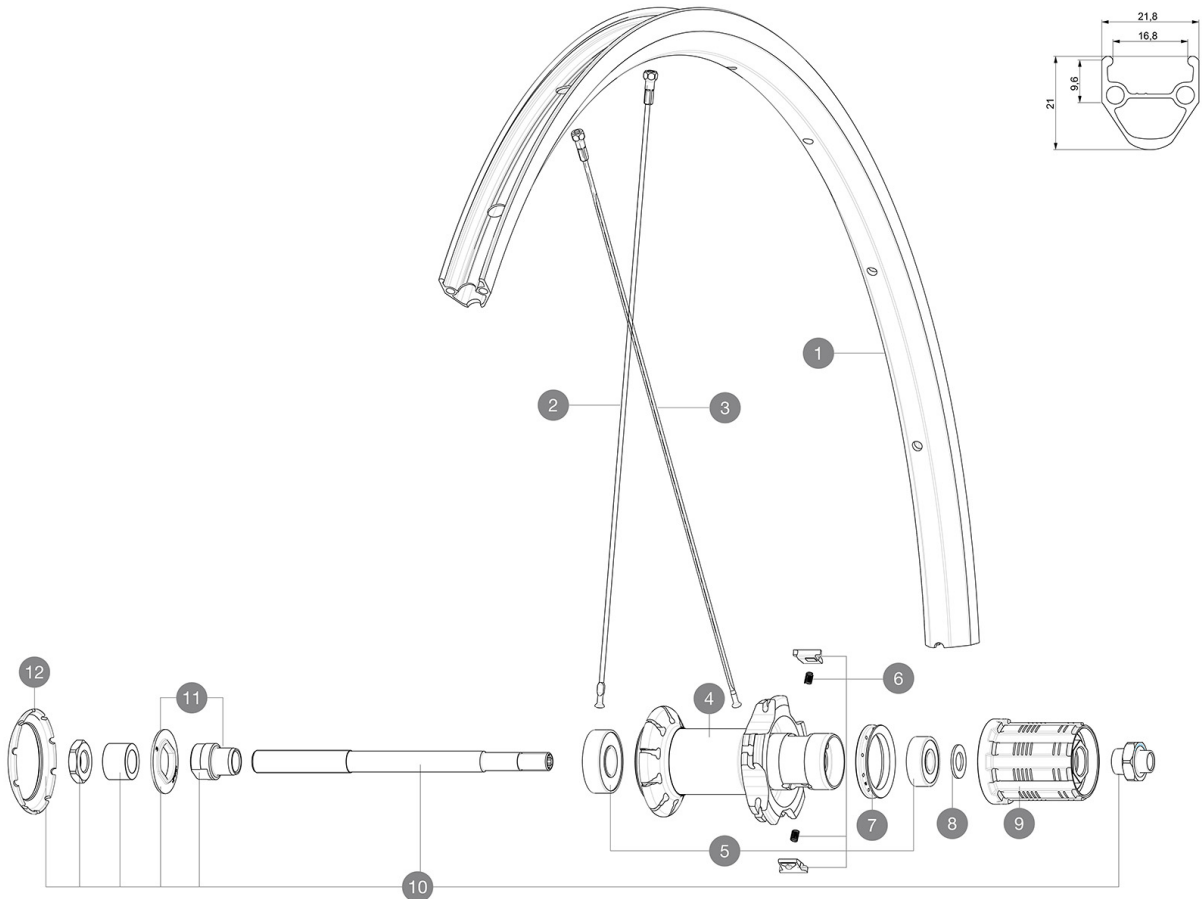

RIMS



&NBSP;:

1	jantearrouteub	REAR ROAD UB RIM
---	----------------	------------------

SPOKES

2	V2272701	FRONT & REAR NON DRIVE SIDE ROUND SPOKE AKSIUM 283mm
3	V3661501	KIT 19 SPOKS AKSIUM 19 FLAT SPOKE 301mm + nipples

HUB SHELLS

5	M40660	REAR HUB 608+6001 BEARINGS
6	M40578	FTSL PAWLS KIT (ROAD WHEELS)
7	99500001	FTSL/FTSX FREEHUB BODY SEAL
8	M40067	10 SPACERS FRW/HUB BODY
9	30871101	FTS-L FREEWHEEL BODY HG11 2013 (8 or 9mm axle compatible)
10	99603901	REAR AXLE KSYRIUM EQUIPE 08
11	99603801	SHORT EXPENSIBLE BEARING SUPPORTS > 2008
12	12034401	KIT 3 HUB CAPS AERO 10 SLOTS BLACK

