

参照ホイール

ASTM A52100 2 : 23mm-
 6.75Bar/97PSI
 62mm-
 3.8Bar/55PSI

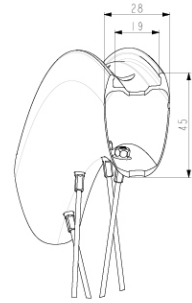

RIMS

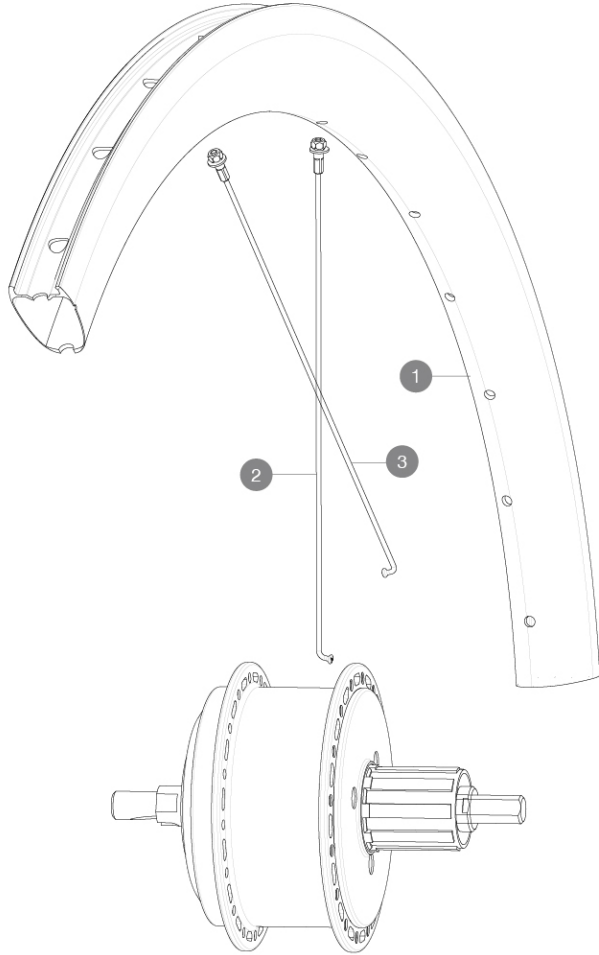

&NBSP;:

1	V4093713 V2620101	Kit Rear rim Cosmic SL 45 Disc EBM/ CPC UST Disc EBM UST RIM TAPE 25mm (for 21-24mm wide rim)
---	----------------------	--

SPOKES

2	V3668001	KIT 16 NON DRIVE SIDE J-bent Spoke 230mm COSMIC PRO CARBON
3	V3667901	KIT 16 DRIVE SIDE J-bent Spoke 228mm COSMIC PRO CARBON UST D

付属品

Table with 2 columns and 10 rows listing accessories like MAVIC, QR, and UST parts.

COMPATIBILITY

Table with 2 columns and 2 rows detailing compatibility for various models and components.

Specifications

リム

Technical specifications for the rim, including weight, width, and compatibility details.

スポーク

Technical specifications for the spokes, including weight and material details.

ホイールハブ

Technical specifications for the wheel hub, including weight and dimensions.

ホイールの重み