

参照ホイール

æ□□á°□á□¿á□#á□#á□µá□#á□°í¼□á' 23mm-
æ□□á#§ç°æ°□á□§6.75Bar/97PSI
ASTMè;□æ¼á□«á□□á□'á□°á□¼ 2 : á□-
á□¼á□□+á□,á□£á□'á□□15á□□á□¼á□\$á□@á□°á□□á□á□¼á□□
á□□á□#á□¼á□«á□□é□·æ□□á□já□□á□□á□□á□□é□*è»□á□□
á□«á□□á□□#á□¼á□«á□□á□□á□□ç·□é□□é□□á□□120á□á□-
ä»#á□ á□'á□□á□□á□□á□'á□□æ□'á#
æ□□á#§á□¿á□#á□#á□µá□#á□°í¼□á' 62mm-
æ□□á#§ç°æ°□á□§3.8Bar/55PSI

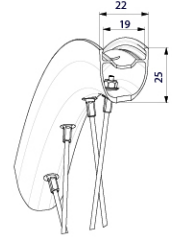

RIMS

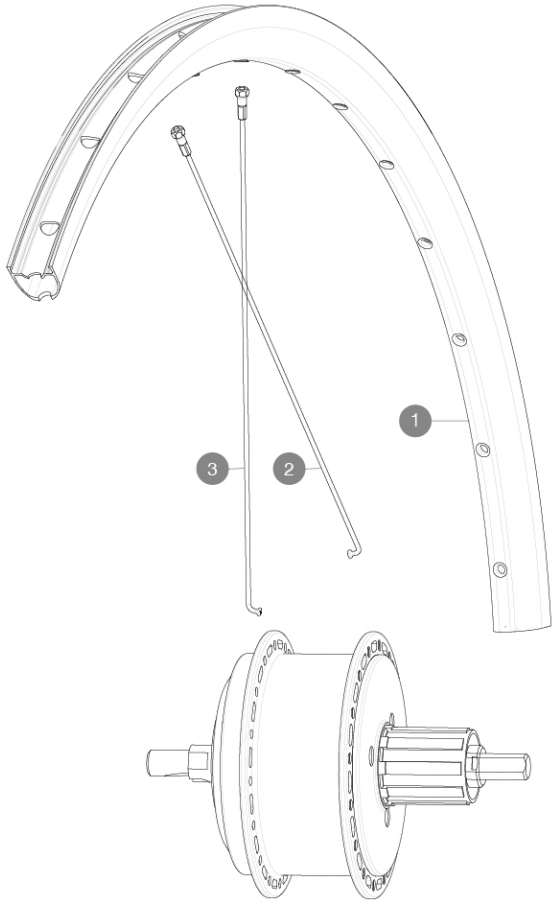

&NBSP;:

1	V4094213	Kit Rear rim Ksyrium S Disc EBM
	V2620101	UST RIM TAPE 25mm (for 21-24mm wide rim)

SPOKES

2	V4164601	Kit 16 Rear Drive Side round Jbent spoke 249 Ksyrium S Disc
3	V4164501	Kit 16 Rear Non Drive Side round Jbent spoke 251 Ksyrium S D

