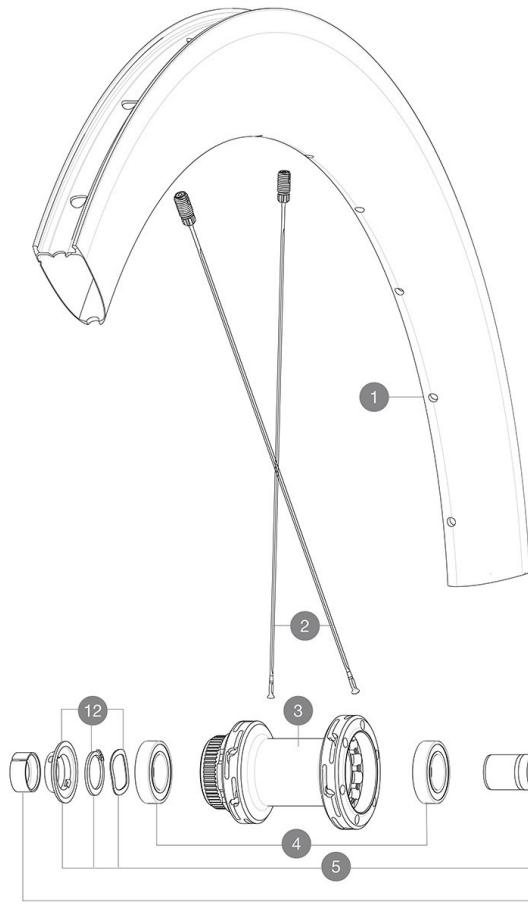
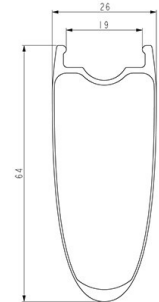

**MAVIC** **COSMIC SL 65 DISC 19mm**

Minimum tyre size: width 23mm - pressure max. 6.75Bar/97PSI  
 Maximum tyre size: width 62mm - pressure max. 3.8Bar/55PSI  
 ASTM category 2 : road and offroad with jumps less than 15cm  
 Maximum weight supported by the wheels: must not exceed 120 kg (bike weight included)

**REFERENCES WHEELS**

Specifications	Maxi target
Frontal run out	0,4mm
Lateral run out	0,5mm
Centring	1,0mm (2x0,5)
Tension daN	73 > 98
FWB side	

**RIMS**

&amp;NBSP;:

<b>1</b>	V00117331	KIT FRT/RR RIM COSMIC SL65 UD
	V3720101	25mm UST Tape for 19 to 22mm Road Rims

**SPOKES**

<b>2</b>	V4162901	Kit 12 Front/Rear Cosmic SL 45 Disc butted stainless spoke 2
----------	----------	--

**HUB SHELLS**

<b>3</b>	N/A	HUB BODY
<b>4</b>	M40076	HUB BEARINGS 17x30x7 6903 x 2
<b>5</b>	V2373401	KIT ID360 135/142 DCL L1 AXLE WITH CLIP
<b>6</b>	V2252701	KIT ID360 INSERT SHAPED EAR LOBE > 2017
<b>7</b>	V2251601	KIT ID360 SEAL + GREASE
<b>8</b>	V2251701	KIT ID360 2 RATCHETS + SPRING + GREASE
<b>9</b>	V2500501	KIT ID360 3 PADS NOISE REDUCING
<b>10</b>	V2251801	KIT 3 ID360 ROAD SPRINGS
<b>11</b>	V3430101	HG11 Freewheel Body ID360
<b>11</b>	V2580101	FREEHUB BODY XD Road ID360
<b>12</b>	V2373001	KIT ADJUST. SYSTEM QRM AUTO ID360 for 17x30x7 bearing

**OPTIONS**

V00063631	Kit ID360 seal version 2 (larger)
V2510801	ID360 V2 RrAxleAdapt19x135
V2510901	ID360 EVO RrAxleAdpt12x135/150

**ADAPTERS**

<b>13</b>	V2510701	ID360V2RrAxleAdapt12x142/148
-----------	----------	------------------------------

**MAVIC** **COSMIC SL 65 DISC 19mm****DELIVERED WITH**

User guide	
Rim tape mounted on wheel	
UST valve not mounted on wheel	
Front axle adapter: 12x100 convertible to 9x100	
Rear axle adapter: 12x142 convertible to 9x135	
Multifunction adjustment wrench with the rear wheel	

**COMPATIBILITY**

Freewheel body: convertible SRAM XD road (kit V2580101 sold separately)	
Freewheel body: convertible SHIMANO HG light road (kit V3850101 sold separately)	
Freewheel body: convertible SHIMANO MS (kit V3990101 sold separately)	
Freewheel body: convertible CAMPAGNOLO ED (kit V3440101 sold separately)	
Freewheel body: convertible CAMPAGNOLO N3W (kit V4270101 sold separately)	
Rear axle adapters: 12x142 convertible to 12x135 (kit V2510901 sold separately)	
Front axle adapters: 12x100 convertible to 9x100 (kit V2680301 included)	
Rear axle adapters: 12x142 convertible to 9x135 (kit V2510801 included)	

**Specifications****RIMS**

- **Material** : 100% Unidirectional carbon fiber
- **Height** : 64 mm
- **Internal width** : 19 mm
- **Drilling** : traditional (front/rear 24 holes)
- **Braking** : disc
- **ETRTO size** : 622x19TC
- **Tire** : UST Tubeless Ready - Use with Mavic Tubeless Tape

**SPOKES**

- **Material** : steel
- **Shape** : straight, extra-flat, constricted, antirot (front and rear)
- **Nipples** : steel, ABS, black
- **Lacing** : crossed 2 (front and rear)

**WHEEL HUB**

- **Body material** : aluminium
- **Body design** : INFINITY
- **Disc standard** : Center Lock® only
- **Axle material** : aluminium
- **Axle size** : front 12x100 / rear 12x142 - Convertible to quick release with adapters (not included)
- **Freewheel technology** : Instant Drive 360
- **Freewheel** : Shimano HG road
- **Bearing technology** : QRM automatic setting - sealed cartridge

**WHEEL WEIGHTS**

984