

REFERENCES WHEELS

R17901 Crossroc XL 26Rr WTS

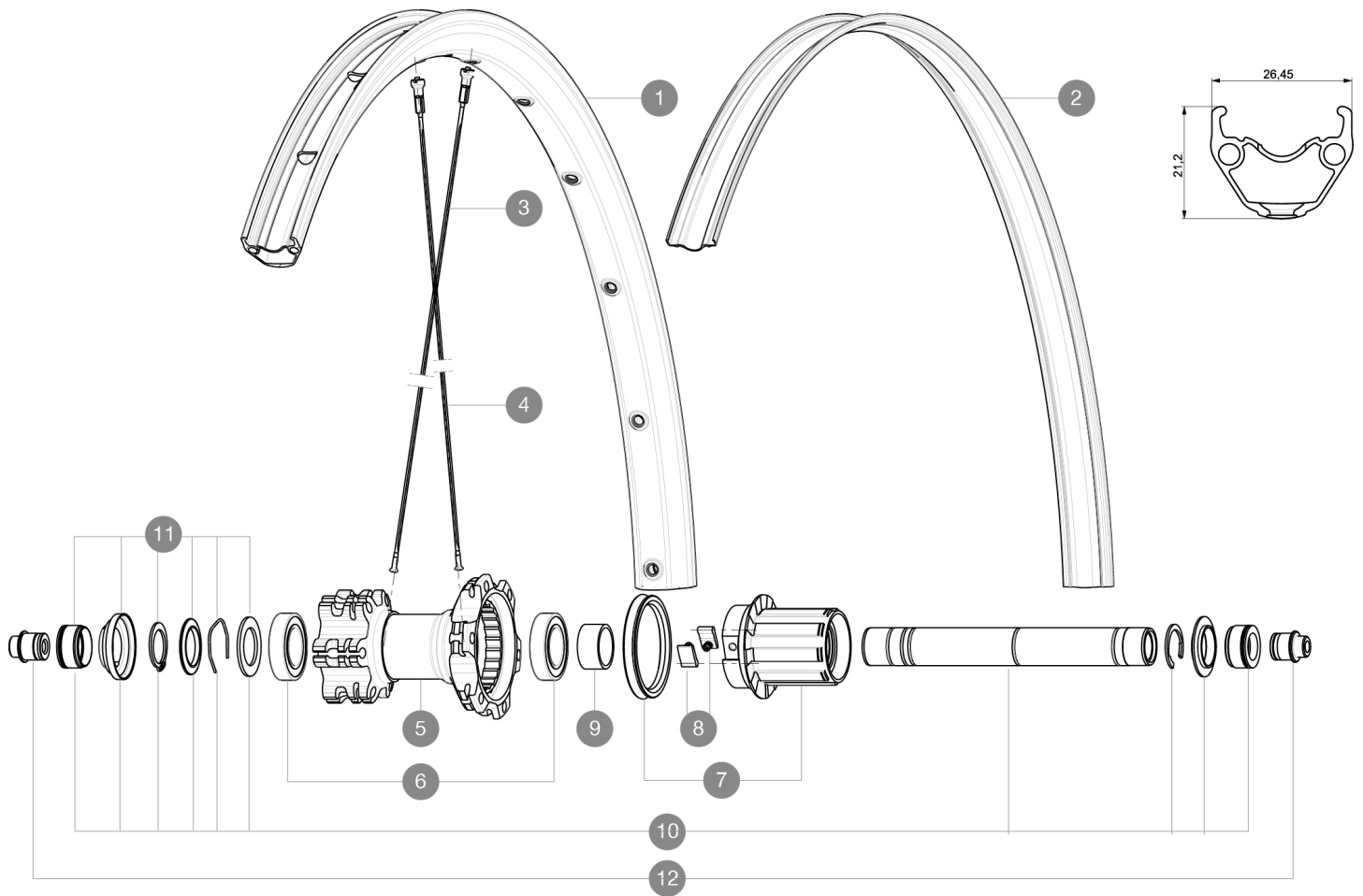

RIMS



VALVE HOLE \bar{A} (MM): 6.5 :

| | | |
|---|----------|------------------------------------|
| 1 | V2311315 | KIT FRONT/REAR RIM CROSSROC XL 26" |
| 2 | V2170101 | UST RIM STRIP 26x21c |

SPOKES

| | | |
|---|----------|--|
| 3 | 36675201 | KIT 12 FT/NDS CROSSROC 26" SPOKE 263mm |
| 4 | 36675301 | KIT 12 DS CROSSROC/CROSSRIDE UST 26" SPK 261mm |

HUB SHELLS

| | | |
|----|----------|--|
| 5 | N/A | HUB BODY |
| 6 | M40076 | HUB BEARINGS 17x30x7 6903 x 2 |
| 7 | 35126301 | TS-2 FREEWHEEL BODY + SEAL 2013 (NO PAWLS) - while stock las |
| 8 | 99610601 | PAWLS KIT FOR ITS-4 (OR TS-2) |
| 9 | 35124501 | SET OF 3 REAR AXLE/FREEWHEEL BODY SPACERS MTB L1 |
| 10 | V2371201 | KIT REAR QRM AXLE 135-142 / BOOST 148mm |
| 11 | V2370401 | KIT REAR AUTO ADJUSTING PLAY 12mm AXLE |

ADAPTERS

| | | |
|----|----------|--|
| 12 | 30873101 | 2 REAR REDUCERS 12/9,5mm 2012 ITS4 HUB |
| | 32965001 | ADAPTER Rr 12x142mm Elite/CRide MTB (Rd) |

MAVIC Crossroc XL WTS

DELIVERED WITH

| | |
|---------------------------|--|
| Tubeless rim tape | |
| UST valve and accessories | |
| Valve reducer | |
| User guide | |

Specifications

RIMS

- **Material** : S6000 Aluminum
- **Joint** : pinned
- **Drilling** : traditional with H2 reinforcement
Disc brake specific profile
- **Valve hole diameter** : 8,5 mm with pop off reducer
- **Tyre** : UST Tubeless and tubetype
- **Internal width** : 21 mm
- **ETRTO size 26"** : 559x21C
- **ETRTO size 27.5"** : 584x21C
- **ETRTO size 29"** : 622x21C
- **Recommended tyre sizes** : 2.0 to 2.5

SPOKES

- **Material** : steel
- **Shape** : straight pull, bladed, double butted
- **Nipples** : brass, ABS
- **Count** : 24 front and rear
- **Lacing** : front and rear crossed 2

WHEEL HUB

- **Front and rear bodies** : aluminum
- **Axle material** : aluminum
Sealed cartridge bearings
- **Freewheel** : TS-2 alloy
Shimano 11 speeds compatible
XD Compatible (XX1-X01) with optionnal kit

WHEEL WEIGHTS

- Wheel weight
- Weight Rear 26": 985
- Weight Rear 27.5": 1015
- Weight Rear 29": 1060