

Recommended weight limit : 120kg  
ETRTO recommended tyre sizes: 35mm to 69mm (1.4" to 2.7")

## REFERENCES WHEELS

R67701 DmaxUlti16Rr 26 12x150

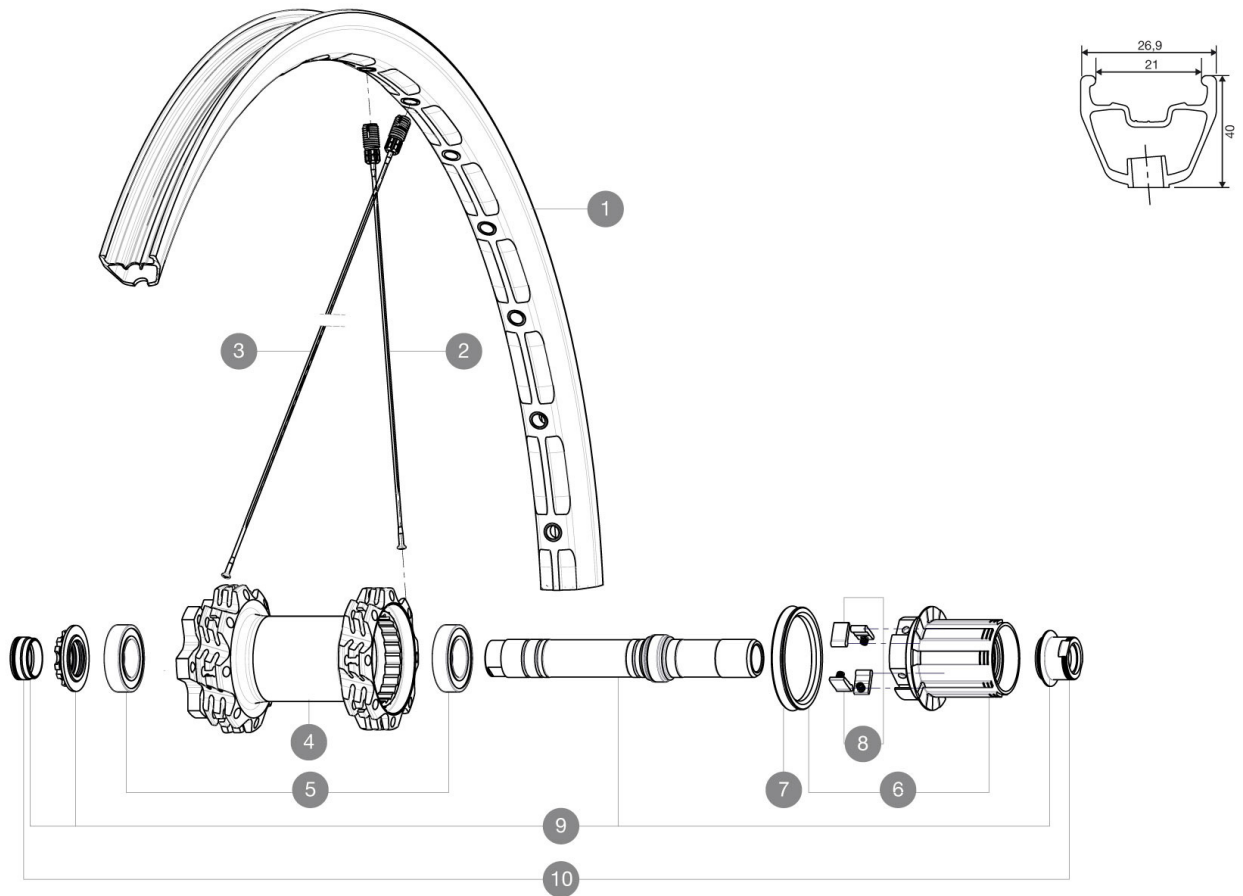

## RIMS



VALVE HOLE  $\bar{A}$  (MM): 6,5 :

1	99691913	KIT REAR RIM DEEMAX ULTIMATE YELLOW
---	----------	-------------------------------------

## SPOKES

2	30864001	KIT 16 NDS M7/7 DEEMAX ULTIMATE 12 SPK 268mm
3	30863901	KIT 16 DS M7/7 DEEMAX ULTIMATE 12 SPK 266mm

## HUB SHELLS

4	N/A	HUB BODY
5	M40076	HUB BEARINGS 17x30x7 6903 x 2
6	35126001	ITS-4 FREEWHEEL BODY + SEAL 2013 (NO PAWLS)
7	99610701	ITS-4 FREEWHEEL SEAL
8	99610601	PAWLS KIT FOR ITS-4 (OR TS-2)
9	30870201	REAR AXLE KIT ITS4 150mm 2012

## ADAPTERS

10	30872201	FRAME SUPPORT ITS-4 135mm REAR AXLE > 2012
----	----------	--------------------------------------------

**DELIVERED WITH**

UST valve and accessories	
Rear QR adapters	
Multifonction adjustment wrench	
User guide	
12x157mm adaptors (308 593 01 for ITS4)	
UST valve and accessories	
Multifonction adjustment wrench	
User guide	
12x157mm adaptors (308 593 01 for ITS4)	

**COMPATIBILITY**

Freewheel: Shimano/Sram, convertible to XD with optional driver body	
Front axle: 20mm or 15mm thru axle with optional adapters	
Rear axle: 12mm thru axle, convertible to Quick Release with optional adapters	

**Specifications**
**RIMS**

- **Material** : Maxtal
  - **Joint** : SUP
  - **Drilling** : Fore
- Disc brake specific profile
- **Weight reduction** : ISM with central spine
  - **Valve hole diameter** : 6.5 mm
  - **Tyre** : UST Tubeless and tubetype
  - **Material** : Mxatal
  - **Internal width** : 21 mm
  - **ETRTO size 26"** : 559x21C
  - **ETRTO recommended tyre sizes** : 35mm to 69mm (1.4" to 2.7")
  - **Joint** : SUP
  - **Drilling** : Fore
- Disc brake specific profile
- **Weight reduction** : ISM with central spine
  - **Valve hole diameter** : 6.5 mm
  - **Tyre** : UST Tubeless and tubetype
  - **Internal width** : 21 mm
  - **ETRTO size 26"** : 559x21C

**SPOKES**

- **Material** : steel
- **Shape** : straight pull, bladed
- **Nipples** : Fore integrated aluminum
- **Count** : front 28, rear 32
- **Material** : steel
- **Lacing** : front and rear crossed 3
- **Shape** : straight pull, bladed
- **Nipples** : Fore integrated aluminum
- **Count** : front 28, rear 32
- **Lacing** : front and rear crossed 3

**WHEEL HUB**

- **Front and rear bodies** : aluminum
  - **Axle material** : aluminum
- Adjustable sealed cartridge bearings
- **Freewheel** : ITS-4 alloy
  - **Front and rear bodies** : aluminum
- Shimano 11 speeds compatible
- **Axle material** : aluminum
- Sram XD Compatible (XX1-X01) with optional kit
- Adjustable sealed cartridge bearings
- **Freewheel** : ITS-4 alloy

**VERSIONS**

- **Color** : Black only
- **Disc standard** : 6 Bolts only

**WHEEL WEIGHTS**

- **Wheel weight**
- **Weight Rear 26"**: 1055
- **Weight Rear 27.5"**: 1085