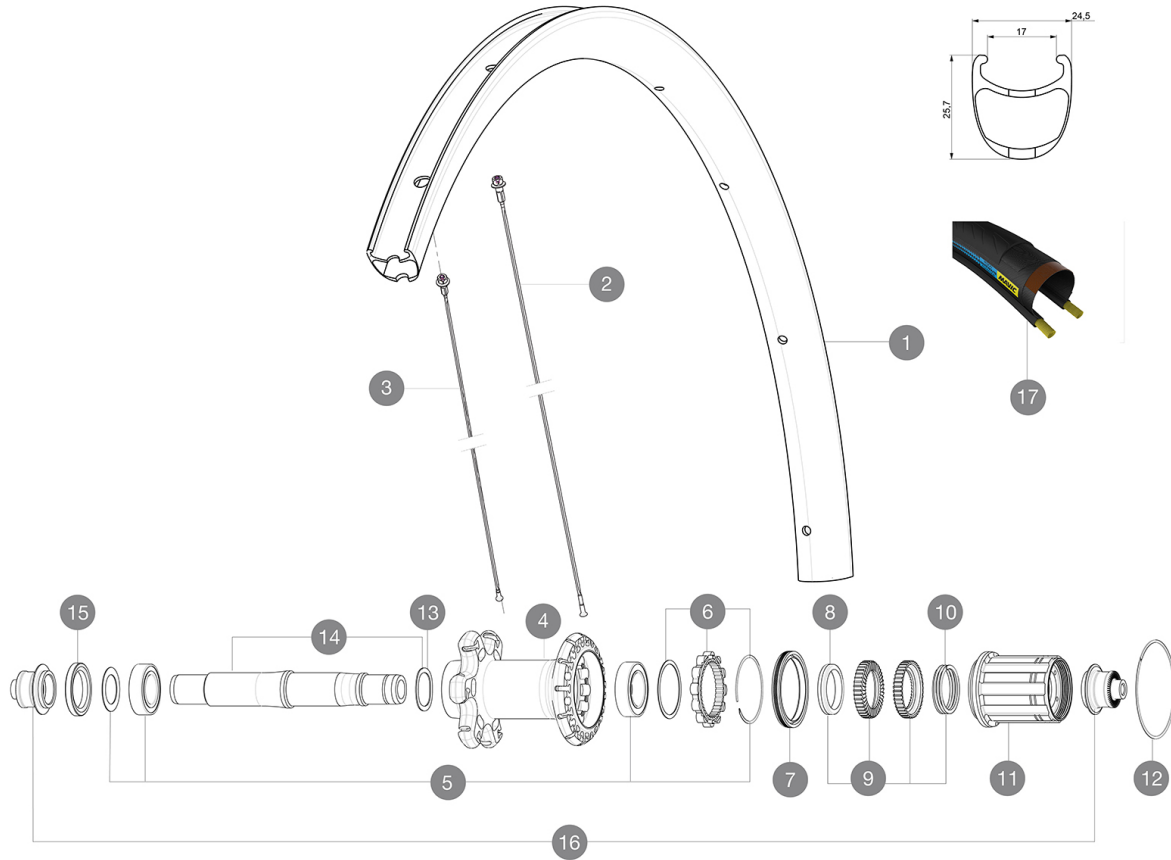

MAVIC *Ksyrium Pro Carbon SL C HR*

ASTM CATEGORY 1 : road only
 Recommended weight limit : 120kg
 Recommended tire sizes: 25 to 32 mm
 Max. Pressure: 25mm 7.7 bars - 110 PSI

REFERENCES WHEELS

R98701 KsyProCarbSLC HR Rr SV

**RIMS**VALVE HOLE \bar{A} (MM): 6,5 :

| | | |
|---|----------|--|
| 1 | V2409513 | KIT RR RIM KSYRIUM PRO CARBON SL Clinch HR - while stock las |
| 1 | V2737513 | KIT REAR RIM KSYRIUM PRO CARBON SL UST |
| | V3720101 | 25mm UST Tape for 19 to 22mm Road Rims |
| | V2690101 | KIT CARBON RIM TAPE 21x622mm - FOR CARBON RIM |

SPOKES

| | | |
|---|----------|--|
| 2 | V2271401 | KIT 12 DS KSYRIUM PRO CARB SL T SPOKE 273mm - while stock la |
| 2 | V3663201 | KIT 12 DS KSY PRO CARB SL UST/UST Disc/C Disc/T Disc BUTTED |
| 3 | V2271501 | KIT 12 FT KSY PRO CARB SL D/NDS KSY PRO CARB SL SPK 291mm - |
| 3 | V3663301 | KIT 12 FRT KSYR PRO CARB SL UST Disc + NDS KSYR PRO CARB SL |
| 3 | V2273101 | KIT 1 FT 285/1 FT 291/1 DS 273 KSY PRO CARB SL C/D/T HR SPK |

HUB SHELLS

| | | |
|----|----------|--|
| 4 | N/A | HUB BODY |
| 5 | V2540301 | KIT REAR BEARINGS 17x28x7 + 15x26x7 CERAMIC - while stock la |
| 5 | V2560101 | KIT ID360 BEARINGS 15/26/7 + 17/28/7 |
| 6 | V2252701 | KIT ID360 INSERT SHAPED EAR LOBE > 2017 |
| 7 | V2251601 | KIT ID360 SEAL + GREASE |
| 8 | V2500501 | KIT ID360 3 PADS NOISE REDUCING |
| 9 | V2251701 | KIT ID360 2 RATCHETS + SPRING + GREASE |
| 10 | V2251801 | KIT 3 ID360 ROAD SPRINGS |
| 11 | V3430101 | HG11 Freewheel Body ID360 |
| 12 | V2252201 | KIT 2 REAR HUB RETENTION RINGS 48mm |

| | | |
|----|----------|--|
| 13 | V2251501 | KIT 3 ID360 WAVE WASHERS |
| 14 | V2251201 | KIT ID360 AXLE UB |
| 15 | V2251001 | KIT ID360 HUB THREADED CAP UB+DISC 6 BOLTS (large) - while s |

TYRES





| | | |
|----|----------|-----------------------|
| 17 | 39436025 | YksionProPowerLink HR |
|----|----------|-----------------------|

ADAPTERS

| | | |
|----|----------|---------------------------------|
| 16 | B4989401 | ADAPTER Rr 9mm QR ID360 (6bolt) |
|----|----------|---------------------------------|

MAVIC Ksyrium Pro Carbon SL C HR

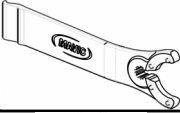
DELIVERED WITH

| | |
|---|---|
| BR601 quick releases (V24 501 01 frt, V24 502 01 rear) 1 |  |
| Carbon brake pads (V24 603 01 Shimano/Sram, V24 604 01 Campagnolo) 1 pair |  |
| Rim tape | |
| Multifunction adjustment wrench (325 423 01) 1 |  |
| "Haute Route" special edition wheelbags 1 |  |
| User guide | |

COMPATIBILITY

| | |
|--|--|
| Freewheel: Shimano/Sram or Campagnolo, convertible to XD-R with optional driver body | |
| Front axle: Quick Release only | |
| Rear axle: Quick Release only | |

Specifications

RIMS

- **Material** : 3K carbon fibers
- **Height** : 25mm
- **Drilling** : traditional
- **Brake track** : carbon with TgMAX technology
- **Brake track** : carbon
- **Valve hole diameter** : 6.5 mm
- **Tire** : clincher
- **Internal width** : 17 mm
- **ETRTO size** : 622x17C

SPOKES

- **Material** : steel
- **Shape** : straight pull, bladed, double butted
- **Nipples** : aluminum, ABS
- **Count** : front 18, rear 24
- **Lacing** : front radial, rear Isopulse

WHEEL HUB

- **Front and rear bodies** : aluminum
 - **Axle material** : aluminum
- High quality ceramic bearings by CeramicSpeed (R)
- **Freewheel** : Instant Drive 360

VERSIONS

- **Color** : Black only

WHEEL WEIGHTS

Wheel weight 775