

ASTM CATEGORY 2 : road and offroad with jumps less than 15cm
 For a longer longevity of the wheel, Mavic recommends that the total weight supported by the wheels don't exceed 120kg, bike included
 Recommended tyre sizes: 25 to 32 mm
 Max. Pressure tubeless: 25mm 7 bars - 100 PSI, 28mm 6 bars - 87 PSI. Max pressure tubetype: 25/28mm 7,7 bars - 110 PSI

REFERENCES WHEELS

R16851 Cos El 18 UST Rr

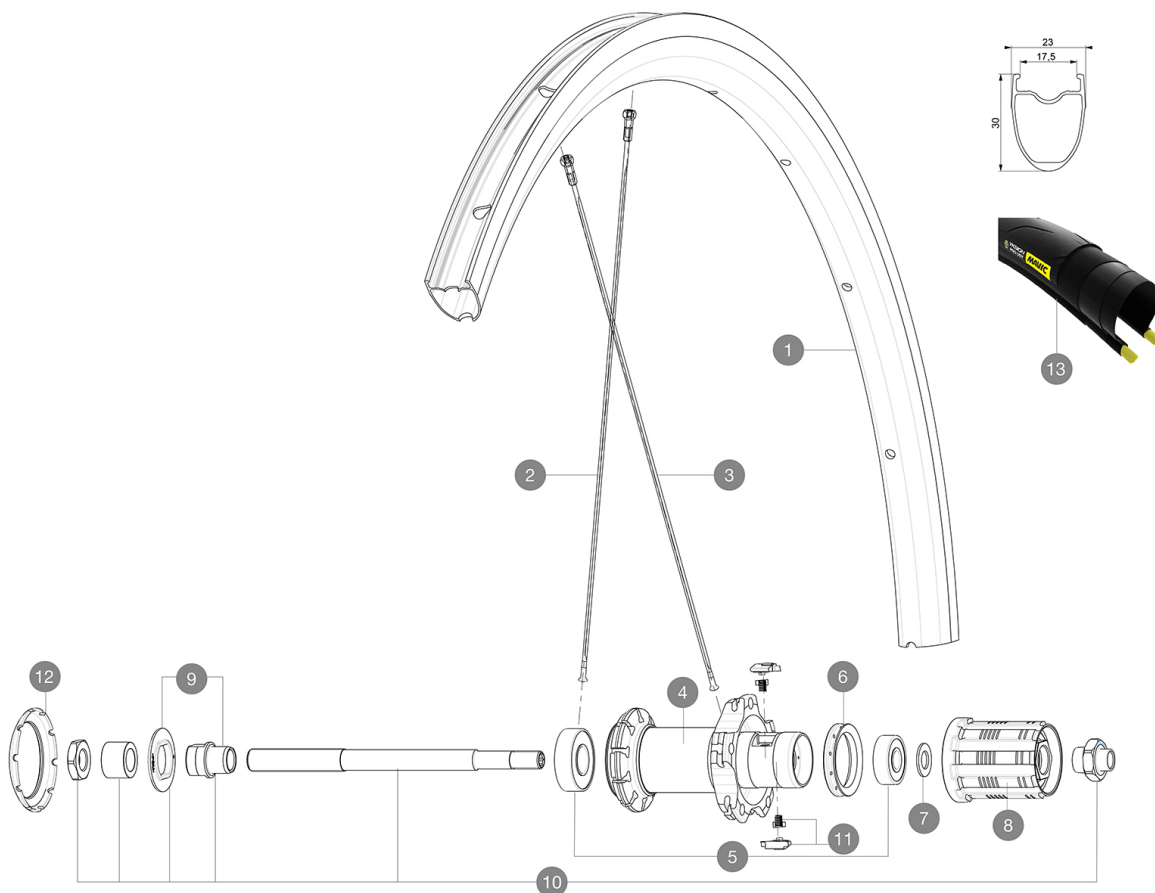

RIMS



&NBSP;:

| | | |
|---|----------|---|
| 1 | V2732615 | KIT FRONT/REAR RIM COSMIC ELITE UST |
| | V2900101 | 23mm UST Tape For 17 to 18 Wide Road Rims |

SPOKES

| | | |
|---|----------|--|
| 2 | 36644801 | KIT 10 FT/NDS COSMIC ELITE S / UST BLK SPK 276mm |
| 2 | V2279901 | KIT 10 FT/NDS COSMIC ELITE UST LTD SPK 276mm - while stock I |
| 3 | V3660101 | KIT 10 DS COSMIC ELITE UST BUTTED SPOKE 292mm |

HUB SHELLS

| | | |
|----|----------|---|
| 5 | M40660 | REAR HUB 608+6001 BEARINGS |
| 6 | 99500001 | FTSL/FTSX FREEHUB BODY SEAL |
| 7 | 30872801 | SET OF 3 INTERNAL SILVER SPACERS 9mm FTS-L |
| 8 | 30871101 | FTS-L ROAD FREEWHEEL BODY HG11 8/9 compatible |
| 9 | 99603801 | SHORT EXPENSIBLE BEARING SUPPORTS > 2008 |
| 10 | 99603901 | REAR AXLE QRM ROAD 2008 |
| 11 | M40578 | FTSL PAWLS KIT (ROAD WHEELS) |
| 12 | 12034401 | KIT 3 HUB CAPS AERO 10 SLOTS BLACK |

TYRES

| | | |
|----|----------|-----------------------|
| 13 | 39938825 | Yksion Pro UST 700x25 |
|----|----------|-----------------------|

MAVIC Cosmic Elite UST

DELIVERED WITH

| | |
|---|--|
| Mavic tyre sealant (rear wheel) (355 466 01) | |
| Mavic tyre sealant (rear wheel) (355 466 01) | |
| Tyre sealant syringe | |
| Tyre sealant syringe | |
| BR101 quick releases (M40350 frt, M40351 rear road, M40352 rear MTB) | |
| BR101 quick releases (M40350 frt, M40351 rear road, M40352 rear MTB) | |
| UST valve and accessories (129 838 01) | |
| UST valve and accessories (129 838 01) | |
| Tubeless rim tape | |
| Tubeless rim tape | |
| User guide | |
| User guide | |

COMPATIBILITY

| | |
|--|--|
| Freewheel: Shimano/Sram, convertible to Campagnolo with optional driver body | |
| Freewheel: Shimano/Sram, convertible to Campagnolo with optional driver body | |
| Front axle: Quick Release only | |
| Front axle: Quick Release only | |
| Rear axle: Quick Release only | |
| Rear axle: Quick Release only | |

Specifications

RIMS

- **Material** : S6000 Aluminum
 - **Material** : S6000 Aluminum
 - **Height** : 30 mm
 - **Height** : 30 mm
 - **Joint** : SUP
 - **Joint** : SUP
 - **Drilling** : traditional
 - **Drilling** : traditional
 - **Brake track** : UB Control
 - **Brake track** : UB Control
 - **Valve hole diameter** : 6.5 mm
 - **Valve hole diameter** : 6.5 mm
 - **Tyre** : UST Tubeless and tubetype
 - **Tyre** : UST Tubeless and tubetype
 - **Internal width** : 17 mm
 - **Internal width** : 17 mm
 - **ETRTO size** : 622x17TC ROAD
 - **ETRTO size** : 622x17TC ROAD
- Use with Mavic Tubeless Tape

SPOKES

- **Material** : steel
- **Material** : steel
- **Shape** : straight pull, bladed
- **Shape** : straight pull, bladed

WHEEL HUB

- **Front and rear bodies** : aluminum
 - **Front and rear bodies** : aluminum
 - **Axle material** : steel
 - **Axle material** : steel
- Sealed cartridge bearings (QRM)
Sealed cartridge bearings (QRM)
- **Freewheel** : FTS-L steel
 - **Freewheel** : FTS-L steel

VERSIONS

- **Color** : Black only

WHEEL WEIGHTS

955