

MAVIC E-SPEEDCITY 1 650B

1
2023
FRONT

RÉFÉRENCES ROUES

ASTM CATEGORY 2 : road and offroad with jumps less than 15cm

Taille minimale du pneu: largeur 52mm - pression max. 2.35Bar/34PSI

Recommended tire sizes: 50mm to 76mm (2.0" to 3.0")

Taille maximale du pneu: largeur 125mm - pression max. 1.25Bar/18PSI

For a longer longevity of the wheel, Mavic recommends that the total weight supported by the wheels doesn't exceed 180kg, E-bike included

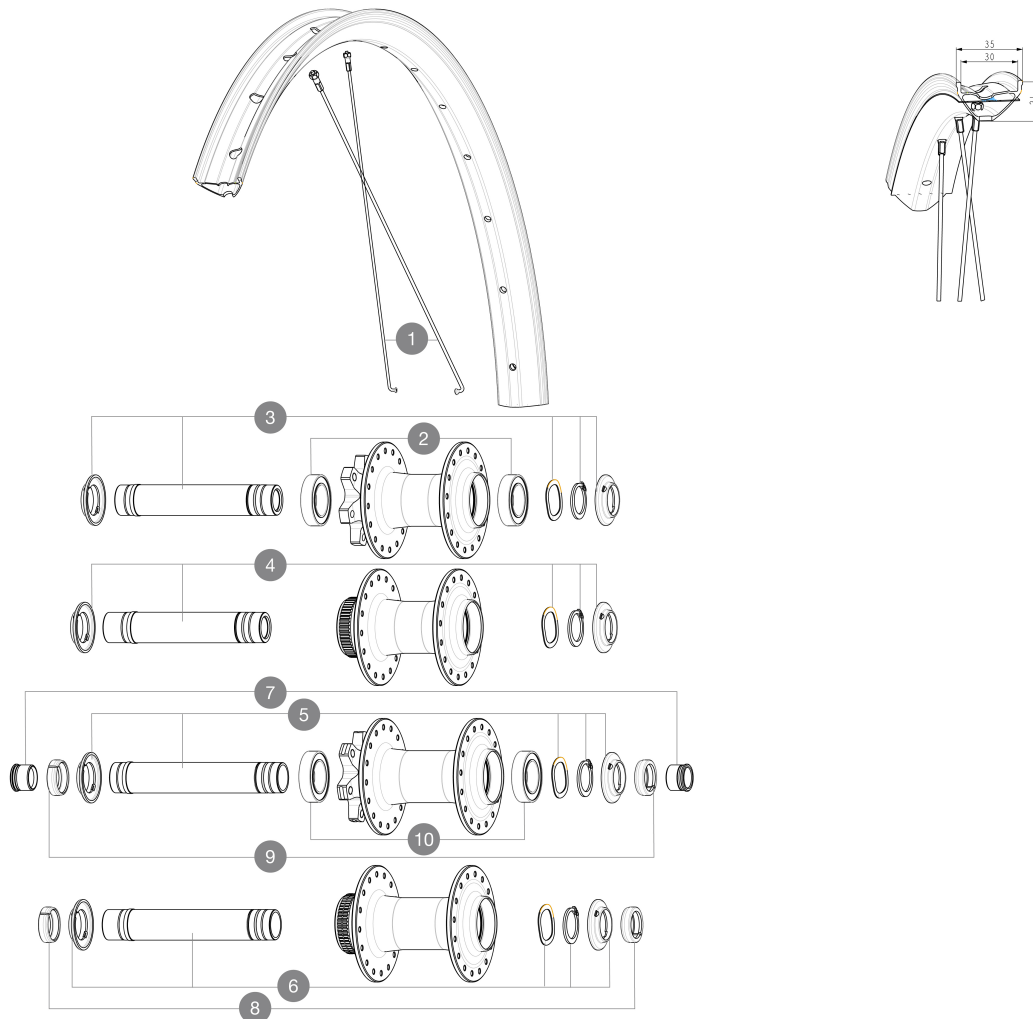

RAYONS

1 V00062531 Kit 16ft/rr Jbent bk rd spk275 27,5"+np

MOYEUX

V2500901 KIT BEARINGS 18x30x7 + WAVED WASHER + CLIP
 3 V2375501 Kit QRM auto front axle 100x12/15mm D6T
 4 V2374001 KIT 12x100mm FRONT AXLE DCL QRM AUTO ALLROAD > 2019
 5 V2372401 KIT 110mm AXLE QRM AUTO MTB > 2019
 6 V2375601 Kit 110mm axle QRM auto MTB from 2019 DCL

ADAPTATEURS

7 V2680201 12mmFtRoadAxleAdaptersQRM
 8 V2680501 12mm Road Axle Cap QRM Auto
 9 V2372501 15mm MTB Axle Cap QRM Auto From 2019
 99694101 2 REDUCTEURS 15/9mm
 V2680301 Kit Ft Road Adapter 12 >> 9mm

LIVRE AVEC

| | |
|--|--|
| User guide | |
| Fond de jante tubeless prêt à installer | |
| Rondelle de cassette M9 non montée sur la roue arrière | |
| Rondelle de cassette M9 non montée sur la roue arrière | |
| User guide | |
| User guide | |
| Fond de jante tubeless prêt à installer | |

COMPATIBILITE

| | |
|--|--|
| Freewheel: Shimano/Sram, convertible to Campagnolo ED11, N3W and XD-R with optional driver bodies | |
| Front axle: 12mm thru axle, easily convertible to quick release with optional adapters. Convertible to 15mm with complete axle replacement | |
| Rear axle: 12mm thru axle, convertible to Quick Release with optional adapters and axle replacement | |
| Corps de roue libre: convertible SRAM XD route (kit V2580101 vendu séparément) | |
| Corps de roue libre: convertible SRAM XD route (kit V2580101 vendu séparément) | |
| Corps de roue libre: convertible SHIMANO HG light route (kit V3850101 vendu séparément) | |
| Corps de roue libre: convertible SHIMANO HG light route (kit V3850101 vendu séparément) | |
| Corps de roue libre: convertible SHIMANO MS (kit V3990101 vendu séparément) | |
| Corps de roue libre: convertible SHIMANO MS (kit V3990101 vendu séparément) | |
| Front axle: 12mm thru axle, easily convertible to quick release with optional adapters. Convertible to 15mm with complete axle replacement | |
| Front axle: 12mm thru axle, easily convertible to quick release with optional adapters. Convertible to 15mm with complete axle replacement | |
| Corps de roue libre: convertible CAMPAGNOLO N3W (kit V4270101 vendu séparément) | |
| Corps de roue libre: convertible CAMPAGNOLO N3W (kit V4270101 vendu séparément) | |
| ID360 Shimano Micro Spline alloy freewheel body (V3990101) | |
| Corps de roue libre ID360 Sram XD (V3740101) | |
| Axe arrière : fixation par écrou uniquement (fournis), filetage M9x1 | |
| Corps de roue libre ID360 Sram XD (V3740101) | |
| Axe arrière : fixation par écrou uniquement (fournis), filetage M9x1 | |