

MAVIC Comete Pro Carbon SL C Disc

CATÉGORIE ASTM 1 : route uniquement

Pour optimiser la longévité des roues, Mavic recommande un poids maximal supporté par les roues de 120kg poids du vélo inclus

Dimensions de pneu recommandées : 25 Å 32 Å mm

Pression max. tubeless : 25 mm 6 bars - 87 PSI, 28 mm 5 bars - 70 PSI Pression max. tubetype : 25/28 mm 7,7 bars - 110 PSI

Pression max. Å : 25 Å mm 7,7 Å bars - 110 Å PSI

RÉFÉRENCES ROUES

R93301	ComPCarSI USTD6BR12x142	R99491	ComPCarbSLCD12x142RrCLCustom
R93401	ComPCarSI USTDCLR12x142		

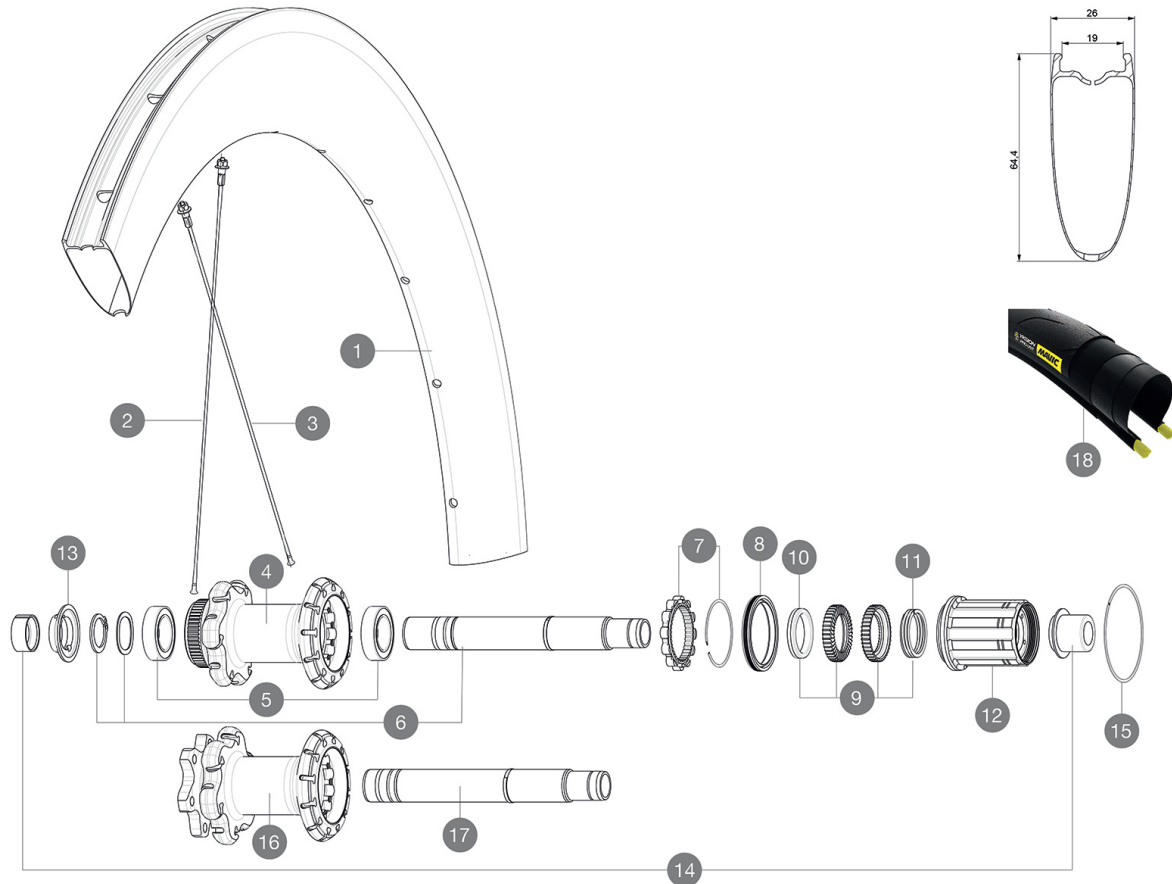

JANTES



&NBSP;:

1	V2732913	KIT REAR RIM COMETE PRO CARBON SL UST DISC - while stock las
1	V4093115	Kit Front/Rear rim Cosmic SL 65 Disc while stock lasts
	V2620101	UST RIM TAPE 25mm (for 21-24mm wide rim)

RAYONS

2	V3662301	KIT 12 FRT/ND S COMETE PRO CARB SL T/UST D & DS COSMIC PRO CA
2	V2278601	KIT 12 FT/ND S BUTTED AERO SPOKE 253mm - while stock last
3	V3662401	KIT 12 DS BUTTED AERO STAINLESS SPOKE 236 + alu nipp.+ wash.
3	V2278501	KIT 1 FT 247/FT 253/DS 236 COMETE PRO CARB SL T D SPK
3	V2278701	KIT 12 DS BUTTED AERO SPOKE 236mm - while stock last

MOYEURS

4	N/A	CORPS DE MOYEU
5	V2560401	KIT ID360 2 BEARINGS 17x28x7 + CIRCLIP + WAVED WASHER (QRM A
6	V2252901	KIT ID360 CENTER LOCK 135/142mm AXLE WITH CIRCLIP
7	V2252701	KIT ID360 INSERT SHAPED EAR LOBE > 2017
8	V2251601	ID360 SEAL + GREASE
9	V2251701	ID360 2 RATCHETS + SPRING + GREASE
10	V2500501	Kit 3 ID360 pad for noise reduction
11	V2251801	KIT 3 ID360 ROAD SPRINGS
12	V3430101	HG11 Freewheel Body ID360

13 V2560501 KIT ADJUST. SYSTEM QRM AUTO ID360 for 17x28x7 bearing

15 V2252201 KIT 2 REAR HUB RETENTION RINGS 48mm

16 N/A CORPS DE MOYEU

17 V2253001 KIT ID360 6 BOLTS 135/142mm AXLE WITH CIRCLIP

PNEUMATIQUES

18 39938825 Yksion Pro UST 700x25

ADAPTATEURS

14 V2510701 ID360 EVO REAR AXLE ADAPTERS 12x142mm DCL & D6T

V2510801 ID360 EVO REAR AXLE ADAPTERS 9x135mm DCL & D6T

V2510901 ID360 EVO REAR AXLE ADAPTERS 12x135mm DCL & D6T

