

# MAVIC COSMIC SL 32 LTD

2023  
REAR

## REFERENZEN RÄDER

ASTM CATEGORY 2 : road and offroad with jumps less than 15cm

For a longer longevity of the wheel, Mavic recommends that the total weight supported by the wheels doesn't exceed 120kg, bike included

Recommended tire sizes: 25 to 32 mm

Max. Pressure: see indication on wheel and tire. If they differ, use the lowest of the 2

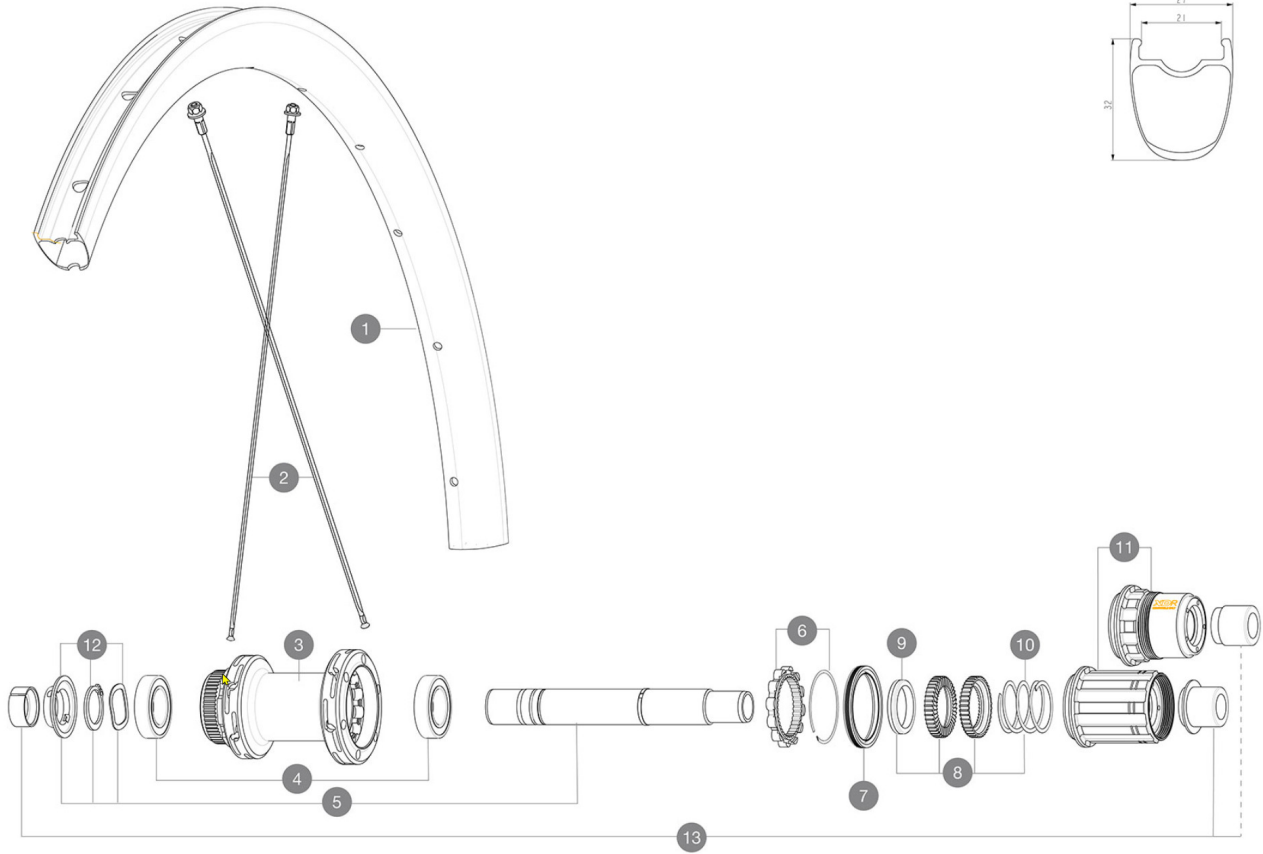

## RIMS



&NBSP;:

|   |           |  |
|---|-----------|--|
| 1 | V00063531 | Kit Front/Rear rim Cosmic SL32 Ltd       |
|   | V2620101  | UST RIM TAPE 25mm (for 21-24mm wide rim) |

## SPOKES

|   |          |  |
|---|----------|--|
| 2 | V4163401 | Kit 12 Front/Rear Cosmic SL 32 Disc butted stainless spoke 2 |
|---|----------|--|

## HUB SHELLS

|    |           |   |
|----|-----------|---|
| 3  | N/A       | NABENKÖRPER   |
| 4  | M40076    | HUB BEARINGS 17x30x7 6903 x 2                         |
| 5  | V2373401  | KIT ID360 135/142 DCL L1 AXLE WITH CLIP               |
| 6  | V2252701  | KIT ID360 INSERT SHAPED EAR LOBE > 2017               |
| 7  | V00063631 | Kit ID360 seal version 2 (larger)                     |
| 8  | V2251701  | ID360 2 RATCHETS + SPRING + GREASE                    |
| 9  | V2500501  | Kit 3 ID360 pad for noise reduction                   |
| 10 | V2251801  | KIT 3 ID360 ROAD SPRINGS                              |
| 11 | V3430101  | HG11 Freewheel Body ID360                             |
| 11 | V2580101  | FREEHUB BODY XD Road ID360                            |
| 12 | V2373001  | KIT ADJUST. SYSTEM QRM AUTO ID360 for 17x30x7 bearing |

## ADAPTERS

|    |          |   |
|----|----------|---|
| 13 | V2510701 | ID360 EVO REAR AXLE ADAPTERS 12x142mm DCL & D6T |
|    | V2510901 | ID360 EVO REAR AXLE ADAPTERS 12x135mm DCL & D6T |
|    | V2510801 | ID360 EVO REAR AXLE ADAPTERS 9x135mm DCL & D6T  |

**MAVIC** **COSMIC SL 32 LTD****GELIEFERT MIT**

|   |  |
|---|--|
| Front QR adapters                                   |  |
| Rear QR adapters for Instant Drive 360 (B49 894 01) |  |
| UST valve and accessories (129 838 01)              |  |
| Pre-installed tubeless rim tape                     |  |
| User guide  |  |

**COMPATIBILITY**

|   |  |
|---|--|
| Freewheel: Shimano/Sram, convertible to Campagnolo ED11, N3W and XD-R with optional driver bodies                                 |  |
| Front axle: 12x100 thru axle, easily convertible to quick release with included adapters. Not compatible with 15mm through axles. |  |
| Rear axle: 12mm thru axle, convertible to Quick Release with included adapters  |  |

**Specifications****FELGEN**

- **Material** : 100% carbon fiber
  - **Height** : 32mm
  - **Drilling** : traditional
- Disc brake specific profile
- **Tire** : UST Tubeless and tubetype
  - **Internal width** : 21 mm
  - **ETRTO size** : 622x21TC
- UST tubeless technology

**SPEICHEN**

- **Material** : steel
- **Shape** : straight pull, flat, double butted
- **Nipples** : brass, ABS
- **Count** : 24 front and rear
- **Lacing** : front and rear crossed 2, contactless

**RADNABE**

- **Front and rear bodies** : aluminum
  - **Axle material** : aluminum
  - **Front** : Quick release and 12x100 through axle compatible
  - **Rear** : Quick Release, 12x142 and 12x135 compatible
- Infinity hubs  
Nabe nur f¼r Center-Lock®-Bremsscheiben erh¼ltlich  
Instant Drive 360 freewheel technology  
QRM Auto bearing preload technology

**VERSIONS**

- **Disc standard** : Center Lock® only
- **Freewheel** : Shimano/Sram

**RADGEWICHTE**

807