

**ASTM CATEGORY 3 : CROSS COUNTRY**

For a longer longevity of the wheel, Mavic recommends that the total weight supported by the wheels doesn't exceed 150kg, bike included

Recommended tyre sizes: 50mm to 76mm (2.0" to 3.0")

**REFERENCES WHEELS**

F90422 Xmax SL Ulti 25 29 DCL Ft Bst\*

F92242 Xmax SL Ulti25 29 INTL Ft Bst\*

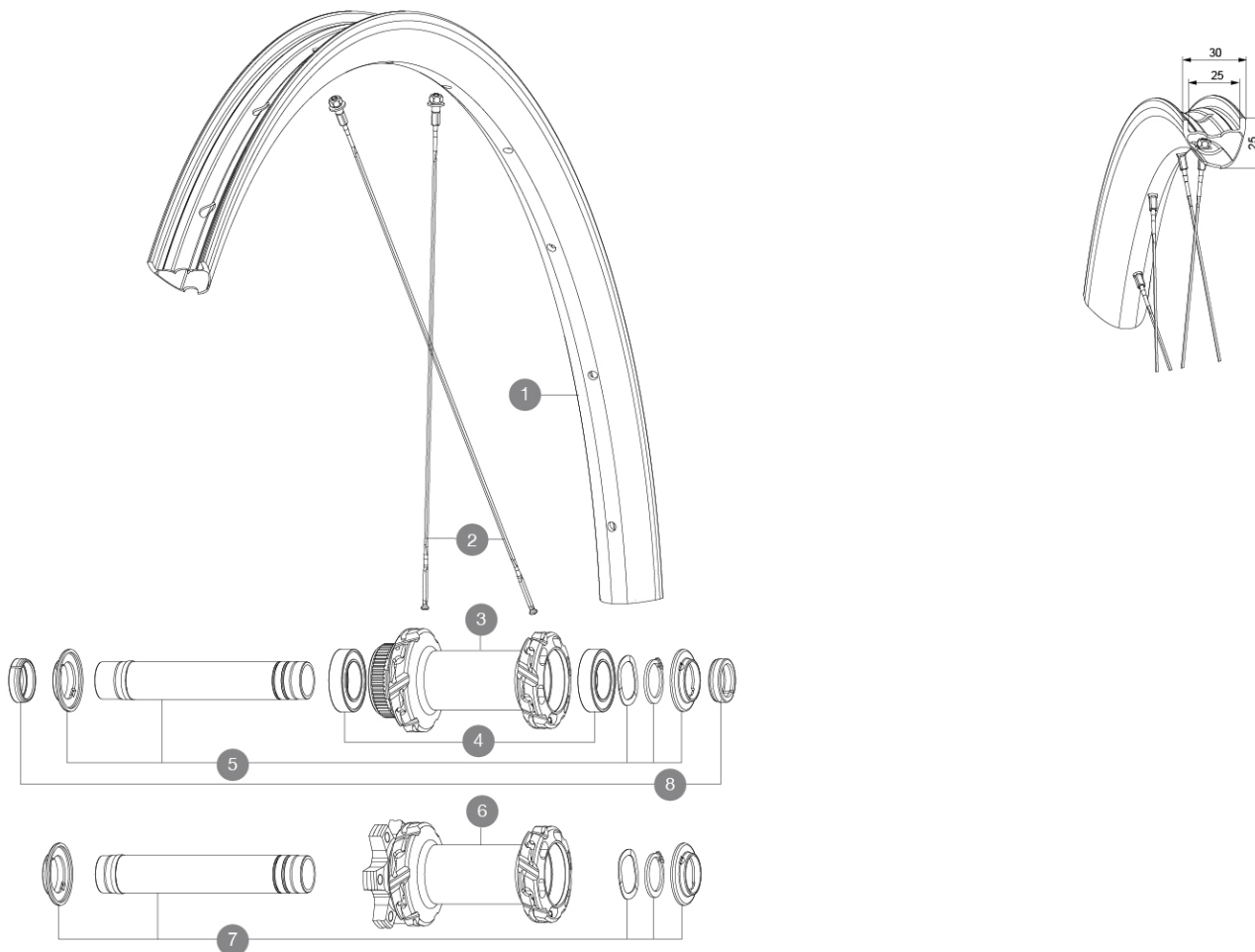

**RIMS**



&NBSP::

1	V3766615	Kit Front/Rear rim Crossmax SL Ultimate 25 -while stock last
1	V2700101	UST Tape 28mm for 25 to 27mm wide rims
	V00004831	Kit Front/Rear rim Crossmax SL Ultimate 29" 22

**SPOKES**

2	V00065231	Kit12Fr/Rr MTBcarb29 ss spk293
2	V2389101	Kit 12Fr/Rr XmaxSL Ultimate spk293+np&w while stock lasts

**HUB SHELLS**

3	N/A	HUB BODY
4	V2500901	KIT BEARINGS 18x30x7 + WAVED WASHER + CLIP
5	V2375601	Kit 110mm axle QRM auto MTB from 2019 DCL
6	N/A	HUB BODY
7	V2372401	KIT 110mm AXLE QRM AUTO MTB > 2019

**OPTIONS**

V2374401	TORQUE CAPS 15*31 Adapter MTB QRM Auto > 2019 Frt HUB
----------	---

**ADAPTERS**

8	V2372501	KIT FT MTB FORKREST FROM 2019
	99694101	ADAPTER Ft 15 to 9mm QR

**DELIVERED WITH**

UST valve and accessories (129 838 01)	
Pre-installed tubeless rim tape	
Multifunction adjustment wrench (delivered with rear wheel) (325 423 01)	
Wheelbag (V24 801 01)	
2 replacement spokes with each wheel	

**COMPATIBILITY**

Freewheel: Shimano HG9, XD or Micro Spline	
Rear axle: 12x148 Boost thru axle	
Front axle: 15x110 Boost thru axle	

**Specifications****RIMS**

- **Material** : 100% carbon fiber
- **Drilling** : traditional
- **Internal width** : 25 mm
- **ETRTO size 29"** : 622x25TSS

Hookless profile

Asymmetrical rim design

Adaptive Layup Carbon technology

UST Tubeless Ready

**SPOKES**

- **Material** : steel
- **Shape** : straight pull, flat, double butted
- **Nipples** : aluminum, ABS
- **Count** : 24 front and rear
- **Lacing** : front and rear crossed 2, contactless

**WHEEL HUB**

Hub available with 6-bolt or center lock (R) brake rotors

- **Axles** : Front 15X110 Boost ; Rear 12X148 Boost

Infinity Hub

24 teeth ratchet

Instant Drive 360

QRM Auto

**VERSIONS**

- **Disc standard** : 6 Bolts or Center Lock (R)
- **Hub width** : Boost only (front 110, rear 148)
- **Freewheel** : SRAM XD, Shimano HG9, Shimano Micro-Spline

**WHEEL WEIGHTS**

605