

MAVIC Ksyrium Elite Allroad Disc UST

2017
REAR

ASTM CATEGORY 2 : road and offroad with jumps less than 15cm
Recommended weight limit : 120kg
Recommended tire sizes: 28 to 42 mm
Max. Pressure: 28mm 7.7 bars - 110 PSI / 30mm 5.8 bars - 85 PSI

REFERENCES WHEELS

R83001 KsyElAIRD6BRr 12x142 R86701 KsyElAIRDCLRr 12x142

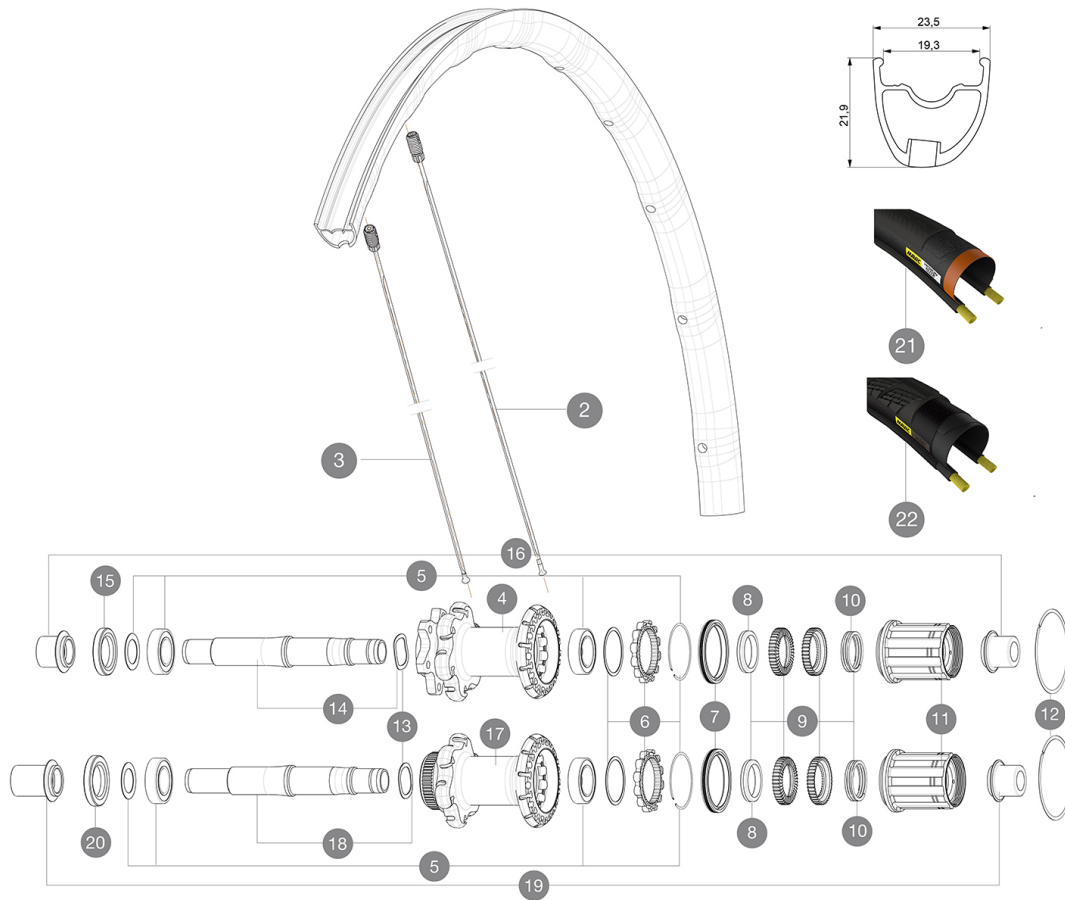

RIMS



&NBSP;:

1 V2405813 KIT REAR RIM KSYRIUM ELITE ALLROAD

SPOKES

2 V2273201 KIT 12 FRT/NON DRIVE SIDE BUTTED SPOKE 297mm
3 V2273301 KIT 12 DRIVE SIDE BUTTED SPOKE 280mm

HUB SHELLS

| | | |
|----|----------|--|
| 4 | N/A | HUB BODY |
| 5 | V2560201 | KIT ID360 BEARINGS 15/28/7 + 17/28/7 |
| 6 | V2252701 | KIT ID360 INSERT SHAPED EAR LOBE > 2017 |
| 7 | V2251601 | KIT ID360 SEAL + GREASE |
| 8 | V2500501 | KIT ID360 3 PADS NOISE REDUCING |
| 9 | V2251701 | KIT ID360 2 RATCHETS + SPRING + GREASE |
| 10 | V2251801 | KIT 3 ID360 ROAD SPRINGS |
| 11 | V3430101 | HG11 Freewheel Body ID360 |
| 12 | V2252201 | KIT 2 REAR HUB RETENTION RINGS 48mm |
| 13 | V2251501 | KIT 3 ID360 WAVE WASHERS |
| 14 | V2251301 | KIT ID360 AXLE DISC 6 BOLTS |
| 15 | V2251001 | KIT ID360 HUB THREADED CAP UB+DISC 6 BOLTS (large) - while s |
| 17 | N/A | HUB BODY |
| 18 | V2251401 | KIT ID360 AXLE DISC CENTER LOCK |
| 20 | V2251101 | KIT ID360 HUB THREADED CAP DISC CENTER LOCK |

TYRES





21 37805628 Yksion EliteGuard White
22 38012230 Yksion Elite Allroad

ADAPTERS

16 B4989601 ADAPTER Rr 12x142mm ID360 (6bolt)
19 B4989901 ADAPTER Rr 12x142mm ID360 (Lock)

MAVIC Ksyrium Elite Allroad Disc UST

DELIVERED WITH

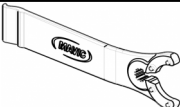
| | |
|---|---|
| 1 bottle of Mavic Sealant (355 466 01) 1 |  |
| Front 12 mm adapters (B4104201) 1 |  |
| Rear 12x142mm adapters for Instant Drive 360 (B49 896 01 for ID360 6T, B49 899 01 for ID360 CL) 1 |  |
| UST valve and accessories (129 838 01) |  |
| Specific disc bolts (308 719 01) Pack of 6 |  |
| Multifunction adjustment wrench (325 423 01) 1 |  |
| User guide | |

COMPATIBILITY

| | |
|---|--|
| Freewheel: Shimano/Sram, convertible to Campagnolo and XD-R with optional driver bodies | |
| Front axle: convertible from 12mm thru axle to quick release or 15mm thru axle with optional adapters | |
| Rear axle: 12mm thru axle, convertible to Quick Release with optional adapters | |

Specifications

RIMS

- **Material** : Maxtal
- **Height** : 26mm, asymmetrical
- **Joint** : SUP
- **Drilling** : Fore

Disc brake specific profile

- **Weight reduction** : ISM 4D
- **Valve hole diameter** : 6.5 mm
- **Tire** : UST Tubeless and tubetype
- **Internal width** : 19 mm
- **ETRTO size** : 622x19C

SPOKES

- **Material** : steel
- **Shape** : straight pull, bladed
- **Nipples** : Fore integrated aluminum
- **Count** : 24 front and rear
- **Lacing** : front crossed 2, rear Isopulse

WHEEL HUB

- **Front and rear bodies** : aluminum
 - **Axle material** : aluminum
- Sealed cartridge bearings
- **Freewheel** : Instant Drive 360
 - **Front** : Quick release, 12 thru and 15 thru compatible
 - **Rear** : 12x142 (convertible to quick release with optional adapters)

VERSIONS

- **Color** : Black only
- **Disc standard** : 6 Bolts or Center Lock(R)

WHEEL WEIGHTS

Wheel weight 910