

REFERENCES WHEELS

F14501 Ksyrium Pro Disc Ft CL

F01701 Ksyrium Pro Disc Ft INT

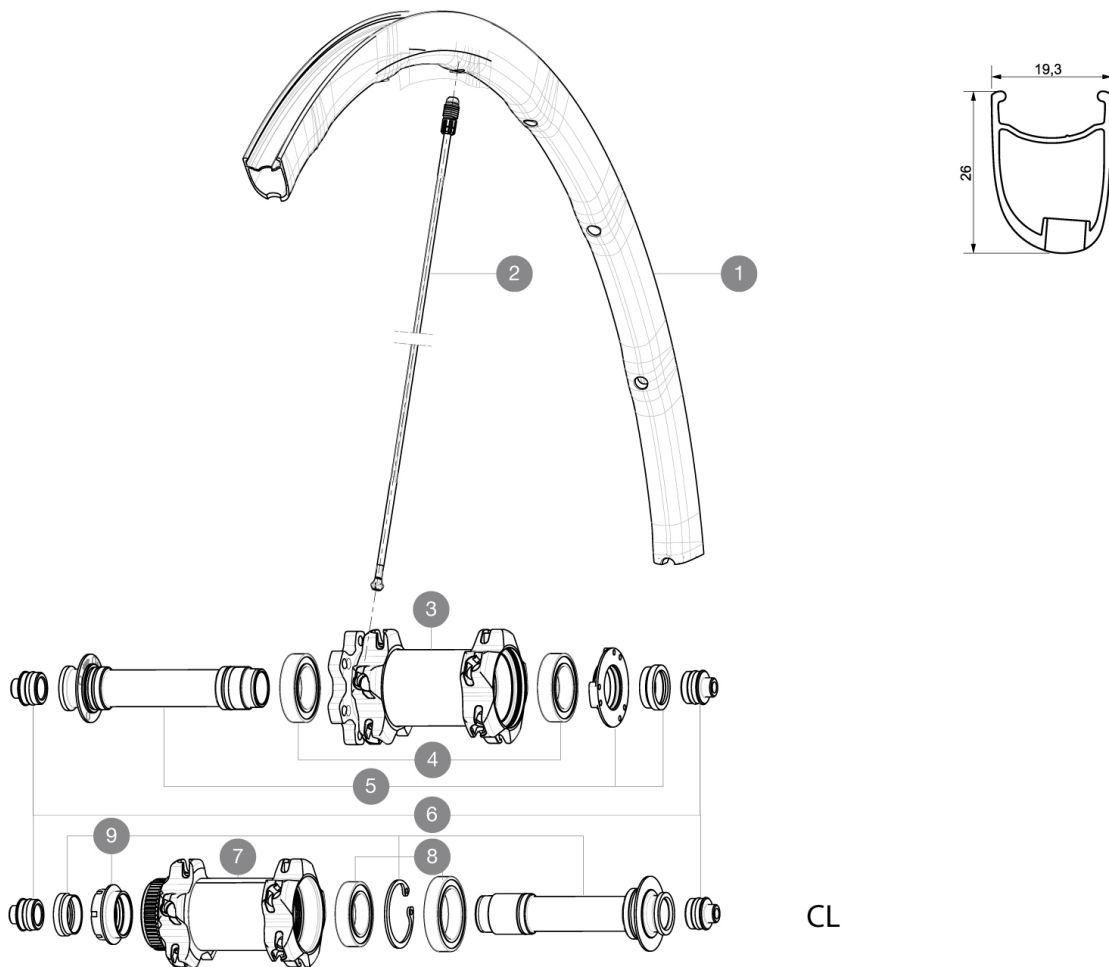

RIMS



VALVE HOLE \bar{A} (MM): 6.5 :

1 V2290510 KIT FRONT RIM KSYRIUM PRO DISC

SPOKES

2 12029401 KIT 10 DS R-SYS SL/SLR CLINC BLK SPK 294,5mm

HUB SHELLS

| | | |
|---|----------|--|
| 3 | N/A | HUB BODY |
| 4 | 99688501 | BEARING KIT 9/12/15 D6T HUB 20x32x7 6804 |
| 5 | 99688201 | 9/15 6B FRT AXLE CROSSMAX/KSY PRO CARBON SL C |
| 7 | N/A | HUB BODY |
| 8 | 99688601 | BEARING KIT 9/15 DCL HUB 20x32x7 6804 + 25x37x7 6805 |
| 9 | 99688301 | 9/15 CL FRT AXLE CROSSMAX/KSY PRO CARBON SL C |

ADAPTERS

6 99694101 ADAPTER Ft 15 to 9mm QR

MAVIC Ksyrium Pro Disc

DELIVERED WITH

| | |
|---------------------------------|--|
| BX601 quick releases | |
| Front QR adapters | |
| Specific disc bolts | |
| Computer magnet (front wheel) | |
| Multifonction adjustment wrench | |
| User guide | |

Specifications

RIMS

- **Material** : Mxtral
 - **Height** : 26mm, asymmetrical
 - **Joint** : SUP
 - **Drilling** : Fore
- Disc brake specific profile
- **Weight reduction** : ISM4D
 - **Valve hole diameter** : 6.5 mm
 - **Tyre** : clincher
 - **ETRTO size** : 622x15C
 - **Recommended tyre sizes** : 19 to 32 mm

SPOKES

- **Material** : Zicral
- **Shape** : straight pull, bladed
- **Nipples** : Fore integrated aluminum
- **Count** : 20 front and rear
- **Lacing** : front crossed 2, rear Isopulse

WHEEL HUB

- **Front body** : carbon with aluminum flanges
 - **Rear body** : aluminum
 - **Axle material** : aluminum
- Adjustable sealed cartridge bearings
- **Freewheel** : FTS-L steel

WHEEL WEIGHTS

Wheel weight 680