

ASTM CATEGORY 3 : CROSS COUNTRY AND TRAIL RIDING

For a longer longevity of the wheel, Mavic recommends that the total weight supported by the wheels don't exceed 120kg, bike included

Recommended tyre sizes: 60mm to 81mm (2.5" to 3.2")

REFERENCES WHEELS

F76171 XA Elite 27+ Ft Bst NT

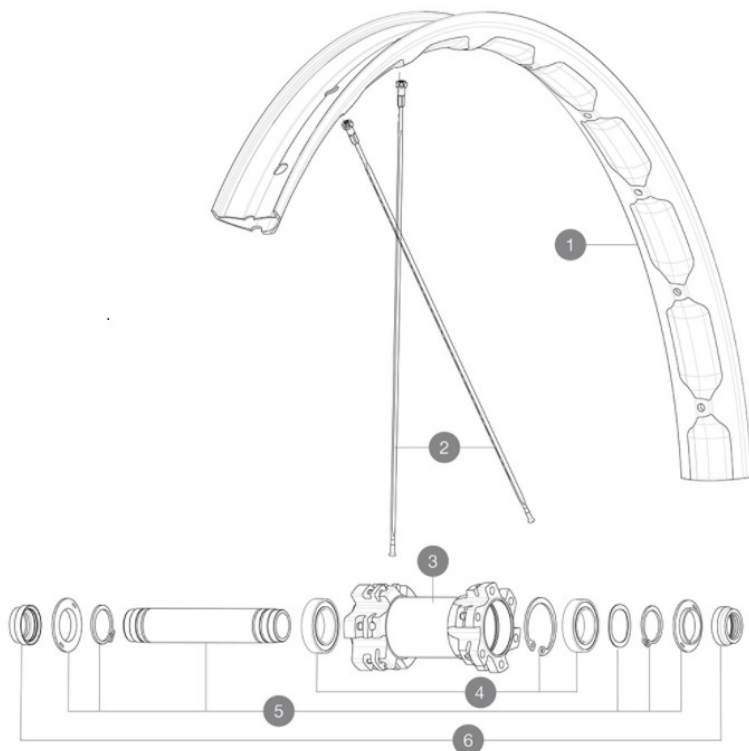

| FRONT WHEEL | N° | PARTS | REFERENCE BOOST |
|--------------|-------|----------|-----------------|
| XA ELITE 27+ | 3 BIS | HUB BODY | N/A |
| | 5 BIS | AXLE | V2372401 |
| | 6 BIS | ADAPTORS | V2372501 |

RIMS



&NBSP;:

| | | |
|---|----------------------|--|
| 1 | V2319115 V3700101 | KIT FRONT/REAR RIM E-XA/XA ELITE 27,5"+ 40 TSS 43mm UST Tape For 40mm Wide Rims |
|---|----------------------|--|

SPOKES

| | | |
|---|----------|--|
| 2 | V3666501 | KIT 12 FRT/NDS AKSIUM ELITE UST Disc 650B FLAT SPOKE 277mm + |
| 2 | V2386201 | KIT 12 FRT/REAR E-XA/XA ELITE 27,5" BLACK NIPPLES - while s |

HUB SHELLS

| | | |
|---|----------------------|---|
| 3 | N/A N/A | HUB BODY HUB BODY |
| 4 | 99688501 | BEARING KIT 9/12/15 D6T HUB 20x32x7 6804 |
| 5 | V2372001 V2372401 | KIT FRONT AXLE MTB L1 QRM AUTO BOOST 15x110mm KIT 110mm AXLE QRM AUTO MTB > 2019 |

ADAPTERS

| | | |
|---|----------------------|--|
| 6 | V2390801 V2372501 | KIT 2 FORK RESTS FRONT AXLE MTB QRM AUTO 15mm MTB Axle Cap QRM Auto From 2019 |
|---|----------------------|--|

MAVIC XA Elite 27+**DELIVERED WITH**

| | |
|---|--|
| UST valve and accessories (129 838 01) | |
| Tubeless rim tape | |
| User guide | |

COMPATIBILITY

| | |
|-------------------------------|--|
| Freewheel: Shimano/Sram or XD | |
|-------------------------------|--|

Specifications**RIMS**

- **Material** : S6000 Aluminum
- **Joint** : SUP
- **Drilling** : traditional
- **Weight reduction** : ISM
- **Valve hole diameter** : 6.5 mm
- **Tyre** : UST Tubeless and tubetype
- **Internal width** : 40 mm
- **ETRTO size 27.5"** : 584x40TSS
Hookless profile

Use with Mavic Tubeless Tape

SPOKES

- **Material** : steel
- **Shape** : straight pull, bladed
- **Count** : 24 front and rear
- **Lacing** : front and rear crossed 2

WHEEL HUB

- **Front and rear bodies** : aluminum
- **Axle material** : aluminum
- **Front bearings** : auto adjust sealed cartridge bearings (QRM Auto), Rear bearings sealed cartridge bearings (QRM)
- **Freewheel** : ITS-4 alloy

VERSIONS

- **Color** : Black only
- **Disc standard** : 6 Bolts only
- **Hub width** : Boost only (front 110, rear 148)

WHEEL WEIGHTS

940