

MAVIC Cosmic Carbone 40 C

1
2016
REAR

ASTM CATEGORY 1 : road only
Recommended weight limit : 120kg

REFERENCES WHEELS

R78001 CC40C Rr 16

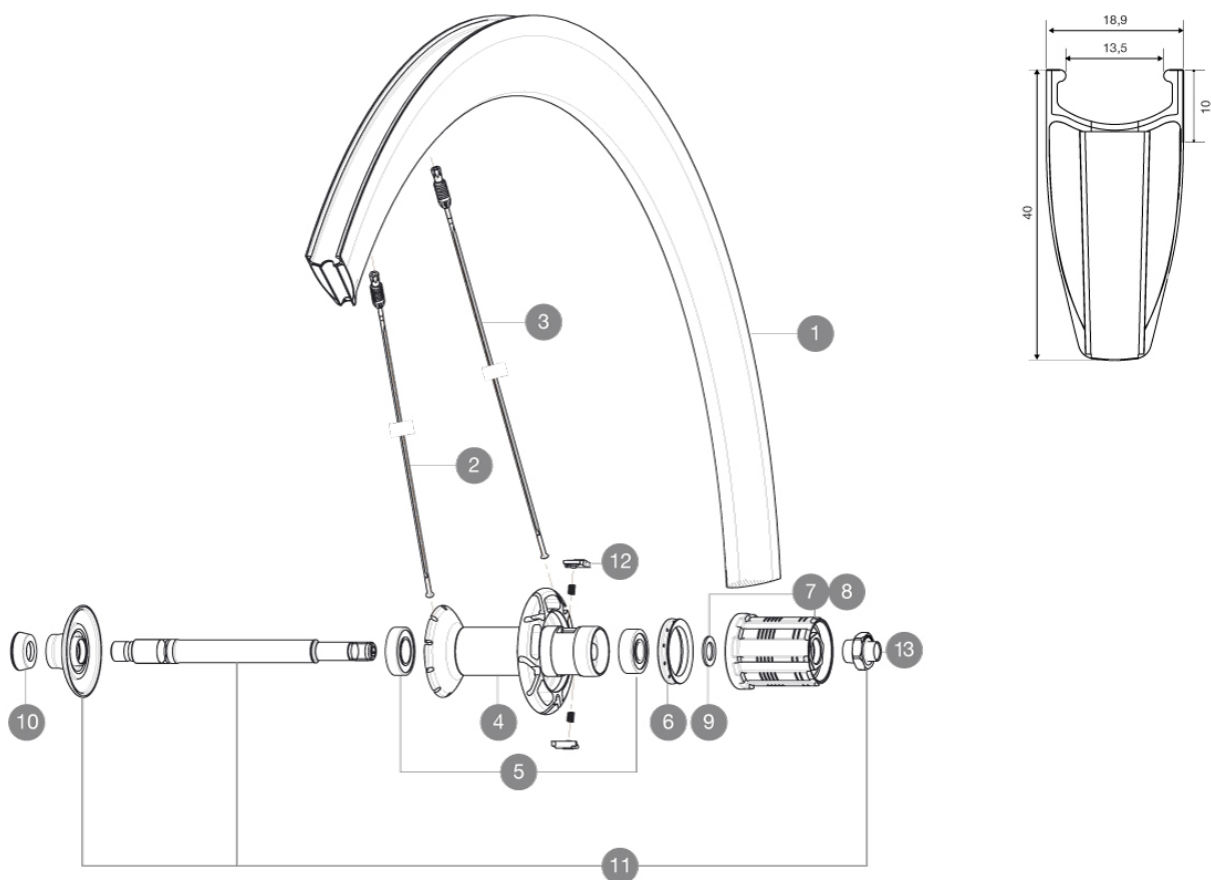

RIMS



&NBSP::

1 32978213 KIT REAR RIM CC 40 CLINCHER

ADAPTERS

10 35117301 FT/RR FORK REST R-SYS/CC ULTIMATE > 2013/KSY PRO CARB T

SPOKES

2 V3664201 KIT 12 FRIT/NDS STAINLESS SPOKE CC40 C 277mm
 2 32979001 KIT 10 AERO FT/NDS CC 40 C BLACK SPOKE 277mm - while stock l
 3 V3664101 KIT 12 DRIVE SIDE STAINLESS SPOKE CC40 C 275mm
 3 32978901 KIT 10 AERO DS CC 40 C BLACK SPOKE 275mm - while stock last

HUB SHELLS

4 N/A HUB BODY
 5 33000001 REAR HUB B9+6901 BEARINGS 2013
 6 99500001 FTSL/FTSX FREEHUB BODY SEAL
 7 30871101 FTS-L ROAD FREEWHEEL BODY HG11 8/9 compatible
 8 30871201 FTS-L ROAD FREEWHEEL BODY ED11 8/9 compatible
 9 30872801 SET OF 3 INTERNAL SILVER SPACERS 9mm FTS-L
 11 V2250301 KIT REAR AXLE AERO HUB CXR/CC40/CC SLS/CC SLE/COSMIC PRO CAR
 12 M40578 FTSL PAWLS KIT (ROAD WHEELS)
 13 V2373101 KIT NUT FOR ROAD ALLOY THROUGH AXLE 9mm

MAVIC *Cosmic Carbone 40 C***DELIVERED WITH**

BR601 quick releases	
Carbon brake pads	
Multifonction adjustment wrench	
User guide	

Specifications**RIMS**

- **Material** : 3K carbon fibers with aluminum cooling system
- **Height** : 40 mm
- **Drilling** : co-molded Fore drilled inserts
- **Brake track** : carbon with TgMAX technology
- **Brake track** : carbon
- **Valve hole diameter** : 6.5 mm
- **Tyre** : clincher
- **ETRTO size** : 622x13C
- **Recommended tyre sizes** : 21 to 28 mm

SPOKES

- **Material** : steel
- **Shape** : straight pull, bladed, double butted
- **Nipples** : Fore integrated aluminum
- **Count** : front 16, rear 20
- **Lacing** : radial front and rear non-drive side, crossed 2 rear drive side

WHEEL HUB

- **Front and rear bodies** : carbon center tube and aluminum flanges
 - **Axle material** : aluminum
- Adjustable sealed cartridge bearings
- **Freewheel** : FTS-L steel

WHEEL WEIGHTS

Wheel weight 875