

# MAVIC Ksyrium Elite UST Disc

ASTM CATEGORY 2 : road and offroad with jumps less than 15cm

For a longer longevity of the wheel, Mavic recommends that the total weight supported by the wheels don't exceed 120kg, bike included

Recommended tyre sizes: 25 to 32 mm

Max. Pressure: see indication on wheel and tyre. If they differ, use the lower of the 2

## REFERENCES WHEELS

R33681 Ksyrium EI UST DCL 20 Rr

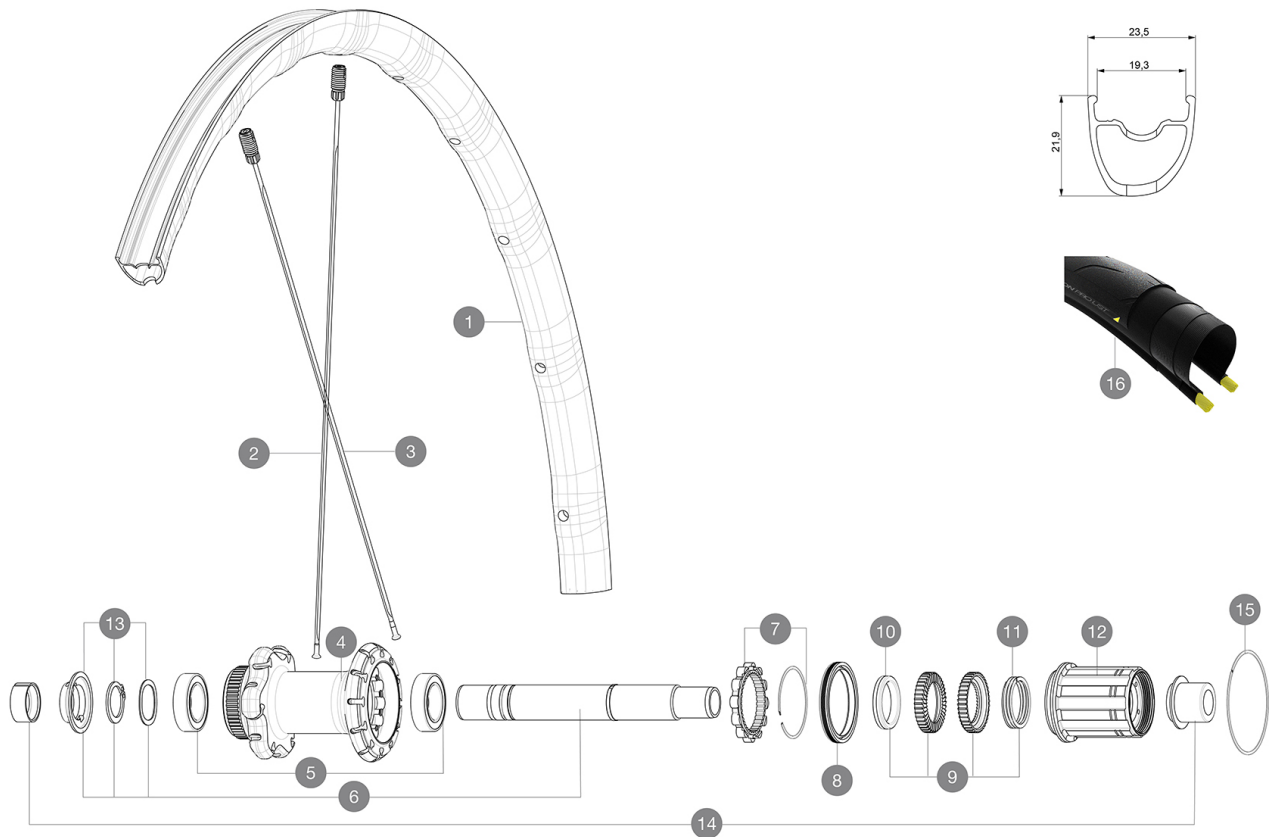

## RIMS



&NBSP;:

1 V2739813 KIT REAR RIM KSYRIUM ELITE DISC UST 20

## SPOKES

2 V2273401 KIT 12 FRT/NON DRIVE SIDE BUTTED SPOKE 297mm  
3 V2273501 KIT 12 DRIVE SIDE BUTTED SPOKE 280mm

## HUB SHELLS

4 N/A HUB BODY  
5 V2560401 KIT 2 BEARINGS 17x28x7 + WAVED WASHER + CLIP  
6 V2252901 KIT ID360 CENTER LOCK 135/142mm AXLE W/CLIP  
7 V2252701 KIT ID360 INSERT SHAPED EAR LOBE > 2017  
8 V2251601 KIT ID360 SEAL + GREASE  
9 V2251701 KIT ID360 2 RATCHETS + SPRING + GREASE  
10 V2500501 KIT ID360 3 PADS NOISE REDUCING  
11 V2251801 KIT 3 ID360 ROAD SPRINGS  
12 V3430101 HG11 Freewheel Body ID360  
13 V2560501 KIT ADJUST. SYSTEM QRM AUTO ID360 for 17x28x7 bearing  
15 V2252201 KIT 2 REAR HUB RETENTION RINGS 48mm

## TYRES

16 39938825 Yksion Pro UST 700x25

## ADAPTERS

14 V2510701 ID360V2RrAxleAdapt12x142/148  
V2510901 ID360 EVO RrAxleAdpt12x135/150  
V2510801 ID360 V2 RrAxleAdapt9x135

# MAVIC Ksyrium Elite UST Disc

## DELIVERED WITH

|  |   |
|--|---|
| Mavic tyre sealant (rear wheel)<br>(355 466 01)                  |   |
| Tyre sealant syringe   |   |
| Front QR adapters<br>(996 941 01 for MTB or B41 043 01 for road) |   |
| Rear QR adapters for Instant Drive 360<br>(B49 894 01)           |   |
| UST valve and accessories<br>(129 838 01)                        |  |
| User guide   |   |

## COMPATIBILITY

|  |  |
|--|--|
| Freewheel: Shimano/Sram, convertible to Campagnolo and XD-R with optional driver bodies  |  |
| Front axle: 12mm thru axle, easily convertible to quick release with included adapters. Convertible to 15mm with complete axle replacement |  |
| Rear axle: 12mm thru axle, convertible to Quick Release with included adapters   |  |

## Specifications

### RIMS

- **Material** : Mactal
  - **Height** : 22 mm
  - **Joint** : SUP
  - **Drilling** : Fore
- Disc brake specific profile
- **Weight reduction** : ISM 4D
  - **Valve hole diameter** : 6.5 mm
  - **Tyre** : UST Tubeless and tubetype
  - **Internal width** : 19 mm
  - **ETRTO size** : 622x19TC Road

### SPOKES

- **Material** : steel
- **Shape** : straight pull, flat
- **Nipples** : Fore integrated aluminum
- **Count** : 24 front and rear
- **Lacing** : front crossed 2, rear Isopulse

### WHEEL HUB

- **Front and rear bodies** : aluminum
  - **Axle material** : aluminum
- Auto adjust sealed cartridge bearings (QRM Auto), front and rear
- **Freewheel** : Instant Drive 360
  - **Front** : Quick release, 12x100 and 15x100 through axle compatible
  - **Rear** : Quick Release, 12x142 and 12x135 compatible

### VERSIONS

- **Color** : Black only
- **Disc standard** : Center Lock(R) only

### WHEEL WEIGHTS

900