

# MAVIC E-SPEEDCITY 1 650B

1  
2023  
FRONT

ASTM CATEGORY 2 : road and offroad with jumps less than 15cm

Tamaño máximo del neumático: anchura 52 mm - presión máx. 2,35 bares/34 psi

Recommended tire sizes: 50mm to 76mm (2.0" to 3.0")

Tamaño máximo del neumático: anchura 125 mm - presión máx. 1,25 Bar/18 PSI

For a longer longevity of the wheel, Mavic recommends that the total weight supported by the wheels doesn't exceed 180kg, E-bike included

## RUEDAS REFERENCIAS

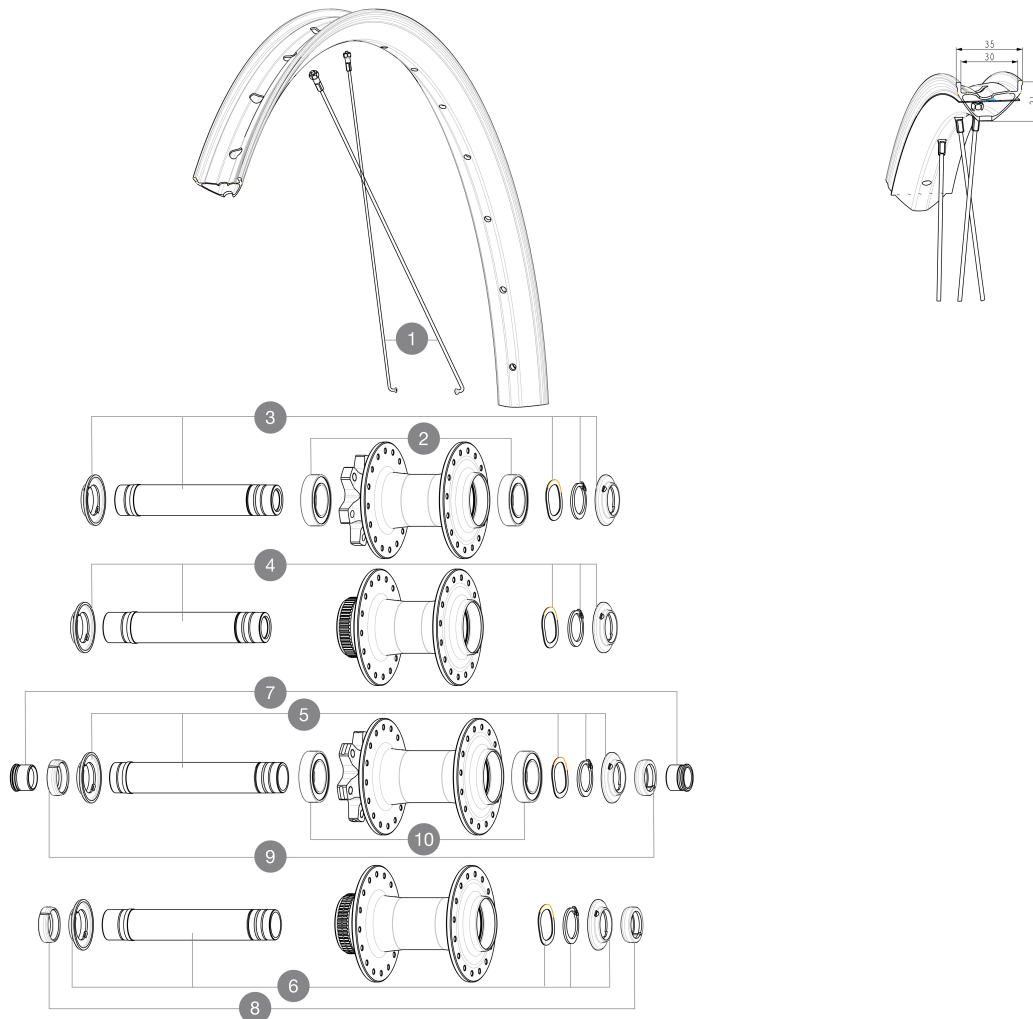

### SPOKES

1 V00062531 Kit 16ft/rr Jbent bk rd spk275 27,5"+np

### HUB SHELLS

V2500901 KIT BEARINGS 18x30x7 + WAVED WASHER + CLIP  
 3 V2375501 Kit QRM auto front axle 100x12/15mm D6T  
 4 V2374001 KIT 12x100mm FRONT AXLE DCL QRM AUTO ALLROAD > 2019  
 5 V2372401 KIT 110mm AXLE QRM AUTO MTB > 2019  
 6 V2375601 Kit 110mm axle QRM auto MTB from 2019 DCL

### ADAPTERS

7 V2680201 12mmFtRoadAxleAdaptersQRM  
 8 V2680501 12mm Road Axle Cap QRM Auto  
 9 V2372501 15mm MTB Axle Cap QRM Auto From 2019  
 99694101 2 REDUCERS 15/9mm  
 V2680301 "Kit Ft Road Adapter 12 >> 9mm"

# MAVIC E-SPEEDCITY 1 650B

2023  
FRONT

## ENTREGADO CON

User guide	
Fondo de llanta Tubeless preinstalado	
Arandela de cassette M9 no montada en la rueda trasera	
Arandela de cassette M9 no montada en la rueda trasera	
User guide	
User guide	
Fondo de llanta Tubeless preinstalado	

## COMPATIBILITY

Freewheel: Shimano/Sram, convertible to Campagnolo ED11, N3W and XD-R with optional driver bodies	
Front axle: 12mm thru axle, easily convertible to quick release with optional adapters. Convertible to 15mm with complete axle replacement	
Cuerpo rueda libre: convertible SRAM XD carretera (kit V2580101 vendido por separado)	
Cuerpo rueda libre: convertible SRAM XD carretera (kit V2580101 vendido por separado)	
Rear axle: 12mm thru axle, convertible to Quick Release with optional adapters and axle replacement	
Cuerpo rueda libre: convertible SHIMANO HG ligera carretera (kit V3850101 vendido por separado)	
Cuerpo rueda libre: convertible SHIMANO HG ligera carretera (kit V3850101 vendido por separado)	
Cuerpo rueda libre: convertible SHIMANO MS (kit V3990101 vendido por separado)	
Cuerpo rueda libre: convertible SHIMANO MS (kit V3990101 vendido por separado)	
Front axle: 12mm thru axle, easily convertible to quick release with optional adapters. Convertible to 15mm with complete axle replacement	
Front axle: 12mm thru axle, easily convertible to quick release with optional adapters. Convertible to 15mm with complete axle replacement	
Cuerpo rueda libre: convertible CAMPAGNOLO N3W (kit V4270101 vendido por separado)	
Cuerpo rueda libre: convertible CAMPAGNOLO N3W (kit V4270101 vendido por separado)	
ID360 Shimano Micro Spline alloy freewheel body (V3990101)	
NÃ°cleo de rueda libre Sram XD IDÃ° 360 (V3740101)	
Eje trasero: solo para tuercas de fijaciÃ³n (incluidas), rosca M9x1	
ID360 Shimano Micro Spline alloy freewheel body (V3990101)	
Rear axle: 12mm thru axle, convertible to Quick Release with adapters (delivered with non-boost wheel)	