

REFERENCES WHEELS

128082	DEEMAX ULTIMATE 012 PR9/12x135	129521	DEEMAX ULTIMATE 012 FRT20mm
129523	DEEMAX ULTIMATE 012 PR12x150		

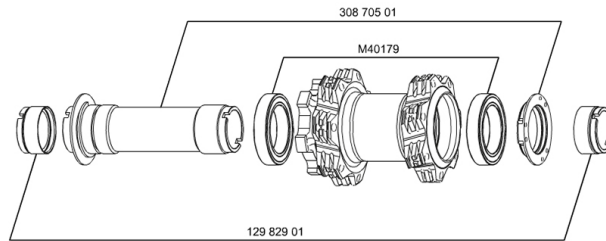

RIMS



&NBSP;:

99691910	KIT FRONT RIM DEEMAX ULTIMATE YELLOW
----------	--------------------------------------

SPOKES

30863801	KIT 14 FT M7/7 DEEMAX ULTIMATE 12 SPK 271mm
----------	---

HUB SHELLS

M40179	FRONT BEARING 25x37x7 20mm AXLE
30870501	FRONT AXLE 20mm CROSSMAX + DEEMAX ULTI 2012

ADAPTERS

12982901	ADAPTER Ft 20x110mm
----------	---------------------

MAVIC Deemax Ultimate

DELIVERED WITH

UST valve and accessories	
UST valve and accessories	
Rear QR adapters	
Rear QR adapters	
Multifonction adjustment wrench	
Multifonction adjustment wrench	
User guide	
User guide	

Specifications

RIMS

- **Material** : Mxstal
- **Material** : Mxstal
- **Color** : yellow
- **Joint** : SUP
- **Joint** : SUP
- **Drilling** : Fore
- Disc brake specific profile
- **Drilling** : Fore
- **Weight reduction** : ISM with central spine
- **Valve hole diameter** : 6.5 mm
- Disc brake specific profile
- **Weight reduction** : ISM with central spine
- **Tyre** : UST Tubeless and tubetype
- **Valve hole diameter** : 6.5 mm
- **Internal width** : 21 mm
- **Graphisms** : hot stamped
- **ETRTO size** : 559x21C
- **Tyre** : UST Tubeless and tubetype
- **Internal width** : 21 mm
- **ETRTO size** : 559x21C
- **Recommended tyre sizes** : 2.0 to 2.5
- **Recommended tyre sizes** : 2.0 to 2.5

SPOKES

- **Material** : steel
- **Material** : steel
- **Shape** : straight pull, bladed
- **Shape** : straight pull, bladed
- **Color** : black
- **Nipples** : integrated M7 aluminum with brake rings
- **Nipples** : integrated M7 aluminum with brake rings
- **Count** : front 28, rear 32
- **Lacing** : front and rear crossed 3
- **Count** : front 28, rear 32
- **Lacing** : front and rear crossed 3

WHEEL HUB

- **Front and rear bodies** : aluminum
- **Front and rear bodies** : aluminum with Spoke Retention System (SRS special machining to avoid spoke ejection)
- **Front and rear axle material** : aluminum
- **Color** : yellow
- QRM+
- **Front and rear axle material** : aluminum
- ITS-4 alloy
- QRM+
- ITS-4 alloy

WHEEL WEIGHTS

Wheel weight 910