

**MAVIC** **KSYRIUM S DISC**

ASTM CATEGORY 2 : road and offroad with jumps less than 15cm

Maximum tyre pressure: 4.4bar/64PSI with a 28mm tyre - 2.6bar/38PSI with a 64mm tyre

Maximum tyre pressure: 6.75bar/97PSI with a 23mm tyre - 3.8bar/55PSI with a 62mm tyre

For a longer longevity of the wheel, Mavic recommends that the total weight supported by the wheels doesn't exceed 120kg, bike included

Recommended tyre sizes: 25 to 32 mm

Max. Pressure: see indication on wheel and tyre. If they differ, use the lowest of the 2

Maximum tyre size: width 62mm - pressure max. 3.8Bar/55PSI

**REFERENCES WHEELS**

F90231 KSYRIUM S CL 700 12x100

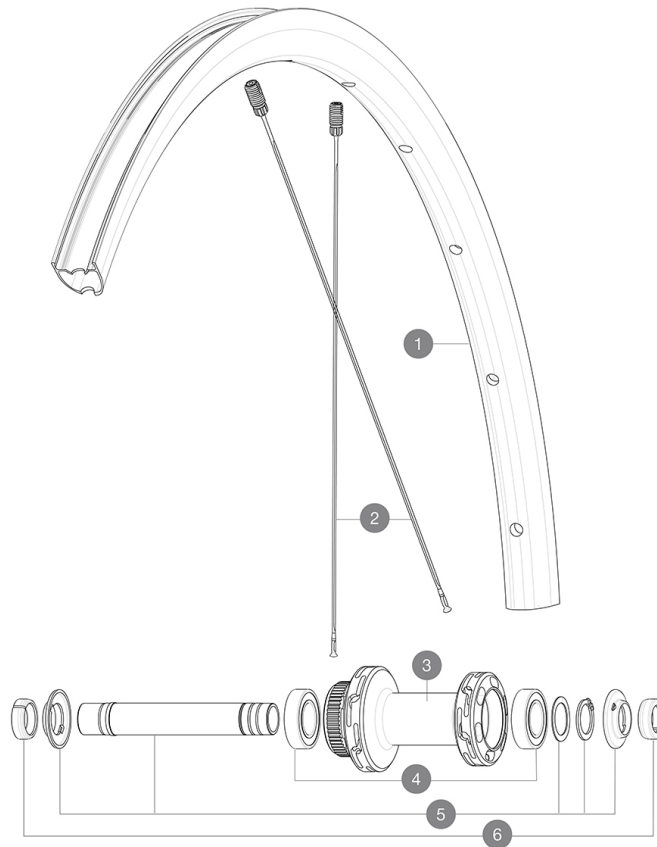
**RIMS**

&NBSP;:

1 V4093410 Kit Front rim Ksyrium S Disc

**SPOKES**

2 V4163501 Kit 12 Front/Rear Ksyrium S Disc butted spoke 294mm M7/7

**HUB SHELLS**

3 N/A HUB BODY  
4 M40129 KIT 2 BEARINGS 6902 15x28x7  
5 V2373301 KIT QRM AUTO FRONT AXLE 12mm > 2019

**ADAPTERS**

6 V2680501 12mm Road Axle Cap QRM Auto  
V2680301 "Kit Ft Road Adapter 12 >> 9mm"

**DELIVERED WITH**

|   |  |
|---|--|
| User guide  |  |
| Mavic tyre sealant (rear wheel)<br>(355 466 01)                             |  |
| Front QR adapters<br>(996 941 01 for MTB or B41 043 01 for road)            |  |
| Front QR adapters<br>(996 941 01 for MTB or B41 043 01 for road)            |  |
| Front QR adapters<br>(996 941 01 for MTB or B41 043 01 for road)            |  |
| Rear QR adapters for Instant Drive 360<br>(B49 894 01)                      |  |
| Rear QR adapters for Instant Drive 360<br>(B49 894 01)                      |  |
| Rear QR adapters for Instant Drive 360<br>(B49 894 01)                      |  |
| Rear QR adapters for Instant Drive 360<br>(B49 894 01)                      |  |
| UST valve and accessories<br>(129 838 01)                                   |  |
| UST valve and accessories<br>(129 838 01)                                   |  |
| UST valve and accessories<br>(129 838 01)                                   |  |
| Multifonction adjustment wrench (delivered with rear wheel)<br>(325 423 01) |  |
| User guide  |  |
| User guide  |  |
| User guide  |  |
| UST valve and accessories<br>(129 838 01)                                   |  |
| Front QR adapters<br>(996 941 01 for MTB or B41 043 01 for road)            |  |
| Rear QR adapters for Instant Drive 360<br>(B49 894 01)                      |  |

**COMPATIBILITY**

|   |  |
|---|--|
| Freewheel: Shimano/Sram, convertible to Campagnolo and XD-R with optional driver bodies   |  |
| Freewheel: Shimano/Sram, convertible to Campagnolo and XD-R with optional driver bodies   |  |
| Front axle: 12x100 thru axle, easily convertible to quick release with included adapters. Not compatible with 15mm through axles. |  |
| Front axle: 12x100 thru axle, easily convertible to quick release with included adapters. Not compatible with 15mm through axles. |  |
| Freewheel body: convertible SRAM XD road (kit V2580101 sold separately)   |  |
| Rear axle: 12mm thru axle, convertible to Quick Release with included adapters  |  |
| Rear axle: 12mm thru axle, convertible to Quick Release with included adapters  |  |
| Freewheel body: convertible SRAM XD road (kit V2580101 sold separately)   |  |
| Freewheel body: convertible SHIMANO HG light road (kit V3850101 sold separately)  |  |
| Freewheel body: convertible SHIMANO HG light road (kit V3850101 sold separately)  |  |
| Freewheel body: convertible SHIMANO MS (kit V3990101 sold separately)   |  |
| Freewheel body: convertible SHIMANO MS (kit V3990101 sold separately)   |  |
| Freewheel body: convertible CAMPAGNOLO ED (kit V3440101 sold separately)  |  |
| Freewheel body: convertible CAMPAGNOLO ED (kit V3440101 sold separately)  |  |
| Front axle: 12x100 thru axle, easily convertible to quick release with included adapters. Not compatible with 15mm through axles. |  |
| Front axle: 12x100 thru axle, easily convertible to quick release with included adapters. Not compatible with 15mm through axles. |  |
| ID360 Shimano Micro Spline alloy freewheel body (V3990101)  |  |
| ID360 Sram XD freewheel body (V3740101)   |  |