

# MAVIC Crossmax Light

ASTM CATEGORY 3 : CROSS COUNTRY AND TRAIL RIDING

For a longer longevity of the wheel, Mavic recommends that the total weight supported by the wheels don't exceed 120kg, bike included

Recommended tyre sizes: 36 mm to 64 mm (1.4" to 2.5")

## REFERENCES WHEELS

|        |                     |        |                    |
|--------|---------------------|--------|--------------------|
| R22151 | XmxLght27,5BstRr    | R22441 | XmxLght27,5RrBstXD |
| R22431 | Xmx Lght 27,5 Rr XD | R22141 | Xmx Lght 27,5 Rr   |

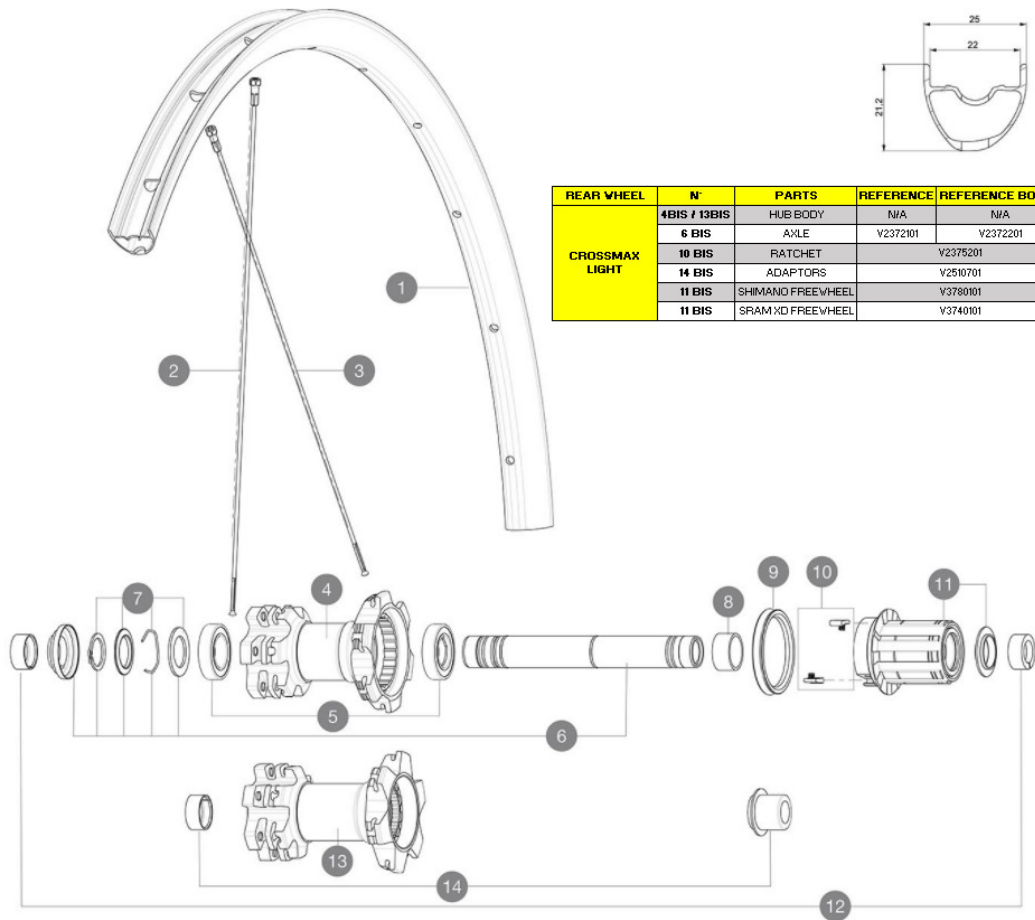

## RIMS



&NBSP;:

|   |          |   |
|---|----------|---|
| 1 | V2318015 | KIT FRONT/REAR RIM CROSSMAX LIGHT 27,5" 22TSS |
|   | V2620101 | UST RIM TAPE 25mm (for 21-24mm wide rim)      |

## SPOKES

|   |          |  |
|---|----------|--|
| 2 | V2385301 | KIT 12 FT/NDS CROSSMAX LIGHT 27,5" SPK 278mm |
| 3 | V2385101 | KIT 12 DS CROSSMAX LIGHT 27,5" SPK 275mm     |

## HUB SHELLS

|    |          |  |
|----|----------|--|
| 4  | N/A      | HUB BODY   |
|    | N/A      | HUB BODY   |
| 6  | V2371201 | KIT REAR QRM AXLE 135-142 / BOOST 148mm                      |
|    | V2372101 | KIT ID360 135/142 D6T AXLE WITH CLIP                         |
|    | V2372201 | KIT ID360 148 D6T AXLE WITH CLIP                             |
| 7  | V2370401 | KIT REAR AUTO ADJUSTING PLAY 12mm AXLE                       |
| 8  | 35124501 | SET OF 3 REAR AXLE/FREEWHEEL BODY SPACERS MTB L1             |
| 9  | 99610701 | ITS-4 FREEWHEEL SEAL   |
| 10 | 99610601 | PAWLS KIT FOR ITS-4 (OR TS-2)                                |
|    | V2375201 | KIT ID360 24 TEETH 2 RATCHET + MTB SPRING + PAD (specific)   |
| 11 | 35126301 | TS-2 FREEWHEEL BODY + SEAL 2013 (NO PAWLS) - while stock las |
|    | V3780101 | HG9 Alloy MTB Freewheel Body ID360                           |
|    | V3740101 | XD MTB Freewheel Body ID360                                  |
| 13 | N/A      | HUB BODY   |
|    | N/A      | HUB BODY   |

## ADAPTERS

|    |          |  |
|----|----------|--|
| 12 | 32965001 | ADAPTER Rr 12x142mm Elite/CRide MTB (Rd) |
| 14 | V2510701 | ID360V2RrAxleAdapt12x142/148             |

# MAVIC Crossmax Light

2018  
REAR

## DELIVERED WITH

|   |  |
|---|--|
| UST valve and accessories<br>(129 838 01) |  |
| Tubeless rim tape                         |  |
| User guide                                |  |

## COMPATIBILITY

|   |  |
|---|--|
| Freewheel: Shimano/Sram or XD   |  |
| Front axle: convertible from 15mm thru axle to Quick Release with optional adapters |  |
| Rear axle: 12mm thru axle, convertible to Quick Release with optional adapters      |  |

## Specifications

### RIMS

- **Material** : S6000 Aluminum
- **Joint** : SUP
- **Drilling** : traditional
- **Valve hole diameter** : 6.5 mm
- **Tyre** : UST Tubeless and tubetype
- **Internal width** : 22 mm
- **ETRTO size 27.5"** : 584x22TSS
- **ETRTO size 29"** : 622x22TSS

Hookless profile

Use with Mavic Tubeless Tape

### SPOKES

- **Material** : steel
- **Shape** : straight pull, round, double butted
- **Count** : 24 front and rear
- **Lacing** : front and rear crossed 2

### WHEEL HUB

- **Front and rear bodies** : aluminum
- **Axle material** : aluminum
- **Front bearings** : auto adjust sealed cartridge bearings (QRM Auto), Rear bearings sealed cartridge bearings (QRM)
- **Freewheel** : TS-2 alloy

### VERSIONS

- **Color** : Black only
- **Disc standard** : 6 Bolts only
- **Hub width** : Boost (front 110, rear 148) or Non-Boost (front 100, rear 135/142)

### WHEEL WEIGHTS

Weight Rear 27.5": 895  
Weight Rear 29": 935