

MAVIC **KSYRIUM S 25 DISC MAHLE**

ASTM CATEGORY 2 : road and offroad with jumps less than 15cm

Maximum tyre pressure: 4.4bar/64PSI with a 28mm tyre - 2.6bar/38PSI with a 64mm tyre

For a longer longevity of the wheel, Mavic recommends that the total weight supported by the wheels doesn't exceed 120kg, bike included

Maximum tyre size: width 62mm - pressure max. 3.8Bar/55PSI

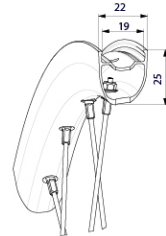
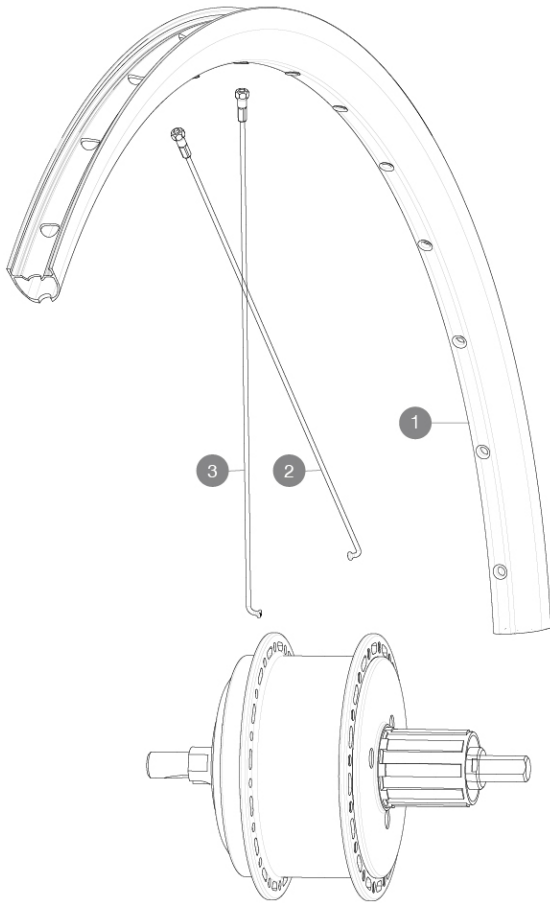
REFERENCES WHEELS**RIMS**

&NBSP;:

1	V4094213	Kit Rear rim Ksyrium S Disc EBM
	V2620101	UST RIM TAPE 25mm (for 21-24mm wide rim)

SPOKES

2	V4164601	Kit 16 Rear Drive Side round Jbent spoke 249 Ksyrium S Disc
3	V4164501	Kit 16 Rear Non Drive Side round Jbent spoke 251 Ksyrium S D

MAVIC **KSYRIUM S 25 DISC MAHLE****DELIVERED WITH**

Mavic tyre sealant (rear wheel) (355 466 01)	
User guide	
Front QR adapters	
UST valve and accessories (129 838 01)	
Pre-installed tubeless rim tape	
Multifunction adjustment wrench (delivered with rear wheel) (325 423 01)	
User guide	
Pre-installed tubeless rim tape	
UST valve and accessories (129 838 01)	
Front QR adapters	
Multifunction adjustment wrench (delivered with rear wheel) (325 423 01)	

COMPATIBILITY

Instant Drive 360 freewheel technology The new Instant Drive 360 freewheel system is super light and fast to engage with only 9Å°. A large contactless rubber seal provides low friction, while a wide array of end caps makes it super versatile.	
FTS-L Shimano / Sram freewheel body ([30871101] - Delivered on the wheel)	

Specifications**RIMS**

- **Material** : Mxstal
- **Material** : Mxstal
- **Height** : 22 mm
- **Height** : 22 mm
- **Joint** : SUP welding technology
- **Joint** : SUP welding technology
- **Drilling** : traditional (front 24 holes and rear 32 holes)
- **Drilling** : traditional (front 24 holes and rear 32 holes)

Disc brake specific profile

Disc brake specific profile

- **ETRTO size** : 622x19TC
- **ETRTO size** : 622x19TC
- **Tire** : clincher
- **Tire** : clincher

SPOKES

- **Material** : steel
- **Material** : steel
- **Shape** : straight pull, round
- **Shape** : straight pull, round
- **Count** : 28 front and rear
- **Count** : 28 front and rear

Instant Drive 360 freewheel technology

WHEEL HUB

- **Body** : aluminum
 - **Body** : aluminum
 - **Disc standard** : 6 Bolts only
 - **Disc standard** : 6 Bolts only
 - **Axle material** : aluminum
 - **Axle material** : aluminum
- Hub available with 6-bolt brake rotors
Hub available with 6-bolt brake rotors

WHEEL WEIGHTS