

ASTM CATEGORY 5 : GRAVITY RIDING FOCUSED ON THE DESCENT

For a longer longevity of the wheel, Mavic recommends that the total weight supported by the wheels doesn't exceed 150kg, bike included

Minimum tyre size: width 52mm - pressure max. 2.95Bar/43PSI

Non-Boost : 12 to 9mm rear adapter for quick release (V2510801)

## REFERENCES WHEELS

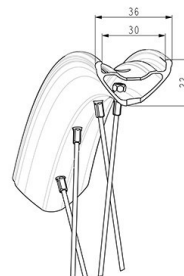
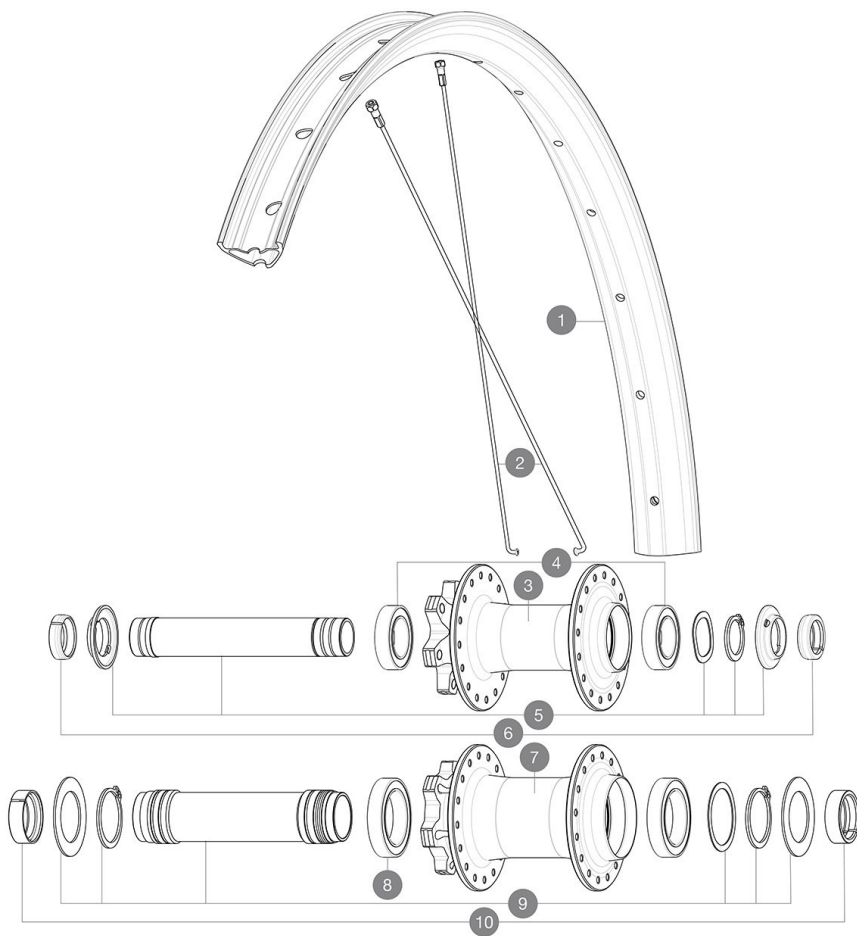

| Specifications  | Maxi target   |
|-----------------|---------------|
| Frontal run out | 0,5mm         |
| Lateral run out | 0,5mm         |
| Centring        | 1,0mm (2x0,5) |
| Tension daN     | 99 > 121      |
| Disc side       |               |

## RIMS



&NBSP;:

|   |           |  |
|---|-----------|--|
| 1 | V00096631 | Kit Front/Rear rim Deemax Park 27,5"   |
|   | V3750101  | 35mm UST Green Tape for 30mm wide rims |

## SPOKES

|   |           |   |
|---|-----------|---|
| 2 | V00062531 | Kit 16ft/rr Jbent bk rd spk275 27,5"+np |
|---|-----------|---|

## HUB SHELLS

|   |          |   |
|---|----------|---|
| 4 | V2500901 | KIT BEARINGS 18x30x7 + WAVED WASHER + CLIP  |
| 5 | V2372401 | KIT 110mm AXLE QRM AUTO MTB > 2019          |
| 8 | M40179   | FRONT BEARING 25x37x7 20mm AXLE             |
| 9 | V2373701 | KIT 20x110mm BOOST AXLE QRM AUTO MTB > 2019 |

## ADAPTERS

|    |          |                                       |
|----|----------|---------------------------------------|
| 6  | V2372501 | 15mm MTB Axle Cap QRM Auto From 2019  |
| 10 | V2680401 | 20x110 BOOST Front Adapter MTB wheels |

# MAVIC DEEMAX PARK 27.5

## DELIVERED WITH

|  |  |
|--|--|
| User guide   |  |
| UST valve and accessories<br>(129 838 01)              |  |
| Pre-installed tubeless rim tape                        |  |
| User guide   |  |
| Pre-installed tubeless rim tape                        |  |
| UST valve and accessories<br>(129 838 01)              |  |
| 2 replacement spokes with each wheel                   |  |
| 12 to 9mm rear adapter for quick release<br>(V2510801) |  |
| 2 replacement spokes with each wheel                   |  |

## COMPATIBILITY

|  |  |
|--|--|
| Freewheel body: convertible SHIMANO MS (kit V3990101 sold separately)  |  |
| Freewheel body: convertible SHIMANO MS (kit V3990101 sold separately)  |  |
| Freewheel body: convertible SHIMANO HG MTB steel (kit V3790101 sold separately)  |  |
| Freewheel body: convertible SHIMANO HG MTB steel (kit V3790101 sold separately)  |  |
| ID360 Shimano / Sram freewheel body (V3430101) - Delivered on the wheel  |  |
| Rear axle adapters: 12x148 convertible to 9x141 (kit V2510801 sold separately)   |  |
| Rear axle adapters: 12x148 convertible to 9x141 (kit V2510801 sold separately)   |  |
| QRM Auto bearing preload technology<br>Qualité de Roulements Mavic Auto<br>Our latest innovation. Those cartridge bearings are of course double sealed with C3 internal clearance. Their preload is automatically adjusted to guarantee a perfect spin with no play on the long run. |  |
| Rear axle: 12mm thru axle, convertible to Quick Release with adapters (delivered with non-boost wheel)   |  |
| ID360 Shimano / Sram freewheel body (V3430101) - Delivered on the wheel  |  |
| QRM Auto bearing preload technology<br>Qualité de Roulements Mavic Auto<br>Our latest innovation. Those cartridge bearings are of course double sealed with C3 internal clearance. Their preload is automatically adjusted to guarantee a perfect spin with no play on the long run. |  |

## Specifications

### RIMS

- **Material** : Mactal
- **Material** : Mactal
- **Height** : 22 mm
- **Height** : 22 mm
- **Joint** : SUP welding technology
- **Joint** : SUP welding technology
- **Internal width** : 30 mm
- **Internal width** : 30 mm
- **Drilling** : traditional (front/rear 32 holes)
- **Drilling** : traditional (front/rear 32 holes)

Disc brake specific profile

Disc brake specific profile

Asymmetrical rim design

Asymmetrical rim design

- **ETRTO size 27.5"** : 584x30TC
- **ETRTO size 27.5"** : 584x30TC
- **Tire** : clincher
- **Tire** : clincher

### SPOKES

- **Material** : steel
- **Material** : steel

### WHEEL HUB

- **Body** : aluminum
- **Body** : aluminum
- **Body design** : CLASSIC
- **Body design** : CLASSIC
- **Disc standard** : 6 Bolts only
- **Disc standard** : 6 Bolts only
- **Axle material** : aluminum
- **Axle material** : aluminum
- Infinity hubs
- Infinity hubs
- **Axles** : Front 15X110 (Boost) or 15x100 ; Rear 12X148 (Boost) or 12x142
- **Axles** : Front 15X110 (Boost) or 15x100 ; Rear 12X148 (Boost) or 12x142
- **Axles** : Front 15X110 Boost ; Rear 12X148 Boost
- **Axles** : Front 15X110 Boost ; Rear 12X148 Boost
- **Freewheel** : FTS-L steel
- **Freewheel** : FTS-L steel

### WHEEL WEIGHTS

1140